



MEMORANDUM

TO: Todd Shaw, Chair
 Planning Commission Members

FROM: Kate Clark
 Housing and Planning Department

DATE: October 21, 2020

RE: C14-2020-0086 – 6111 FM Rd 969/MLK & 183 Residential
 Case withdrawn by Applicant

This case was withdrawn by the Applicant’s agent on October 21, 2020. October 27, 2020 would have been the first time this case appeared on a Planning Commission agenda.

Attachments: Email from Applicant’s agent, Map of Property

Clark, Kate

From: Ferris Clements <FClements@abaustin.com>
Sent: Wednesday, October 21, 2020 12:49 PM
To: Clark, Kate
Cc: Richard Suttle, Jr.
Subject: RE: 20-0086 Staff Report

Importance: High

*** External Email - Exercise Caution ***

Kate,

Good afternoon. My client has elected to not pursue this case any further at this time – please remove this case from the upcoming Planning Commission and City Council meetings. Please let me know if you have any questions.

Thanks,
Ferris

From: Clark, Kate <Kate.Clark@austintexas.gov>
Sent: Tuesday, October 20, 2020 4:08 PM
To: Ferris Clements <FClements@abaustin.com>
Subject: 20-0086 Staff Report

Ferris,

Attached is the staff backup for this case. Please remember to register as a speaker for this case. Registration will open on Friday once the agenda is posted and will close on Monday, October 26th at noon. Please let me know if you have any questions.

Kate Clark, AICP, LEED AP

Senior Planner

City of Austin | Housing and Planning Department

Mailing Address: [P.O.Box 1088](#), Austin, Texas 78767

Physical Address: [505 Barton Springs Rd, 5th floor, Austin, Texas 78704](#)

Tel: 512-974-1237

Email: kate.clark@austintexas.gov

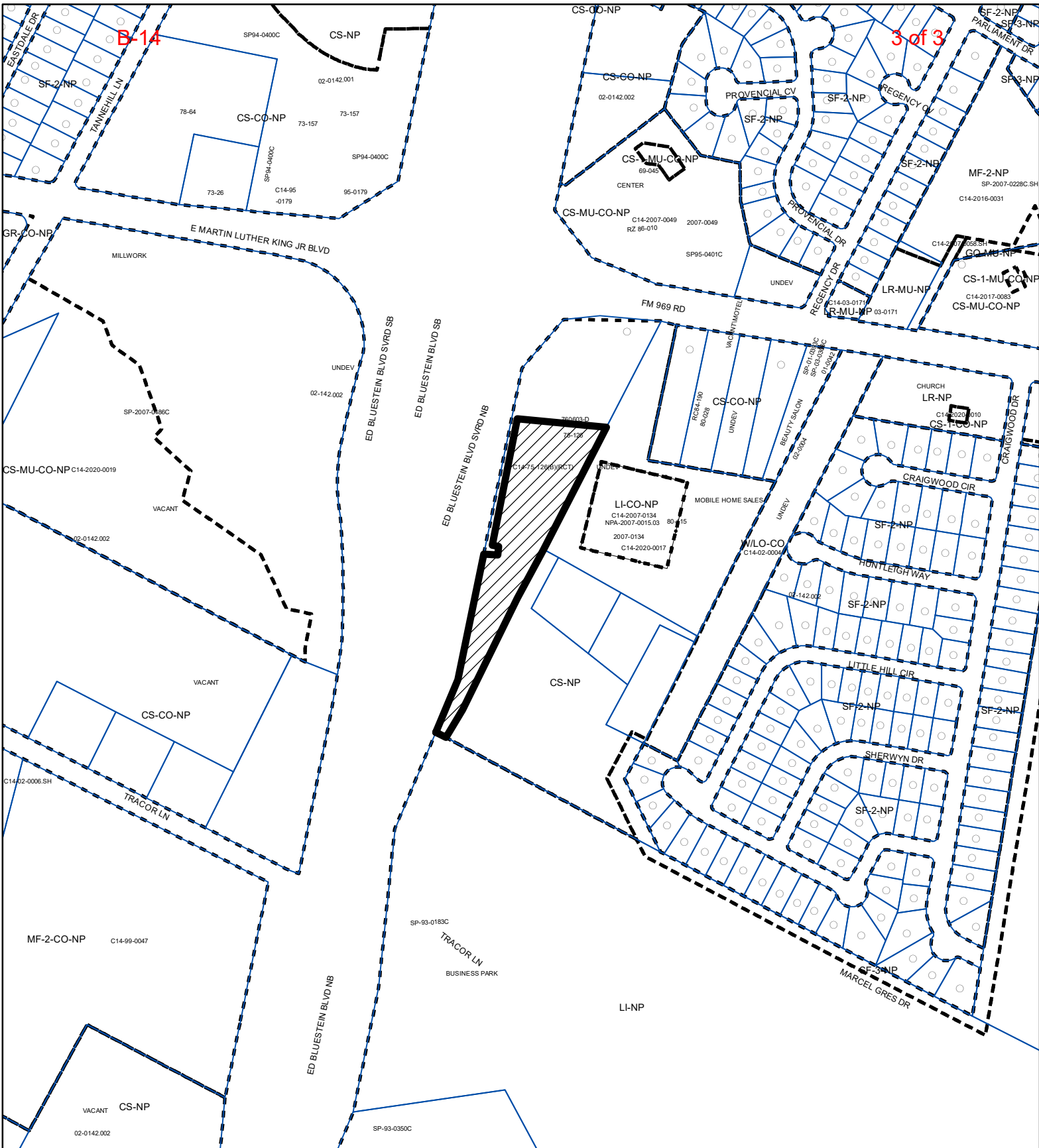

CAUTION: This email was received at the City of Austin, from an EXTERNAL source. Please use caution when clicking links or opening attachments. If you believe this to be a malicious and/or phishing email, please forward this email to cybersecurity@austintexas.gov.



ZONING

ZONING CASE#: C14-2020-0086



-  SUBJECT TRACT
-  PENDING CASE
-  ZONING BOUNDARY

1" = 400'

This product is for informational purposes and may not have been prepared for or be suitable for legal, engineering, or surveying purposes. It does not represent an on-the-ground survey and represents only the approximate relative location of property boundaries.

This product has been produced by CTM for the sole purpose of geographic reference. No warranty is made by the City of Austin regarding specific accuracy or completeness.



Created: 8/11/2020