

Waller Creek District

**ADDENDUM THREE
(ADDITIONAL AUTHORITY AND MODIFIED BIDDING
PHASE PROCESS) -
CREEK DELTA CONSTRUCTION DOCUMENTS,
PERMITTING & BIDDING PHASE PLAN**

Proposing Party: Waterloo Greenway Conservancy

**waterloo
greenway**



18 December 2020

COA CIP Project No. 12861.002

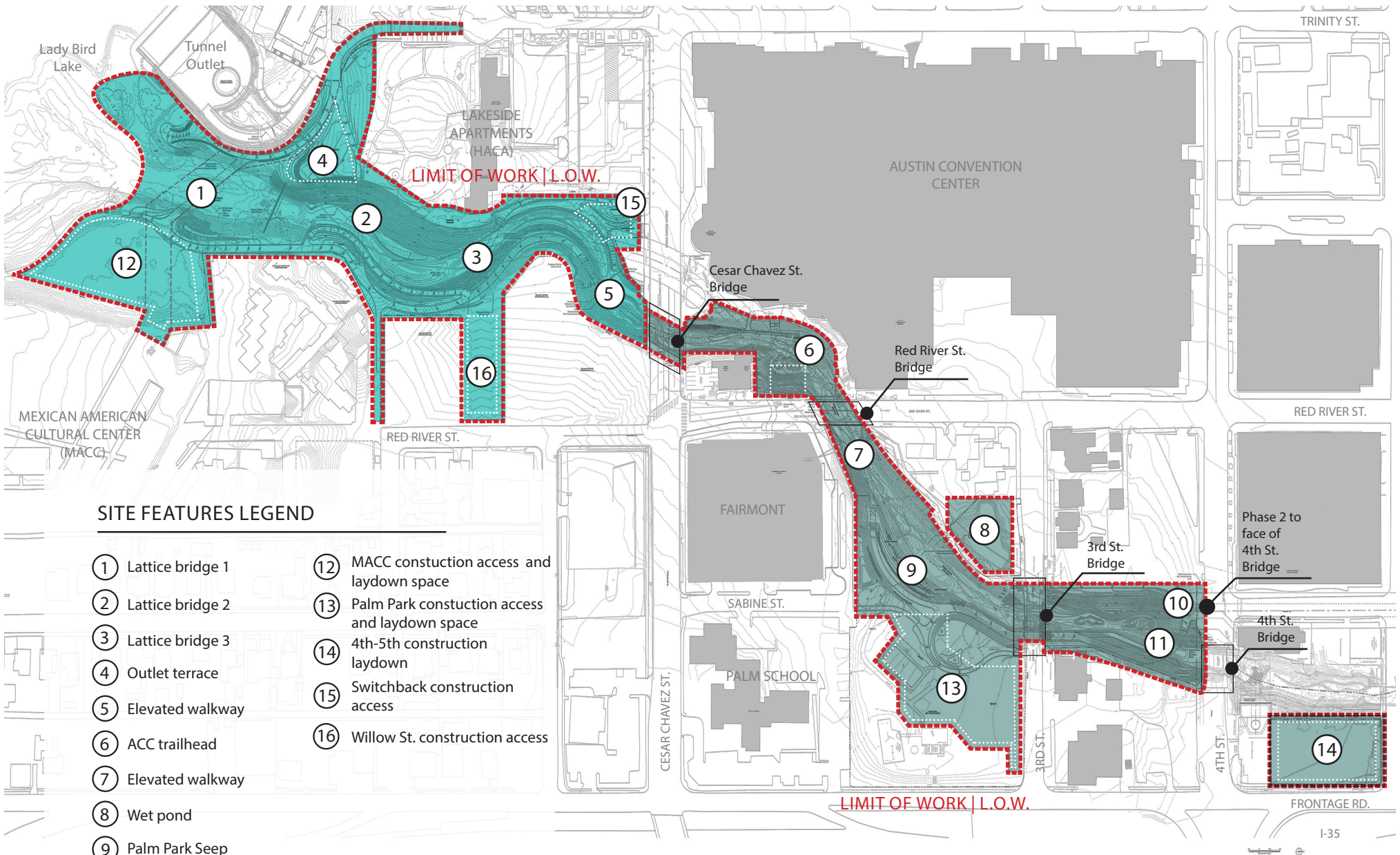

SITE FEATURES LEGEND

- | | |
|------------------------|--------------------------------------------------|
| ① Lattice bridge 1 | ⑫ MACC constuction access and laydown space |
| ② Lattice bridge 2 | ⑬ Palm Park constuction access and laydown space |
| ③ Lattice bridge 3 | ⑭ 4th-5th construction laydown |
| ④ Outlet terrace | ⑮ Switchback construction access |
| ⑤ Elevated walkway | ⑯ Willow St. construction access |
| ⑥ ACC trailhead | |
| ⑦ Elevated walkway | |
| ⑧ Wet pond | |
| ⑨ Palm Park Seep | |
| ⑩ 4th st. trailhead | |
| ⑪ Cypress grove bridge | |

 Phase 1 - Lady Bird Lake to Cesar Chavez St. Bridge	 Phase 2 - Cesar Chavez to 4th St. Bridge
 Phase 1 - construction access and staging	 Phase 2 - construction access and staging

① Original Phase Plan completion time

② Addendum Two completion time

③ LGC Addendum No. 3 Approval

④ 90% CD Submittal

⑤ 100% CD Submittal

⑥ Bid Project - Competitive Sealed Proposal

⑦ Construction Contract Negotiation

⑧ December LGC meeting / Construction Start* - not in scope

*Construction not in the scope of this Addendum, but may be addressed as a separate Phase Plan document.

2019

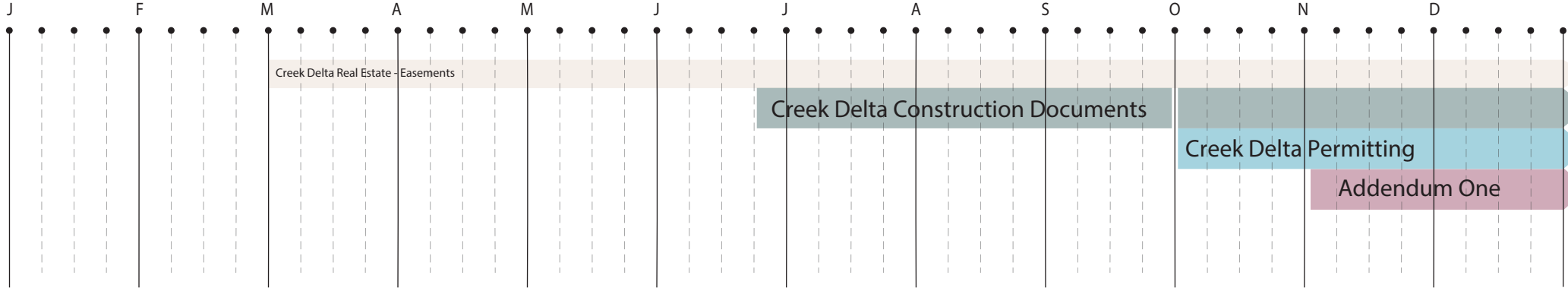

2020

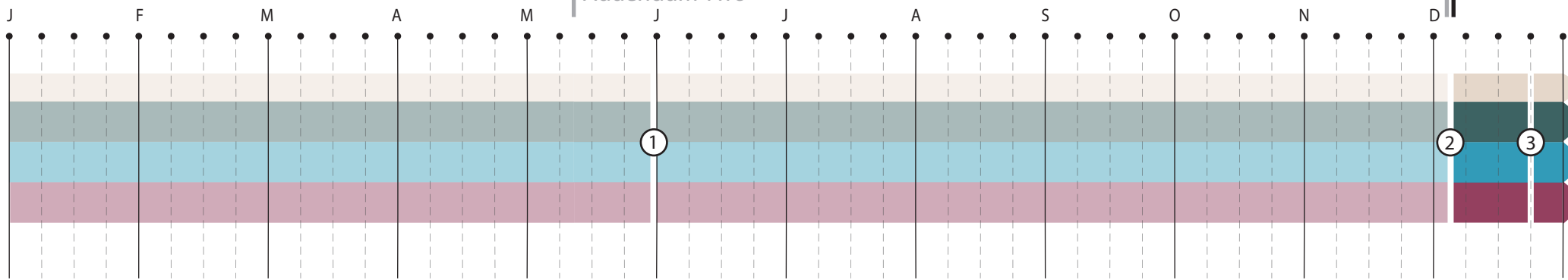

2021 Addendum Three

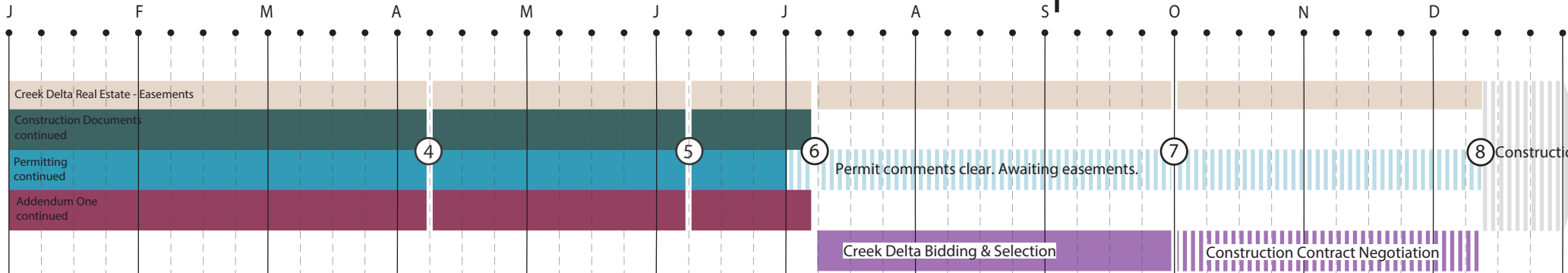

ADDENDA TWO AND THREE TO THE CREEK DELTA CONSTRUCTION DOCUMENTS, PERMITTING & BIDDING PHASE PLAN

<i>As of 11/30/20, see Pay Request #16</i>	Addendum Two Budget	Addendum Three Proposed Additional Funding	Addendum Three Total Budget
1. Construction Documents, Permitting & Bidding:			
Professional Service Fees (MVVA Team) -	\$ 3,048,085	\$ 330,000	\$ 3,378,085
Signage Consulting Fees (BMD)	\$ 96,400	--	\$ 96,400
Preconstruction Services Fees (SpawGlass)	\$ 20,000	--	\$ 20,000
Cost Consulting Fees (VCC)	\$ 76,800	--	\$ 76,800
McGray & McGray Surveying	\$ 44,438	--	\$ 44,438
Total CDs, Permitting & Bidding:	\$ 3,285,723	\$ 330,000	\$ 3,615,723
2. Allowances + Cost Overrun			
Permit Fee Allowance	\$ 180,000	--	\$ 180,000
Utility Provider Design Allowance	\$ 20,000	--	\$ 20,000
Survey Allowance	\$ 30,000	--	\$ 30,000
Tree Care Allowance	\$ 25,000	--	\$ 25,000
Geotechnical Boring Allowance	\$ 21,000	--	\$ 21,000
Soils Testing Allowance	\$ 4,000	--	\$ 4,000
Emerging Development Allowance	\$ 60,000	--	\$ 60,000
Stormwater Infrastructure Allowance	\$ 48,500	\$ 20,000	\$ 68,500
O+M and MACC Paths Allowance	\$ -	\$ 20,000	\$ 20,000
Allowances Total:	\$ 388,500	\$ 40,000	\$ 428,500
Cost Overrun Reserve (5.8%):	\$ 63,912	\$ 50,000	\$ 113,912
SUMMARY			
1. Construction Documents, Permitting & Bidding	\$ 3,285,723	\$ 330,000	\$ 3,615,723
2. Allowances + Cost Overrun	\$ 452,412	\$ 90,000	\$ 542,412
TOTAL:	\$ 3,738,135	\$ 420,000	\$ 4,158,135

Funding Splits	Addendum Two to the Creek Delta Construction Documents, Permitting & Bidding Phase Plan	Proposed Addendum Three	Revised Total	Amounts invoiced to date (through 11/30/20, Pay Request #16)			
				Construction Documents, Permitting & Bidding	Allowances & Cost Overrun Reserve	Total invoiced to date	Amount Remaining
PARD	\$ 560,720	## #####	\$ 560,720	\$ 383,203	\$ 7,327	\$ 390,530	\$ 170,191
WPD	\$ 2,903,606	\$ 420,000	\$ 3,323,606	\$ 1,900,917	\$ 75,908	\$ 1,976,825	\$ 1,346,781
WGC	\$ 273,808	\$ -	\$ 273,808	\$ 270,565	\$ 3,243	\$ 273,808	\$ -
TOTAL	\$ 3,738,135	\$ 420,000	\$ 4,158,135	\$ 2,554,685	\$ 86,479	\$ 2,641,163	\$ 1,516,972

ADDENDUM ONE (AUSTIN ENERGY DUCT BANK) TO THE CREEK DELTA CONSTRUCTION DOCUMENTS, PERMITTING & BIDDING PHASE PLAN*

1. Brazos Street Duct Bank / Austin Energy Utility Route:	Fees		
Professional Service Fees (MVVA Team)	\$90,305		
Survey Services (McGray & McGray)	\$20,474		
Preconstruction Services (SpawGlass)	\$27,023		
Geotechnical Borings (Terracon)	\$9,800		
2. Cost Overrun			
Cost Overrun Reserve (5%)	\$7,380		
SUMMARY			
1. Brazos Street Duct Bank / Austin Energy Utility Route	\$147,602		
2. Cost Overrun	\$7,380		
TOTAL:	\$154,982		
Funding Splits	Addendum One CDAE Budget	Total invoiced to date (through 10/19/20,	Amount Remaining
Austin Energy	\$154,982	\$64,676	\$90,306
TOTAL	\$154,982	\$64,676	\$90,306

*Addendum One includes the Austin Energy Brazos St. duct bank work that is fully funded by Austin Energy. Addendum One is part of the overall phase plan, but the budget is tracked separately for invoicing purposes.

CREEK DELTA CONSTRUCTION DOCUMENTS, PERMITTING & BIDDING PHASE PLAN TOTAL

Addendum One (Austin Energy Duct Bank) Budget	\$ 154,982
Addendum Three - Creek Delta Improvements Budget	\$ 4,158,135
PHASE PLAN TOTAL	\$ 4,313,117

<i>As of 11/30/20, see Pay Request #16</i>	Addendum Two Budget	Addendum Three Proposed Additional Funding	Addendum Three Total Budget
1. Construction Documents, Permitting & Bidding:			
Professional Service Fees (MVVA Team) -	\$ 3,048,085	\$ 330,000	\$ 3,378,085
Signage Consulting Fees (BMD)	\$ 96,400	--	\$ 96,400
Preconstruction Services Fees (SpawGlass)	\$ 20,000	--	\$ 20,000
Cost Consulting Fees (VCC)	\$ 76,800	--	\$ 76,800
McGray & McGray Surveying	\$ 44,438	--	\$ 44,438
Total CDs, Permitting & Bidding:	\$ 3,285,723	\$ 330,000	\$ 3,615,723
2. Allowances + Cost Overrun			
Permit Fee Allowance	\$ 180,000	--	\$ 180,000
Utility Provider Design Allowance	\$ 20,000	--	\$ 20,000
Survey Allowance	\$ 30,000	--	\$ 30,000
Tree Care Allowance	\$ 25,000	--	\$ 25,000
Geotechnical Boring Allowance	\$ 21,000	--	\$ 21,000
Soils Testing Allowance	\$ 4,000	--	\$ 4,000
Emerging Development Allowance	\$ 60,000	--	\$ 60,000
Stormwater Infrastructure Allowance	\$ 48,500	\$ 20,000	\$ 68,500
O+M and MACC Paths Allowance	\$ -	\$ 20,000	\$ 20,000
Allowances Total:	\$ 388,500	\$ 40,000	\$ 428,500
Cost Overrun Reserve (5.8%):	\$ 63,912	\$ 50,000	\$ 113,912

SUMMARY			
1. Construction Documents, Permitting & Bidding	\$ 3,285,723	\$ 330,000	\$ 3,615,723
2. Allowances + Cost Overrun	\$ 452,412	\$ 90,000	\$ 542,412
TOTAL:	\$ 3,738,135	\$ 420,000	\$ 4,158,135

Funding Splits	Addendum Two	Proposed Addendum Three	Revised Total	Amounts invoiced to date (through 11/30/20, Pay Request #16)			
				Construction Documents, Permitting & Bidding	Allowances & Cost Overrun Reserve	Total invoiced to date	Amount Remaining
PARD	\$ 560,720	\$ -	\$ 560,720	\$ 383,203	\$ 7,327	\$ 390,530	\$ 170,191
WPD	\$ 2,903,606	\$ 420,000	\$ 3,323,606	\$ 1,900,917	\$ 75,908	\$ 1,976,825	\$ 1,346,781
WGC	\$ 273,808	\$ -	\$ 273,808	\$ 270,565	\$ 3,243	\$ 273,808	\$ -
TOTAL	\$ 3,738,135	\$ 420,000	\$ 4,158,135	\$ 2,554,685	\$ 86,479	\$ 2,641,163	\$ 1,516,972

ADDENDUM THREE TO THE CREEK DELTA CONSTRUCTION DOCUMENTS, PERMITTING & BIDDING PHASE PLAN

Total Fees**		
\$3,615,723		
Month	Activity	Fees
1-18	Construction Documents & Permitting	\$2,641,163
19	Construction Documents & Permitting	\$25,000
20	Construction Documents & Permitting	\$100,000
21	Construction Documents & Permitting	\$150,000
22	Construction Documents & Permitting	\$200,000
23	Construction Documents & Permitting	\$150,000
24	Construction Documents & Permitting	\$80,000
25	Construction Documents & Permitting	\$111,366
26	Bidding and Selection	\$58,194
27	Bidding and Selection	\$30,000
28	Bidding and Selection	\$45,000
29	Bidding - Construction Contract Negotiation	\$5,000
30	Bidding - Construction Contract Negotiation	\$5,000
31	Bidding - Construction Contract Negotiation	\$15,000
TOTAL		\$3,615,723

ADDENDUM ONE (AUSTIN ENERGY DUCT BANK) TO THE CREEK DELTA CONSTRUCTION DOCUMENTS, PERMITTING & BIDDING PHASE PLAN*

Total Fees**		
\$147,602		
Month	Activity	Fees
1-7	Original Phase Plan	\$0
8-18	Feasibility & Design / Permitting	\$64,676
19	Hold - Awaiting Creek Delta Design Coordination	\$0
20	Construction Documents & Permitting	\$12,000
21	Construction Documents & Permitting	\$15,000
22	Construction Documents & Permitting	\$12,332
23	Construction Documents & Permitting	\$8,000
24	Construction Documents & Permitting	\$8,000
25	Construction Documents & Permitting	\$13,296
26	Bidding and Selection	\$5,000
27	Bidding and Selection	\$4,298
28	Bidding and Selection	\$2,000
29	Bidding - Construction Contract Negotiation	\$500
30	Bidding - Construction Contract Negotiation	\$500
31	Bidding - Construction Contract Negotiation	\$2,000
TOTAL		\$147,602

*Addendum One (Austin Energy Duct Bank) includes the electric improvements fully funded by Austin Energy. Addendum One is part of the overall phase plan budget, but has been separated for invoicing and tracking purposes.

**Excludes Allowances, Cost Overrun Reserve, and Addendum One Brazos Duct Bank/AE Utility Reroute. Projections will fluctuate in response to adjustments in work flow

QUESTIONS & COMMENTS