

MURRAY LANE

- side walls will be each (3'4") wide by (6') tall
- pillars will be approximately (1'5") by (1'5") by (7') tall

***please note;

- the face of the pillars will be flush with the brick facade on the house, and the double walls will be set back (3"-5") away from the corner of the brick facade.

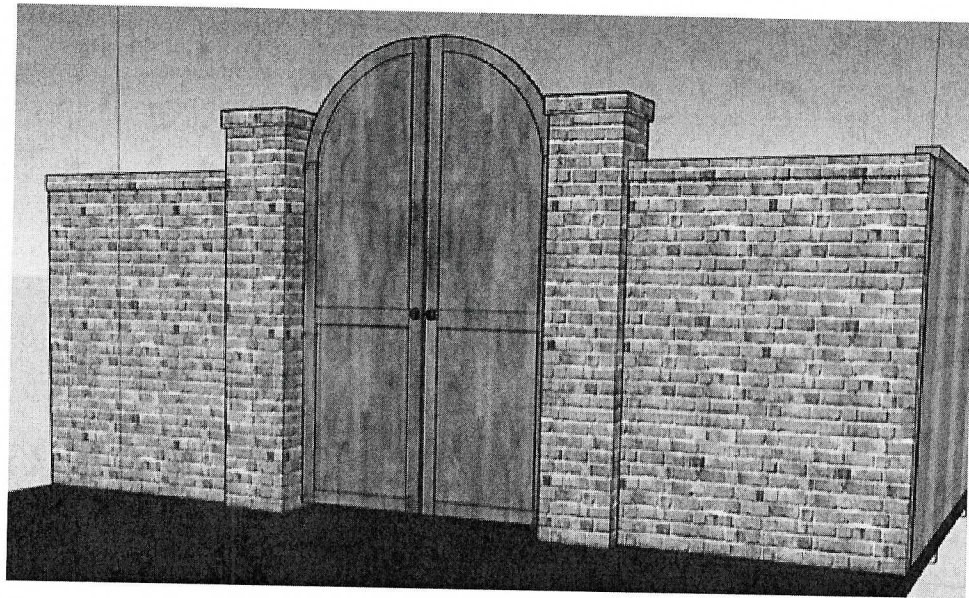

Build plan for load bearing masonry pillars

- 8"x8"x8" CMU blocks laid in type N masonry cement
- (3/8)" vertical rebar(s) with hoops (drilled 6" into the existing driveway and anchoring with epoxy)
- grouted entirely with (4000) psi concrete
- brick cladding

***please note:

- the "J"bolts will fastened approximately (4") inside the CMU block before grouting pillar with concrete

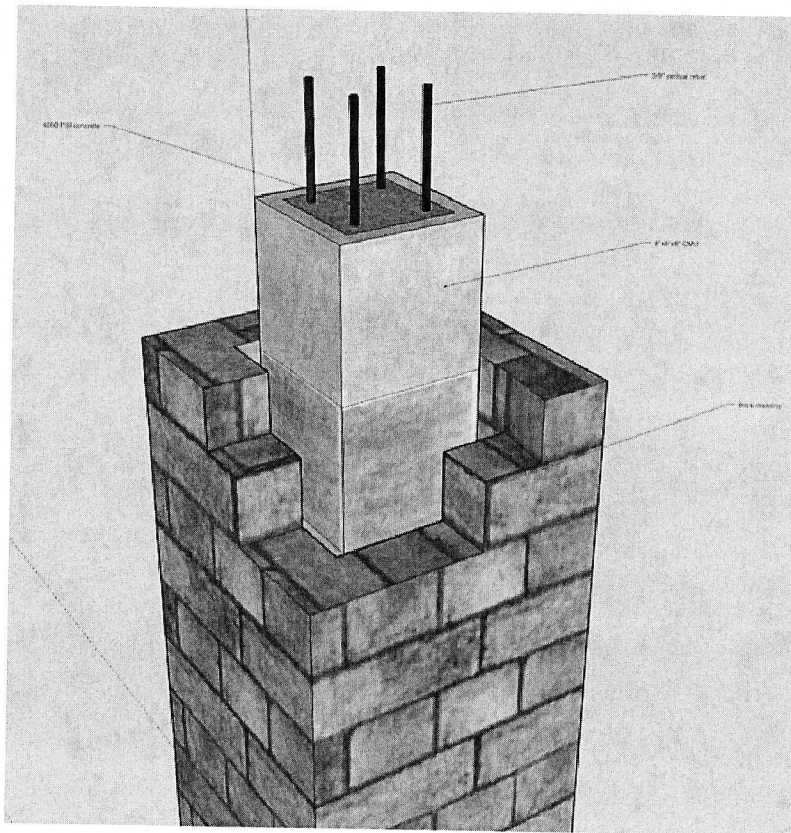



Description

Brick wall/ side yard entrance

J&L masonry LLC proposes to construct a (6' and 7') tall brick wall and dual load bearing masonry pillars to accommodate the provided dual swing doors, to create a side yard entrance (please refer to attached images for a visual representation for the proposed structure and over all design). This side yard entrance will be comprised of a "double-wall" brick installation as well as two grouted masonry pillars to withhold the floating weight of the provided doors, and the provided doors will have a level bolt system (this will allow for the door to unlock/lock via the level app or via key) along with a aged bronze single lock and handle. The installation process shall be as follows;

****after removal of the existing swing gate**

- marking of the area of installation of the double wall and pillars on existing driveway and on the existing brick facade on the house.
- scoring and removal of the brick facade on the house (this is better tie-in the new brick as well as allow for access to the existing sheathing to secure laminate wall-ties which secured the new bricks to the house)
- installation of a (2') long by (10") wide by (6") deep concrete footer with (3/8") rebar reinforcements
- installation of the load bearing dual masonry pillars (see attached images below for visual representation of the build plan) with (3) adjustable "J" bolt barrel hinges fastened to both pillars.
- installation of the double-wall brick walls (two free-standing sides of brick held together with no.9 gauge ladder reinforcements every 2') using modular size bricks in a "ruff" texture using type an gray masonry cement, with a horizontal row-lock as a cap course.
- installation of brick cladding in front of the load bearing masonry pillars with horizontal brick cap.
- painting of all new brick masonry (color matched paint, to match the brick facade on the house)
- installation door hardware (level bolt system, kwikset lock and single handle, and "L" gate cane, and female side mounted barrels hinges)
- hanging of the dual swing doors.
- site cleanup

****please note;**

- due the current availability of the brick size and texture needed for the proposed installation, (3) different colors of brick will be used. These bricks will be the exact same size, shape, and texture. This should not come as in issue upon completion of the installation as the brick will be painted.

*****Price shown above includes all material and labor costs**