

HISTORIC LANDMARK COMMISSION
DEMOLITION AND RELOCATION PERMITS
APRIL 26, 2021
HR-2021-044112
1000 ATKINSON ROAD

PROPOSAL

Demolish a church building moved onto the lot at 1000 Atkinson Road in 1964.

ARCHITECTURE

One-story wood frame building with gabled roof, vertical wood siding, vertical fixed windows, and covered entry with double doors.

RESEARCH

The church building at 1000 Atkinson Road was moved onto the lot from an unknown location in 1964. It first served as the home of the established Jackson Chapel congregation. In the late 1960s to early 1970s, it became the gathering place for the Young's Chapel A. M. E. Church congregation, who owned the property until late 2020.

STAFF COMMENTS

Designation Criteria—Historic Landmark

- 1) The building is more than 50 years old.
- 2) The building appears to retain moderate integrity.
- 3) Properties must meet two criteria for landmark designation (LDC §25-2-352). Staff has evaluated the property and determined that it does not meet two criteria:
 - a. *Architecture*. The building does not appear to convey architectural significance.
 - b. *Historical association*. The building is associated with the Jackson Chapel and Young's Chapel congregations.
 - c. *Archaeology*. The property was not evaluated for its potential to yield significant data concerning the human history or prehistory of the region.
 - d. *Community value*. The building does not possess a unique location, physical characteristic, or significant feature that contributes to the character, image, or cultural identity of the city, the neighborhood, or a particular demographic group.
 - e. *Landscape feature*. The property is not a significant natural or designed landscape with artistic, aesthetic, cultural, or historical value to the city.

STAFF RECOMMENDATION

Encourage relocation and adaptive reuse but release the permit upon completion of a City of Austin Documentation Package.

LOCATION MAP



PROPERTY INFORMATION

Photos





Applicant, 2021

Occupancy History

Post-1959 directory research unavailable due to facility closure.

Biographical Information

'Dr. Hepcat' Is No More: Pulpit Wins

Lavada Durst, the voice of rhythm and blues in Austin for 15 years, has taken up another cry these days. The longtime disc jockey, widely known throughout the area as "Dr. Hepcat," has officially been ordained a Baptist minister, and his next audience will be the congregation of the Jackson Chapel Church, where he will occupy the pulpit for the 11 a.m. service Sunday.

Since preaching his first sermon in May at the New Mount Olive Baptist Church, where he is also a member, the Rev. Durst has continued his duties as a recreation director at Rosewood Playground and the adjacent Doris Miller Auditorium, a post he has filled since before World War II.

But the colorful career of Dr. Hepcat, he says, is now in his past, and if he returns to radio



LAVADA DURST

in the future, it will be with gospel and spiritual music instead of Fats Domino's and Ray Charles'.

"I'm movin' now with the gospel," says the new reverend.

The Austin American, Jul 21, 1963

J. H. Carruthers, Pastor
Church School—9:30
Worship—11:00
YOUNG'S CHAPEL A.M.E.,
1000 Atkinson Rd.
Rev. G. L. Mays, Pastor
Sunday School—9:45 a.m.
Worship—11:00 a.m.

The Austin Statesman, Apr 3, 1971

Young's Chapel A.M.E. Church, 1000 Atkinson Road, will start a two-day Founders Day program today, featuring a style show of original creations by an Austin fashion designer whose grandparents founded Young's Chapel. For more information, contact Bobbie Johnson, 452-2955 or Novella Lee, 454-8167.

The Austin American Statesman, May 20, 1978

Permits

OWNER Jackson Chapel AME Church		ADDRESS 1000 Atkinson Rd.	
FLAT 468	LOT 1 & 2	BLK 3	
SUBDIVISION St. Johns College Addn			
OCCUPANCY Frame Church Bldg. onto Lot and Repair			
BLD PERMIT # 91332	DATE 3-23-64	OWNERS ESTIMATE	2,000.00
CONTRACTOR Dick Rathgeber		NO. OF FIXTURES	plans
WATER TAP REC # pd	SEWER TAP REC #	41683	

Church

Four paved off-street parking spaced to be provided two
rest rooms and one chair room, one study, two exits at
rear of bldg.

Relocation permit, 3-23-64
SANITARY SEWER SERVICE PERMIT
Austin, Texas

NE/№ 41683 P

Received of JACKSON CHAPEL AME Church Date 3-24-64
Address 1000 HARRISON
Amount FIFTY
Builder or Owner Owner Plumber Owner
Lot 142 Block 3 Subdivision 4 Tomas College Flat No. 46X
Date of Connection 6-12-64
By City 51' S of NLL
By Plumber
Checked By SWISHER
Size Main 8" Depth ±5'
Main Assign. 20' W of E FL
~~Size~~ Depth 5' Prop. Line 2 1/2
Stub Location 50' S of NLL IN
Book No. A-6351 CARVER AVE
Paving Cut 10h 50c No. 1

No.	Settings	Size	Price
20	Pipe	conc 6"	1134
1	Bends	conc 6"	100
	Reducers		
	Plugs		
	Sand		
	Gravel		
	Remix		
	Stoppers		
1	Other	JAP	100
		BACKHOLE	300
	Labor:	9 hr	1060
		TRUCK	150
		FOREMAN	223

Total \$2047

USE RUBBER GASKETS

Sewer tap permit, 3-24-64

ADDRESS: 1000 Atkinson Road.				PER-MIT 91332		PLAT 468	
LOT: 1 & 2				BLOCK 3		SUB. St Johns College Addn. from 75.00 under Hwy #2. 118029.	
				OUTLOT			
FIRE ZONE 3		USE DIST: A 1		OCCUPANCY: Church, More.			
4-1-64		LAYOUT		7-2-64		FRAMING	
5-22-64		PRINC. BLDG.		ACC. BLDG.		10-7-64	
7-17-70		83-70		PRINC. BLDG.		ACC. BLDG.	
FOUNDATION		FLOOR JOIST SIZE & O.C.		2 X 10 24"		NECESSARY BLDG. CONN.	
FR. SETBACK		CEILING JOIST SIZE & O.C.		2 X 10 24"		ROOM VENTILATION	
TOTAL & MIN. SIDE YD.		STUD SIZE & O.C.		2 X 9 24"		STAIRS REQ. & NO.	
SIDE STREET YARD		MASONRY WALL		ATTIC FIRE STOPS REQ.		2	

OWNER: Jackson Chapel AME Church CONTRACTOR: Dick Rathgeber.
26 X 56 = 1456, Four off set paving 2 Exits at rear of BLDG.
7-2-68 Exits under paving & paving
10 X 24 = 240 sq. Ft. added to Church. Paving started Jan. 7-16-70.

D.A. A.S. 3-23-64

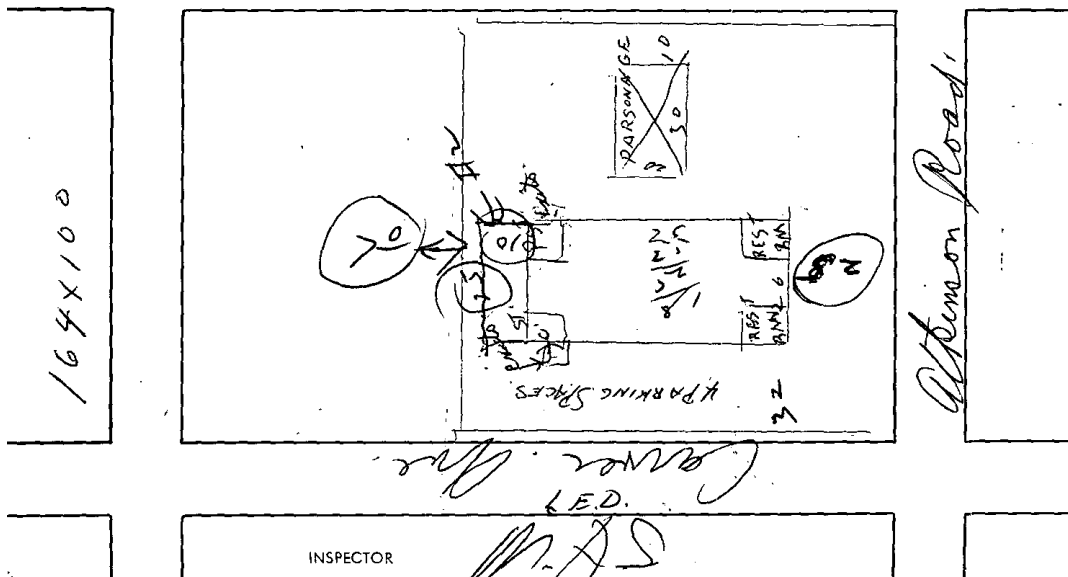

Inspection card, updated 1970.