

**ORDINANCE NO. 20210506-056**

**AN ORDINANCE AMENDING ORDINANCE NO. 20061116-055, WHICH ADOPTED THE EAST RIVERSIDE/OLTORF COMBINED NEIGHBORHOOD PLAN AS AN ELEMENT OF THE IMAGINE AUSTIN COMPREHENSIVE PLAN, TO CHANGE THE LAND USE DESIGNATION ON THE FUTURE LAND USE MAP FOR PROPERTY LOCATED AT 2105 PARKER LANE.**

**BE IT ORDAINED BY THE CITY COUNCIL OF THE CITY OF AUSTIN:**

**PART 1.** Ordinance No. 20061116-055 adopted the East Riverside/Oltorf Combined Neighborhood Plan as an element of the Imagine Austin Comprehensive Plan.

**PART 2.** Ordinance No. 20061116-055 is amended to change the land use designation from civic use to multifamily use for the property located at 2105 Parker Lane on the future land use map attached as **Exhibit "A"** and incorporated in this ordinance, and described in File NPA-2021-0021.01.SH at the Housing and Planning Department.

**PART 3.** This ordinance takes effect on May 17, 2021.

**PASSED AND APPROVED**

\_\_\_\_\_, May 6, 2021

§  
§  
§

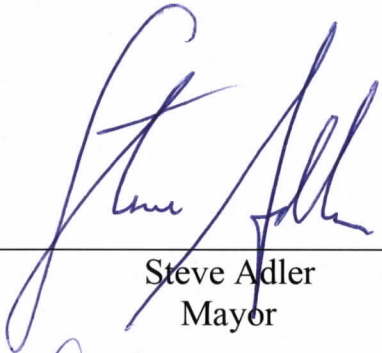
  
\_\_\_\_\_  
Steve Adler  
Mayor

**APPROVED:**

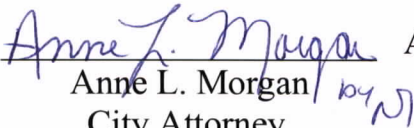
  
\_\_\_\_\_  
Anne L. Morgan  
City Attorney

**ATTEST:**

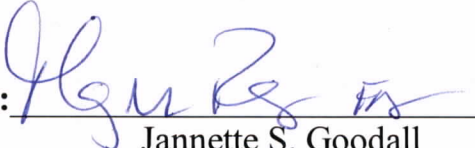
  
\_\_\_\_\_  
Jannette S. Goodall  
City Clerk

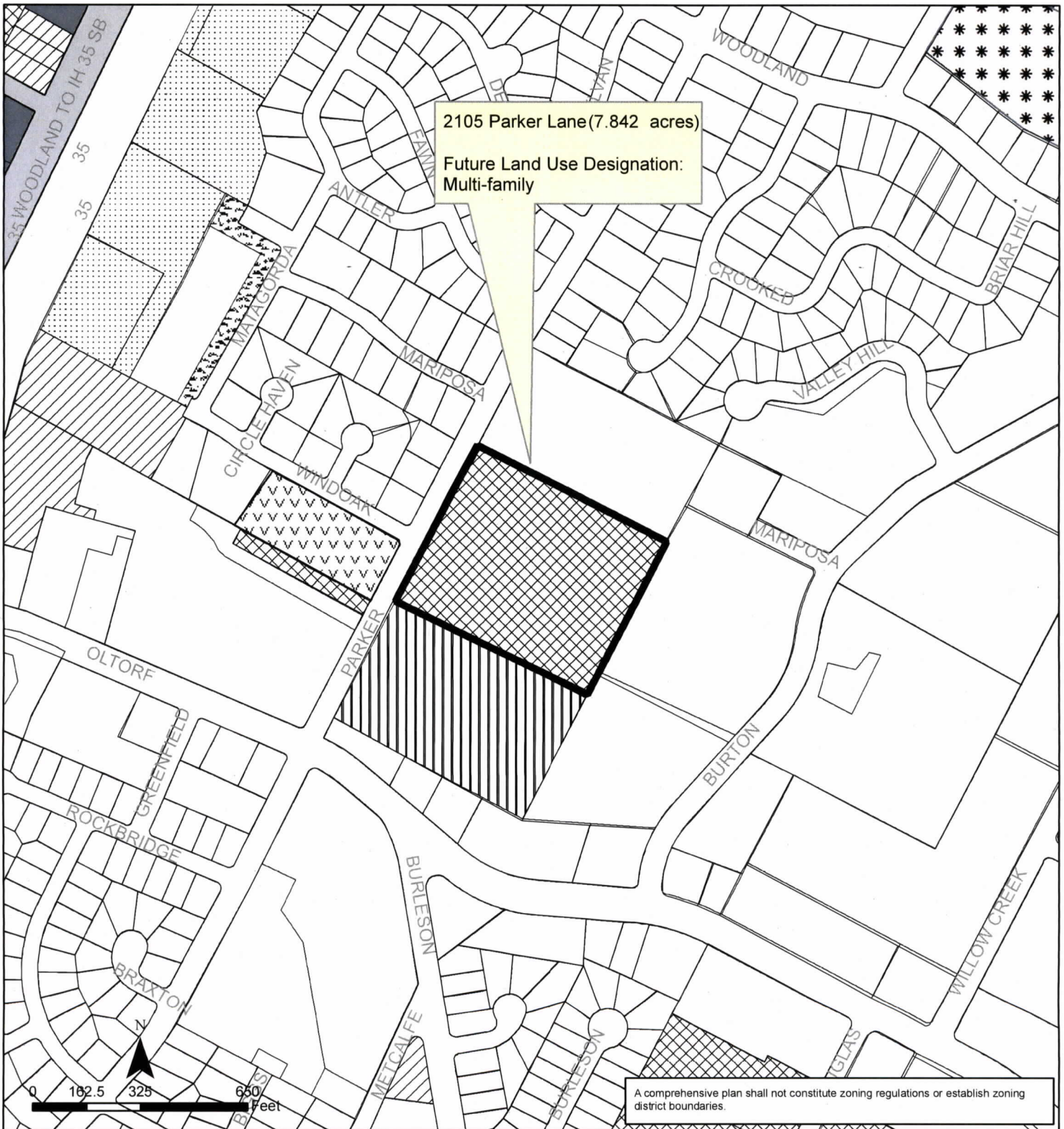

## Exhibit A

### East Riverside/Oltorf Combined Neighborhood Planning Area

#### NPA-2021-0021.01.SH

This product is for informational purposes and may not have been prepared for or be suitable for legal, engineering, or surveying purposes. It does not represent an on-the-ground survey and represents only the approximate relative location of property boundaries.

This product has been produced by the Housing and Planning Department for the sole purpose of geographic reference. No warranty is made by the City of Austin regarding specific accuracy or completeness.



City of Austin  
Housing and Planning Department  
Created on 1/22/2021, by: MeeksS

#### Future Land Use

	Subject Tract		Multi-Family
	Civic		Office
	Commercial		Recreation & Open Space
	Excluded from FLUM		Single-Family
	Higher-Density Single-Family		Specific Regulating District
	Mixed Use		Transportation