



MEMORANDUM OF UNDERSTANDING

TO: Greg Meszaros, P.E.
Director, Austin Water Department

FROM: Kimberly McNeeley, CPRP
Director, Parks and Recreation Department

SUBJECT: Spicewood Springs Regional Mobility Improvements

DATE: 9/28/2021

M.O.U. # PARD 21-003

Austin Water is allowed to use the parkland located at **Lower Bull Creek Greenbelt (7806 N Capital of Texas Hwy)** as part of the work site for the above referenced project, as indicated in Attachment "A" (Location Map).

The parkland is to be used for Temporary Use only. The requested area is:

Temporary Use (Work Area): 1,066 sq. ft. = \$333
Temporary Use (Staging Area): 6,138 sq. ft. = \$1,918

Total Mitigation Value = \$2,251

Austin Water is in agreement to provide the following 6-inch cement-treated base course at the north gravel parking lot at 5300 ½ Old Spicewood Springs Road, as mitigation in return for the temporary use of the parkland. The area of the restoration is 5,151 sq. ft., and is located adjacent to the existing concrete driveway. This area will be used for staging during the proposed project (see Attachment "B" Mitigation Area).
No other mitigation is required.

Subgrade Preparations = \$1,502

6-Inch Cement Treated Base Course = \$4,730

Total Park Value of Improvements = \$6,232

The estimated Project Start Date is January 2023

The estimated duration of the parkland use is 30 Calendar Days.

Estimated Date of Final Completion (Restoration complete and accepted by Environmental Inspector and PARD; Parkland open for Public Use) is February 2023

Extension/modification of parkland use must receive prior written approval from PARD. Additional fees will be assessed at the same daily rate as stated in Attachment "C" of this M.O.U.

Austin Water Point of Contact is: **Ron Crane, P.E.**

Phone Number: **512-972-0260**

Public Works Department Point of Contact is: **Grishma Shah, P.E.**

Phone Number: **512-974-3418**

Parks and Recreation Department Point of Contact is: **Gregory Montes**

Phone Number: **512-974-9458**

Parks & Recreation Board: 9-28-2021

Kimberly McNeeley, CPRP
Director, Parks and Recreation Department

Date

CONCURRENCE

Greg Meszaros, P.E.
Director, Austin Water

Date

Attachments:

- A (Mitigation Calculation Worksheet)
- B (Mitigation Area)
- C (Location Map)

ATTACHMENT "A" - M.O.U. MITIGATION FEES CALCULATION WORKSHEET - SUMMARY
--

Project:	Spicewood Springs Regional Mobility Improvements - AW
	MOU # 21-003

	Calculated Fee
Temporary Use - Residential Work Area	\$333
Temporary Use - Residential Staging Area	\$1,918
TOTAL =	\$2,251

ATTACHMENT "A" - M.O.U. MITIGATION FEES CALCULATION WORKSHEET

		Project: Spicewood Springs Regional Mobility Improvements - AW	
Temporary Use - Work Area		MOU # 21-003	
		MOU #	21-003
TCAD Land Value of Adjacent Properties (\$):	\$400,750		
Average Lot Size (sq. ft.):	16,028	<i>Based on Single Family lots zoned SF-2</i>	
Value per Square Ft. (\$):	\$25	<i>Average</i>	
Requested Area (sq. ft.):	1,066	<i>Submitted by Requesting Department/Entity</i>	
Preliminary Annual Value of Requested Area (\$)	\$26,653	<i>Area requested multiplied by Value per Square Ft.</i>	
Adjusted Annual Value of Requested Area (\$)	\$3,998	<i>(15% Rate of Return)</i>	
Monthly Value of Requested Area (\$)	\$333	<i>Adjusted Annual Value divided by 12</i>	
Daily Temporary Use Rate (\$):	\$11	<i>Monthly Value divided by 30 (Average number of days in a month)</i>	
Days Requested:	30	<i>Submitted br Requesting Department/Entity</i>	
Temporary Use Rate (\$):	\$333	<i>Daily Temporary Use Fee multiplied by Days Requested</i>	

ATTACHMENT "A" - M.O.U. MITIGATION FEES CALCULATION WORKSHEET

		Project: Spicewood Springs Rd Mobility Improvements - AW
Temporary Use - Staging		Lower Bull Creek Greenbelt
		MOU # 21-003
TCAD Land Value of Adjacent Properties (\$):	\$400,750	
Average Lot Size (sq. ft.):	16,028	<i>Based on Single Family lots zoned SF-2</i>
Value per Square Ft. (\$):	\$25	<i>Average</i>
Requested Area (sq. ft.):	6,138	<i>Submitted by Requesting Department/Entity</i>
Preliminary Annual Value of Requested Area (\$)	\$153,450	<i>Area requested multiplied by Value per Square Ft.</i>
Adjusted Annual Value of Requested Area (\$)	\$23,018	<i>(15% Rate of Return)</i>
Monthly Value of Requested Area (\$)	\$1,918	<i>Adjusted Annual Value divided by 12</i>
Daily Temporary Use Rate (\$):	\$64	<i>Monthly Value divided by 30 (Average number of days in a month)</i>
Days Requested:	30	<i>Submitted by Requesting Department/Entity</i>
Temporary Use Rate (\$):	\$1,918	<i>Daily Temporary Use Fee multiplied by Days Requested</i>

Prop ID	Avg Sq Ft	Land Value	
151782	24,578	\$500,500	
424043	12,919	\$367,500	
424044	13,461	\$367,500	
424045	13,155	\$367,500	
	16,028	\$400,750	Totals

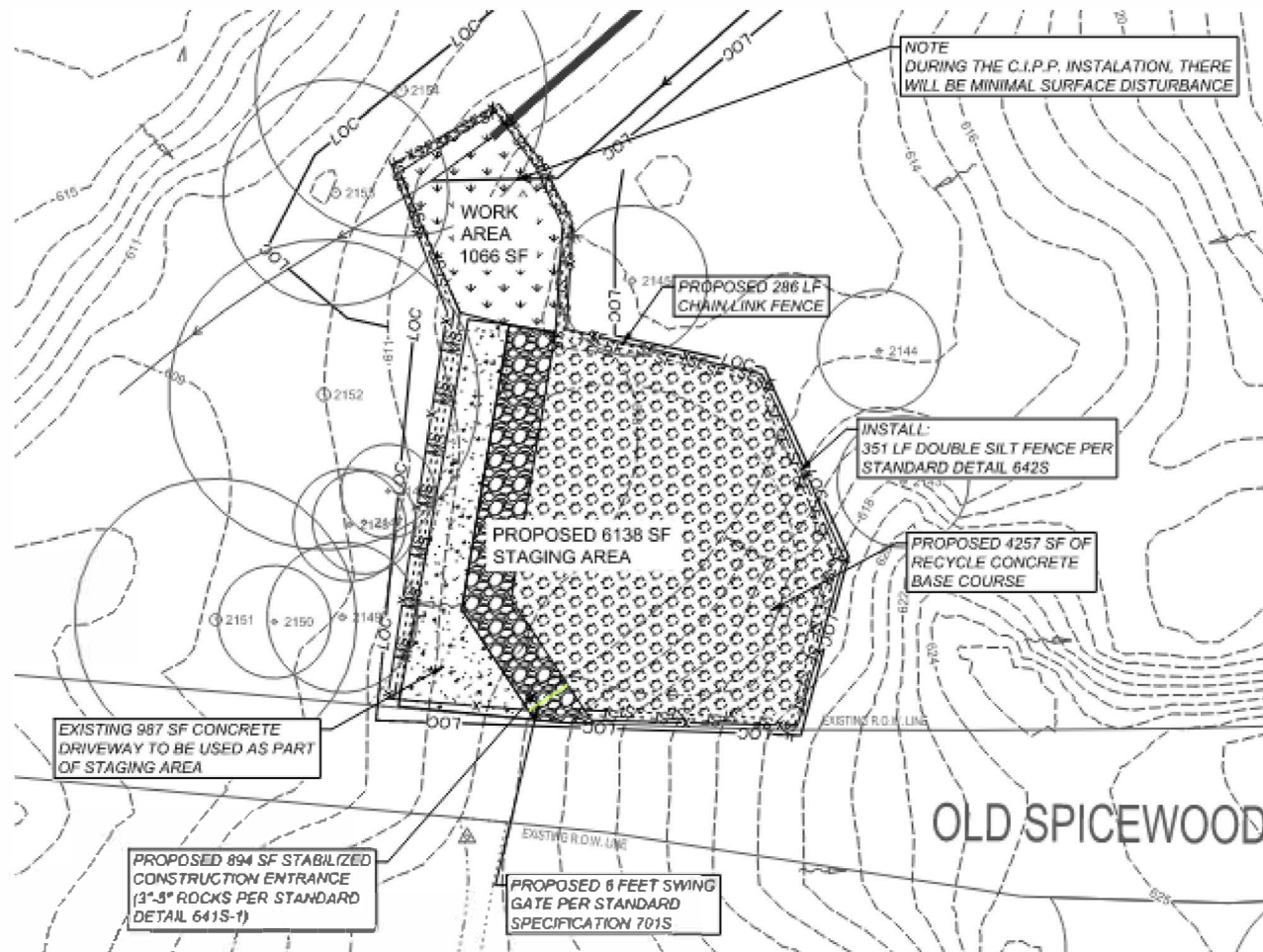

AERIAL PROJECT LOCATION MAP

