

Water Line Easement Proposed for Acquisition Located at 6843 1/2 West US 290 Highway



This product is for informational purposes and may not have been prepared for or be suitable for legal, engineering, or surveying purposes. It does not represent an on-the-ground survey and represents only the approximate relative location of property boundaries.

This product has been produced by the City of Austin for the sole purpose of geographic reference. No warranty is made by the City of Austin regarding specific accuracy or completeness.

Produced by M McDonald, 10/6/2021

- Water Line Easement Proposed for Acquisition
 - Property of Interest
 - TCAD Parcels
- Nearmap US Vertical Imagery by ESRI

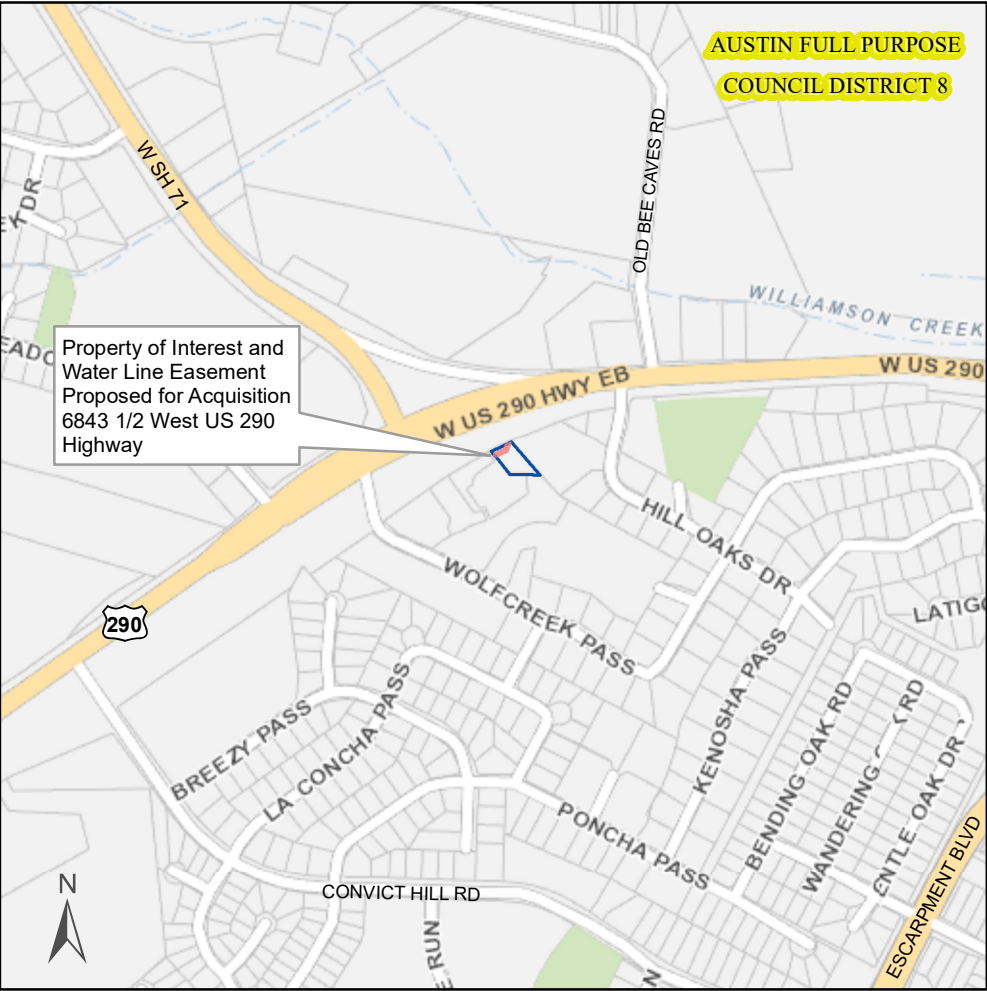

0 1,000 2,000 Feet

0 100 200 Feet