

**ORDINANCE NO. 20211118-097**

**AN ORDINANCE REZONING AND CHANGING THE ZONING MAP FOR THE PROPERTY GENERALLY KNOWN AS THE RUBINETT HOUSE, LOCATED AT 3004 BELMONT CIRCLE IN THE CENTRAL WEST AUSTIN COMBINED NEIGHBORHOOD PLAN AREA FROM FAMILY RESIDENCE-NEIGHBORHOOD PLAN (SF-3-NP) COMBINING DISTRICT TO FAMILY RESIDENCE-HISTORIC LANDMARK-NEIGHBORHOOD PLAN (SF-3-H-NP) COMBINING DISTRICT.**

**BE IT ORDAINED BY THE CITY COUNCIL OF THE CITY OF AUSTIN:**

**PART 1.** The zoning map established by Section 25-2-191 of the City Code is amended to change the base district from family residence-neighborhood plan (SF-3-NP) combining district to family residence-historic landmark-neighborhood plan (SF-3-H-NP) combining district on the property described in Zoning Case No. C14H-2021-0144 on file at the Housing and Planning Department, as follows:

Lot 11, BELMONT, a subdivision in Travis County, Texas, according to the map or plat thereof, recorded in Volume 5, Page 173, Plat Records of Travis County, Texas (the “Property”),

generally known as the Rubinett House, locally known as 3004 Belmont Circle in the City of Austin, Travis County, Texas, generally identified in the map attached as **Exhibit “A”**.

**PART 2.** The Property is subject to Ordinance No. 20100923-103 that established zoning for the Windsor Road Neighborhood Plan.

**PART 3.** This ordinance takes effect on November 29, 2021.

**PASSED AND APPROVED**

\_\_\_\_\_, November 19, 2021

§  
§  
§

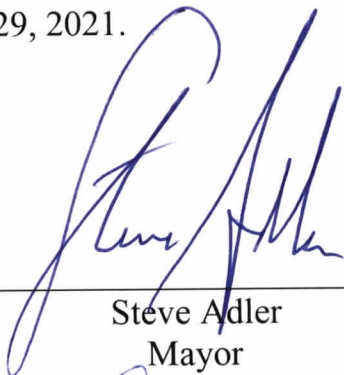
  
\_\_\_\_\_  
Steve Adler  
Mayor

**APPROVED:**

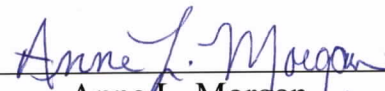
  
\_\_\_\_\_  
Anne L. Morgan  
City Attorney

**ATTEST:**

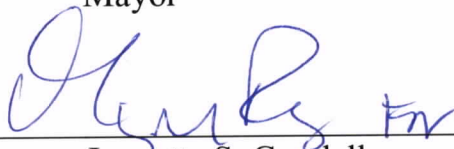
  
\_\_\_\_\_  
Jannette S. Goodall  
City Clerk

## LOCATION MAP

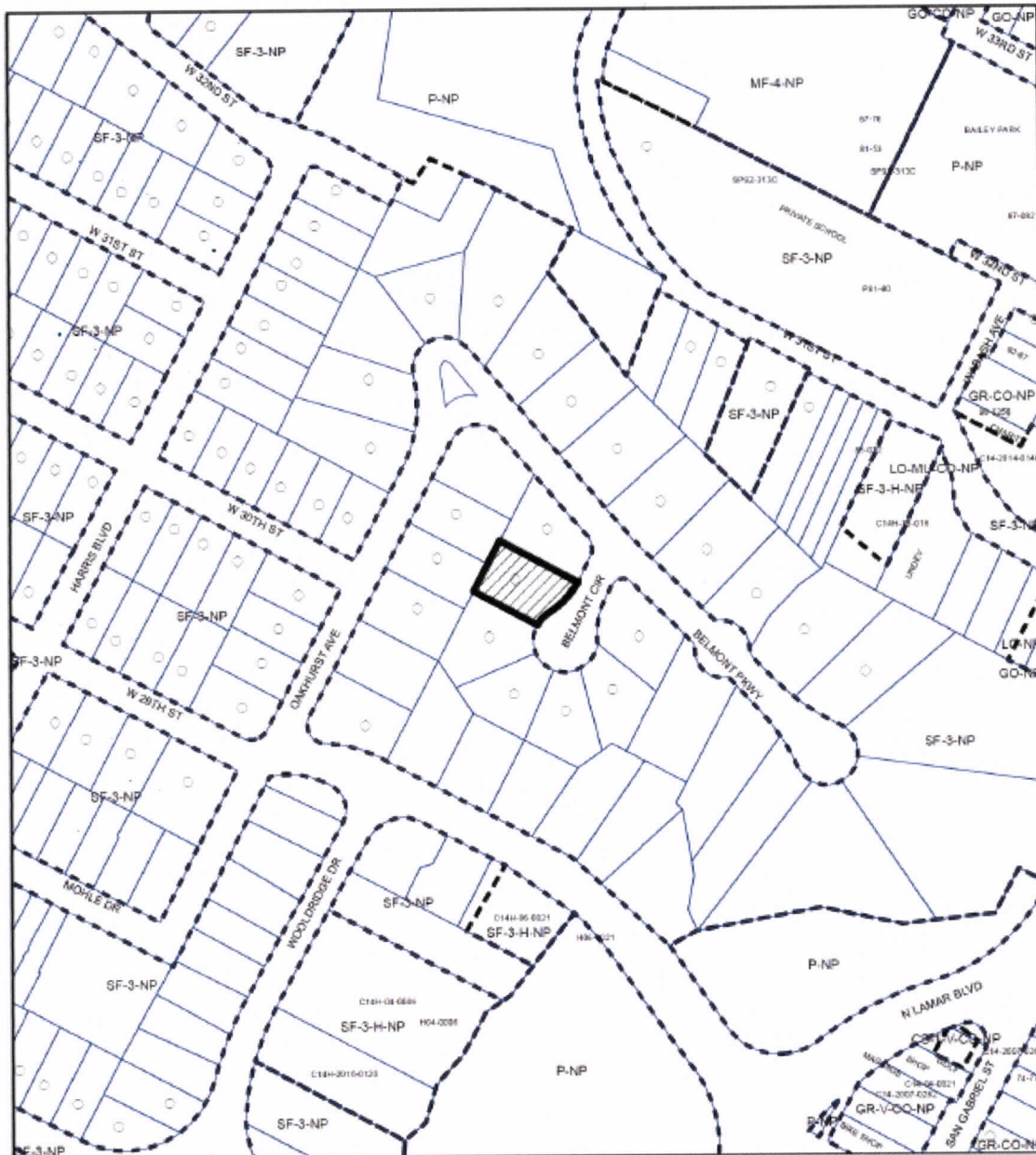

### HISTORIC ZONING

ZONING CASE#: C14H-2021-0144



- SUBJECT TRACT
- PENDING CASE
- ZONING BOUNDARY

1" = 200'

This product is for informational purposes and may not have been prepared for or be suitable for legal, engineering, or surveying purposes. It does not represent an on-the-ground survey and represents only the approximate relative location of property boundaries.

This product has been produced by the Housing and Planning Department for the sole purpose of geographic reference. No warranty is made by the City of Austin regarding specific accuracy or



Exhibit A