

**HISTORIC LANDMARK COMMISSION
DEMOLITION AND RELOCATION PERMITS
DECEMBER 17, 2021
GF-2021-192873
1401 HOLLY STREET**

PROPOSAL

Demolish a ca. 1920 house.

ARCHITECTURE

One-story hipped-roof house with a central hipped roof porch on Corinthian columns. The house is clad in horizontal wood siding. The front door and all windows have been replaced; the windows are obscured by solar screens.

RESEARCH

The house at 1401 Holly St. has had a series of short-term occupants. The first listed owners are Charles W. and Pearl L. Coons in 1918. Charles Coons worked as a yard clerk for the Houston & Texas Central Railway. Subsequent occupants held a variety of working-class jobs, including painter, driver, and line worker. Herman C. and Alma Hunter lived in the house between 1935 and 1939. Herman Hunter worked for Lone Star Wrecking Company.

From 1947 through 1971, the house was owned by John G. and Eva Maxey. John Maxey was a roller operator and driver for the City Street & Bridge Department. In 1969, he moved a mobile home onto the lot and attached it to the rear of the house to create a duplex.

PROPERTY EVALUATION

The [Historic Resources Survey for East Austin](#) (Hardy Heck Moore, Inc., 2016) lists the property as contributing to a potential South East Austin Historic District, recommended as eligible for listing in the National Register of Historic Places and as a local historic district.

Designation Criteria—Historic Landmark

- 1) The building is more than 50 years old.
- 2) The building has been modified appears to have a low to moderate level of integrity.
- 3) Properties must meet two criteria for landmark designation (LDC §25-2-352). Staff has evaluated the property and determined that may meet two criteria:
 - a. Architecture. The building does not retain architectural significance.
 - b. Historical association. The property does not appear to have significant historical associations.
 - c. Archaeology. The property was not evaluated for its potential to yield significant data concerning the human history or prehistory of the region.
 - d. Community value. The property does not possess a unique location, physical characteristic, or significant feature that contributes to the character, image, or cultural identity of the city, the neighborhood, or a particular demographic group.
 - e. Landscape feature. The property is not a significant natural or designed landscape with artistic, aesthetic, cultural, or historical value to the city.

STAFF RECOMMENDATION

Release the demolition permit upon completion of a City of Austin Documentation Package.

LOCATION MAP

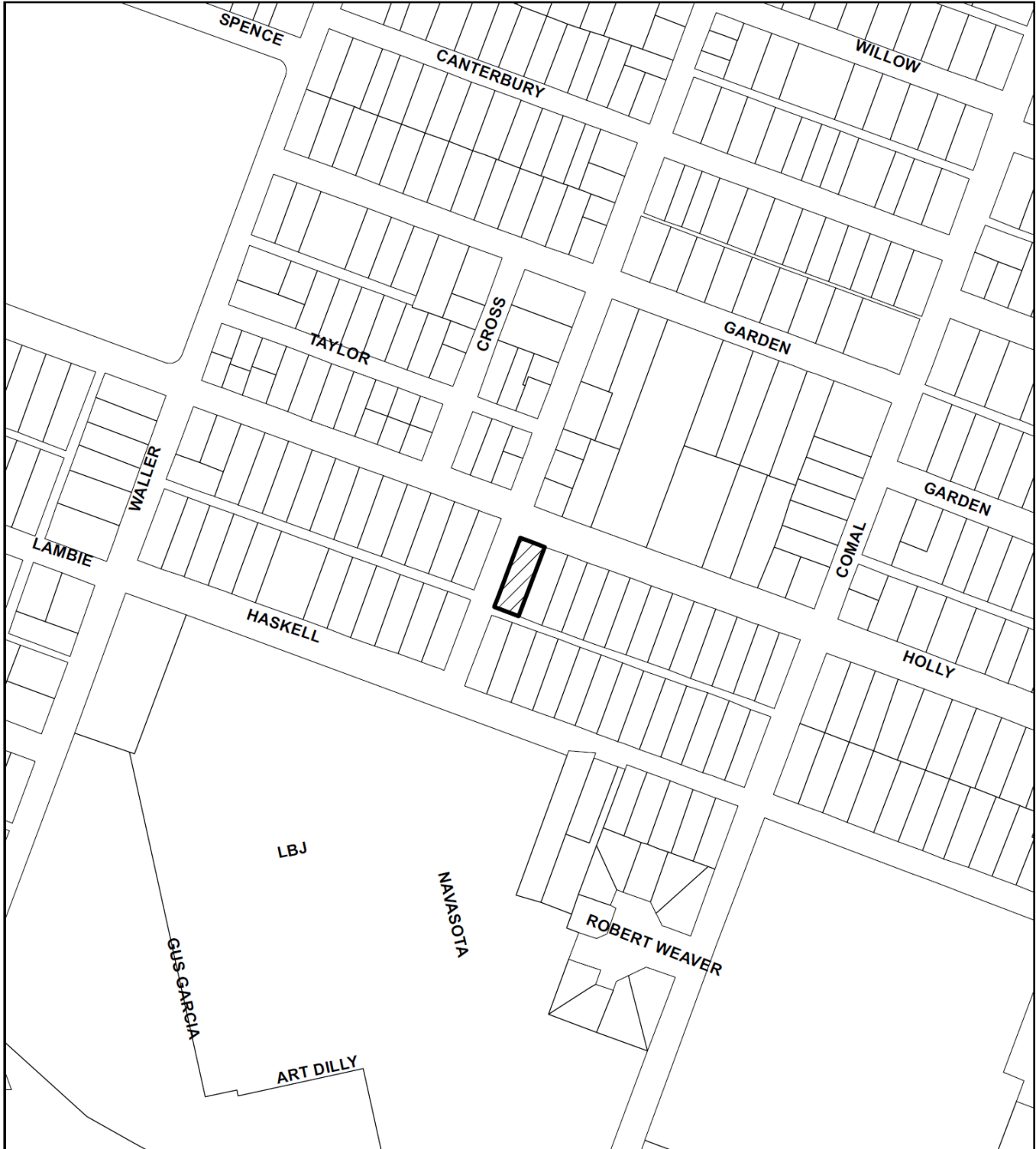

SUBJECT TRACT



PENDING CASE



ZONING BOUNDARY

NOTIFICATIONS

CASE#: GF 21-192873

LOCATION: 1401 HOLLY STREET

1" = 250'

This product is for informational purposes and may not have been prepared for or be suitable for legal, engineering, or surveying purposes. It does not represent an on-the-ground survey and represents only the approximate relative location of property boundaries.

This product has been produced by CTM for the sole purpose of geographic reference. No warranty is made by the City of Austin regarding specific accuracy or completeness.



PROPERTY INFORMATION

Photos



Google Street View, 2019





Application, 2021

Occupancy History

City Directory Research, November 2021

1959	John G. and Eva Maxey, owners Driver, City Street & Bridge Department
1957	John G. and Eva Maxey, owners Driver, City Public Works Department
1955	John G. Maxey, owner Employee, City Street & Bridge Department
1952	John G. and Eva Maxey, owners Roller operator, City Street & Bridge Department
1949	John G. and Eva Maxey, owners Machine operator
1947	John G. and Eva Maxey, renters Driver
1944	Silas M. and Mary Birmingham, renters Painter
1941	Sophia Hunter, renter Clerk
1939	Herman C. and Alma Hunter, renters Lone Star Wrecking Co.

- 1937 Herman C. and Alma Hunter, renters
Lone Star Wrecking Co.
- 1935 Herman C. and Alma Hunter, renters
Clerk, A & A Parts Co.
- 1932 Chloe J. Bingham, renter (widow of John R.)
Grace Bingham, renter
- 1929 Victor and Mary Maxey, renters
Lineman
- 1927 N. Louis and Addie M. Mason, renters
Driver, Meyer Creamery Co.
- 1924 Josephine Johnson, owner (widow of Frank)
- 1922 Josephine Johnson, owner (widow of Frank)
- 1920 Chas Moreland, renter
Painter
- 1918 Chas W. and Pearl L. Coons, owners
Yard clerk, H & T C
- 1916 *Address not listed*

Biographical Information

JOHN G. MAXEY

Funeral services for John G. Maxey, 67, of 1401 Holly, will be held at 4 p.m. Tuesday at Brook-Walden Funeral Home with Rev. Bill Jackson, pastor of Rosedale Baptist Church, officiating. Burial will be in Austin Memorial Park.

Pallbearers will be Leroy Greel, Joe Boyer, Lester Miles, Edward Maxey, Kenneth Reed and Jerry Carnline. Honorary pallbearers will be employees of

16 Street and Bridge Department, City of Austin.

Maxey is survived by his wife, Mrs. Eva Maxey of Austin; one daughter, Mrs. Bobbie New of Austin; one son, Charles Maxey of Beeville; his father, Jesse Billingsley of Smithville; two brothers, Victor Maxey of Austin and Augustus Maxey of Decor, Calif., one sister, Mrs. Francis Alsup of Austin; six grandchildren and two great-grandchildren.

The Austin Statesman, May 31, 1971

Permits

WATER SERVICE PERMIT

Austin, Texas

E N^o 15568

Received of Zot 1 Date _____
 Address 1401 Holly St Miter in ally
 Amount No Rec. of Ser. - Locate & ~~Renew~~ Renew \$ Pd Tap
 Plumber IF not COP. Size of Tap _____

Date of Connection _____		Size
Size of Tap Made _____		
Size Service Made _____		No. Fittings
Size Main Tapped _____		
From Front Prop. Line to Curb Cock _____		Corp. Cock
From Prop. Line to Curb Cock _____		
Location of Meter _____		Elbow
Type of Box _____		
Depth of Main in St. _____		St. Elbow
Depth of Service Line _____		
From Curb Cock to Tap on Main _____		Bushing
Checked by Engr. Dept. _____		
		Reducer
		Pipe
		Lead Comp.
		Nipples
		Union
		Plug
		Tee
		Stop
		Box
		Lid
		Valves
		Job No.
		Req. No.

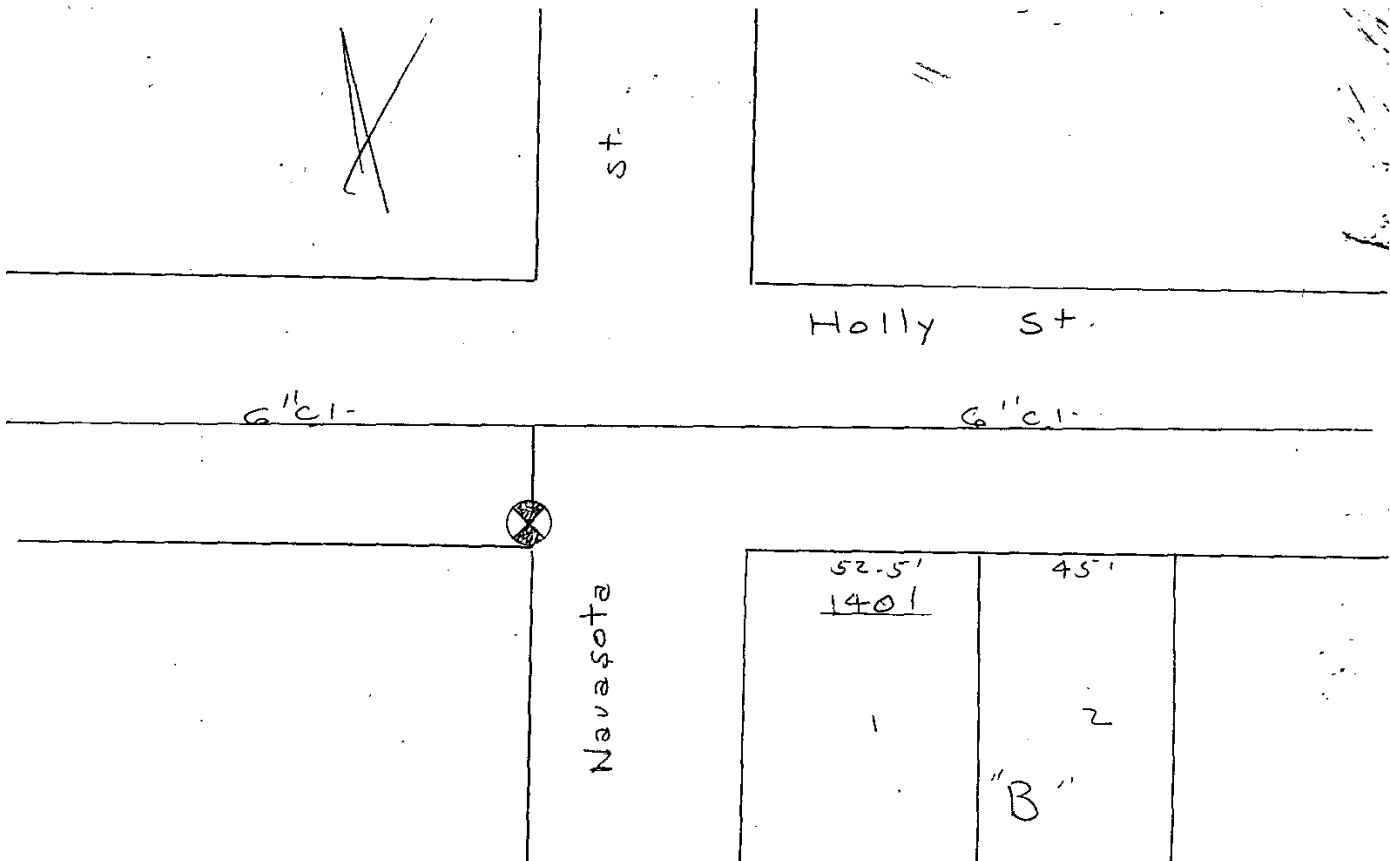

submap
 CONNECTING CHARGE \$ 12.00
 APPLICATION FOR SEWER CONNECTION.
 Austin, Texas. Feb 29 1928
 No. 78568

To the Superintendent of Sewer and Public Improvements,
 City of Austin, Texas.

Sir:—

I hereby make application for sewer connection and instructions on
 premises owned by J. L. Strong
 at 1401 Holly Street
LOT 1 BLK B
 which place is to be used as a residence

In this place there are to be installed 1 fixtures

I agree to pay the City Sewer Department the regular ordinance
 charge.

Respectfully,

Location of Public Sewer

Connected 3-17 1928

Size of Main 36 inches

Size of Service 4 inches

9 Feet Deep in ST

40 Feet from Property Line

Feet from Curb Line

Connection made by

Spencer

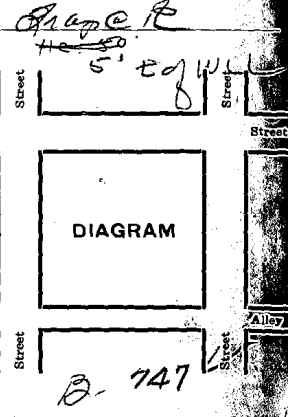

Sewer service permit, 1928

OWNER John G. Maxey ADDRESS 1401 Holly Street
 PLAT 135 LOT 1 BLK B
 SUBDIVISION Free and Williams
 OCCUPANCY Duplex
 BLD PERMIT # 114680 DATE 10-1-69 OWNERS ESTIMATE \$2,000.00
 CONTRACTOR owner NO. OF FIXTURES several
 WATER TAP REC # Exist SEWER TAP REC # Exist
 Mobile home onto lot and tie to res to create duplex
 96 sq. ft.
 5-2-72-129230-remodel exist duplex

Relocation permit related to duplex conversion, 1969

HHM ID 0935

1401 HOLLY ST



Jan 2016 Heading: SE

Image ID 944



Jan 2016 Heading: SW

Image ID 945

IDENTIFICATION

Street number **1401**
 Street name **HOLLY**
 Street type **ST**
 Zip code **78702**
 Addition / subdivision **FREE & WILLIAMS SUBD**
 Neighborhood **EAST CESAR CHAVEZ**
 Legal description **LOT 1 BLK B OLT 57 DIV O FREE & WILLIAMS SUBD**

Zoning code **SF-3-NP**
 Owner name 1 **LIU HARVEY ALEX**
 Owner city **AUSTIN**
 Owner state **TX**
 Owner zip code **78726**
 Parcel ID **188788**
 Zoning ID **136769**

GENERAL EXTERIOR

Type **Building - Residential - Single-Family House - Hipped-Roof Square-Plan**

Stylistic influences **No style**

HISTORY

Current use **Residential**

Year built **1920**
 Source for year built **TCAD**

INTEGRITY

Additions *None visible*

Alterations **Doors replaced, Screens replaced**

PREVIOUS AND RECOMMENDED DESIGNATIONS

Previous and recommended local designations **No previous local designations; Recommended contributing to a local historic district**
 Recommended local designations **Recommended contributing to a local historic district**
 Potential local historic district **South East Austin Historic District**

Previous and recommended NRHP designations **No previous NRHP designations; Recommended contributing to a NRHP district**
 Recommended NRHP designations **Recommended contributing to a NRHP district**
 Potential NRHP historic district **South East Austin Historic District**
 Recommendation notes **South East Austin**