



MEMORANDUM

TO: Nadia Barrera-Ramirez, Chair
Members of the Zoning and Platting Commission

FROM: Wendy Rhoades
Housing and Planning Department

DATE: January 12, 2022

RE: **C14-2020-0079 and C14-2020-0080 – RBI Austin Tract 1 and RBI Austin Tract 2**

The Staff requests an indefinite postponement of the above-referenced rezoning cases in order to continue review of the Traffic Impact Analysis and related discussions with the Applicant. The Applicant does not object to the Staff’s requests.

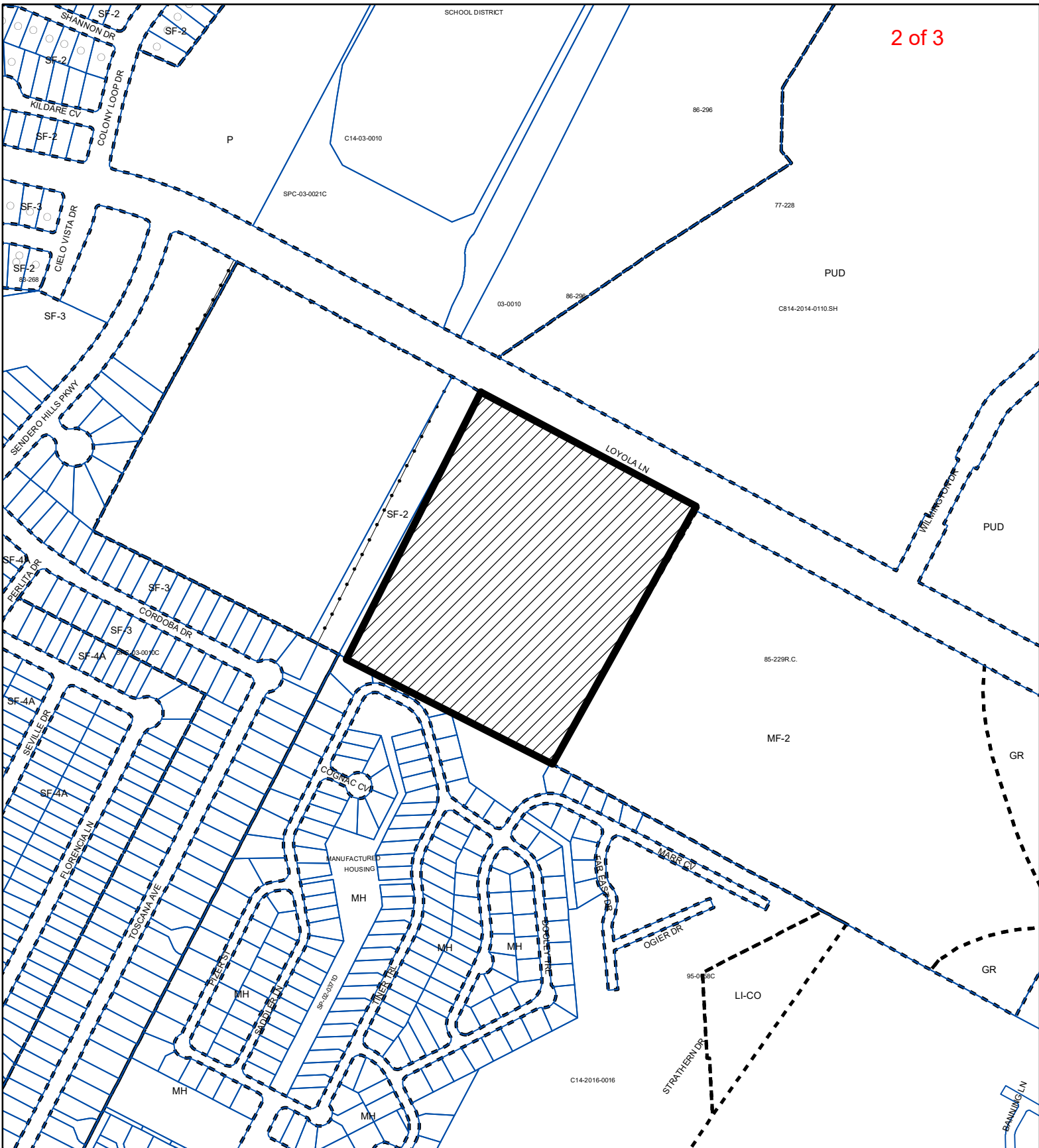

Attachments: Maps of Properties



ZONING

ZONING CASE#: C14-2020-0079



-  SUBJECT TRACT
-  PENDING CASE
-  ZONING BOUNDARY

1" = 400'

This product is for informational purposes and may not have been prepared for or be suitable for legal, engineering, or surveying purposes. It does not represent an on-the-ground survey and represents only the approximate relative location of property boundaries.

This product has been produced by CTM for the sole purpose of geographic reference. No warranty is made by the City of Austin regarding specific accuracy or completeness.



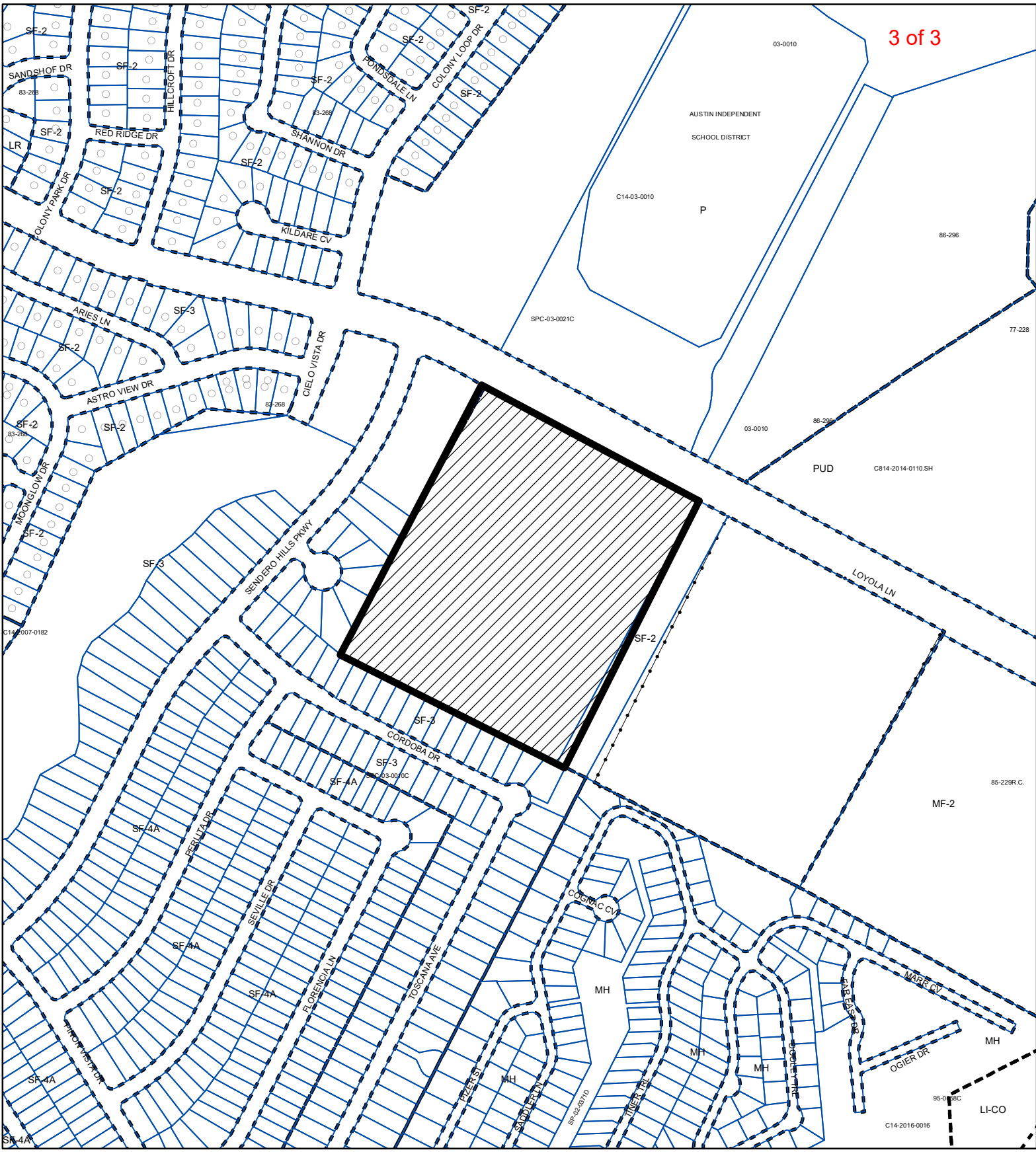

Created: 7/22/2020



ZONING

ZONING CASE#: C14-2020-0080



-  SUBJECT TRACT
-  PENDING CASE
-  ZONING BOUNDARY

1" = 400'

This product is for informational purposes and may not have been prepared for or be suitable for legal, engineering, or surveying purposes. It does not represent an on-the-ground survey and represents only the approximate relative location of property boundaries.

This product has been produced by CTM for the sole purpose of geographic reference. No warranty is made by the City of Austin regarding specific accuracy or completeness.



Created: 7/22/2020