

An aerial photograph of Waterloo, Ontario, Canada. The image shows a dense urban grid with numerous buildings, streets, and green spaces. The Grand River flows through the city from the top left towards the bottom right. A yellow line highlights a specific route, likely the Greenway, which starts near the river and runs through the city center. The text "Waterloo Greenway Creek Delta Project Update" is overlaid on the bottom left of the image.

Waterloo Greenway Creek Delta Project Update

Design Commission Meeting
December 13, 2021

Agenda

1. Waterloo Greenway Program Overview
2. Creek Delta Project Update
3. **Possible Action:** Request Support for Creek Delta Project & Recommendation to Planning Commission for Conditional Use Permit

Program Overview

waterloo greenway

Sponsoring City Departments:
Watershed Protection
Department &
Parks and Recreation Department



Non-Profit Partner:
Waterloo Greenway
Conservancy



Mission

Waterloo Greenway Conservancy creates and maintains an extraordinary urban park system and a restored Waller Creek, in partnership with the City of Austin, **for the benefit of all**. The Conservancy renews the natural environment, promotes play, health and wellness, economic vitality and mobility, and engages the community through outreach, education, cultural events, and the arts.

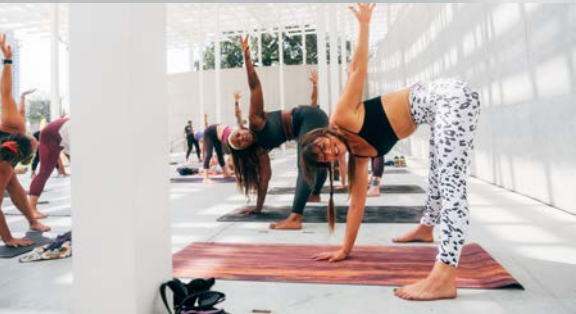

Community Programming

OUTREACH OVERVIEW



- Feb 2018 – Waller Creek public meetings at MACC
- June 2018 – School field trip collaboration: Waller Creek/MACC
- Aug 2018 – Tabling at trail: Waller Creek/MACC
- Feb 2019 – Tabling at Austin Energy meeting at MACC
- May 2019 – Environment Commission presentation
- Summer 2019 – Presentation at Rainey neighborhood meeting at MACC
- Sept 2019 – Tabling at MACC “¡Viva México!” event
- Sept 2019 – Presentation at HQOL Commission
- Oct 2019 – Presentation at District 9 Rainey Street Historic District Visioning Meeting
- Nov 2019 – Tabling at MACC “Día de Los Muertos” event
- Feb 2020 – Palm District: R/UDAT Community/Project Area Tour
- March 2020 – MACC Advisory Board meeting presentation
- March 2020 – MACC Advisory Board meeting presentation
- Jan 2021 – MACC Advisory Board meeting
- March 2021 – MACC Working Group meeting
- Jan 2021 – Rainey Street Neighborhood presentation
- Sept 2021 – Environment Commission presentation
- Oct 2021 – Parks and Recreation Board presentation
- Nov 2021 – Creek Show at Waterloo Park



Texas Capitol

Robert C. Byrd, Jr.
Council Forth- Easton

SAN JACINTO BLVD

TRINITY ST

NECHES ST

RED RIVER ST

SABINE ST

IH-35

15th St

Moody Amphitheater

Waterloo Park

Central Health Breckinridge
Redevelopment Site

Frank C. Irwin, Jr.
Special Events Center

Dell Seton
Medical Center

Dell Medical School
at the University of Texas

Symphony Square

The Refuge

Palm Park

Palm School

Austin Convention Center

RAINEY ST

DAVIS ST

DRAKE ST

12th St

Emma S. Barrientos
Mexican American
Cultural Center

Creek Delta

Pontoon Bridge

Lady Bird Lake

Waterloo Greenway

Phase 1 Phase 2 Phase 3

wg

Creek Delta



- Located along Waller Creek between Lady Bird Lake and 4th Street
- Identified in Council-approved Waller Creek Design Plan
- Approximate 10-acre project area. Creek restoration, 1 mile of new trails, pedestrian bridges, water quality and utility improvements
- Preparing 100% construction documents, anticipated by December 2021



Moving away from the convention of hard engineering solutions...



...toward soft engineering solutions



In-channel Stability



Aquatic Planting



Stumpery



Live Fascines



Bank Stability

Environmental Goals

- Functional Assessment (Environmental Criteria Manual)
- Water Quality - Biofiltration Pond and Inline Stormwater Treatment
- Trees
 - Vegetation and Soil Protection Zones
 - Enhanced tree mitigation and planting
- Sustainable SITES Certification

GEOMORPHOLOGY				AQUATIC			
Ensure Channel Healthy Ventilation & Stable Soils	Prevents Mass Wasting	Prevent Entrenchment of Channel	Provide Obstructions, Deflections & Beneficial Scouring & Deposition	Ensure Storm Flowa Hurricane Floodplain	Provide to fluvial Substrate & Cover	Prevent Entrenchment of Stream Bottom	Ensure Diversity of Velocity / Depth Regimes
•	•	•	•	•	•	•	•
•	•	•	•	•	•	•	•
•	•	•	•	•	•	•	•
•	•	•	•	•	•	•	•
•	•	•	•	•	•	•	•
•	•	•	•	•	•	•	•
•	•	•	•	•	•	•	•

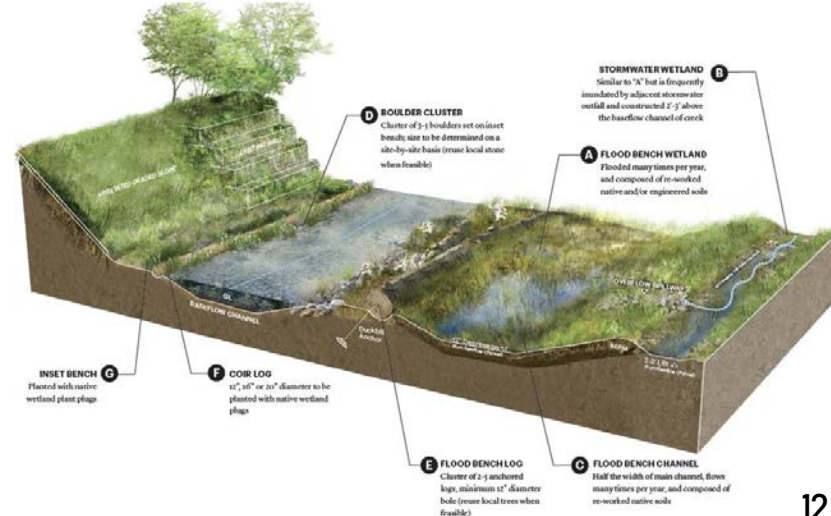

THE Sustainable SITES Initiative®

SITES is the most comprehensive rating system used to certify design and construction projects focused on sustainable landscapes that want to measure performance and elevate their value. It was developed here in Central Texas, and is now administered Internationally by Green Business Certification Inc. (GBCI) - just like LEED.

Connectivity & Mobility

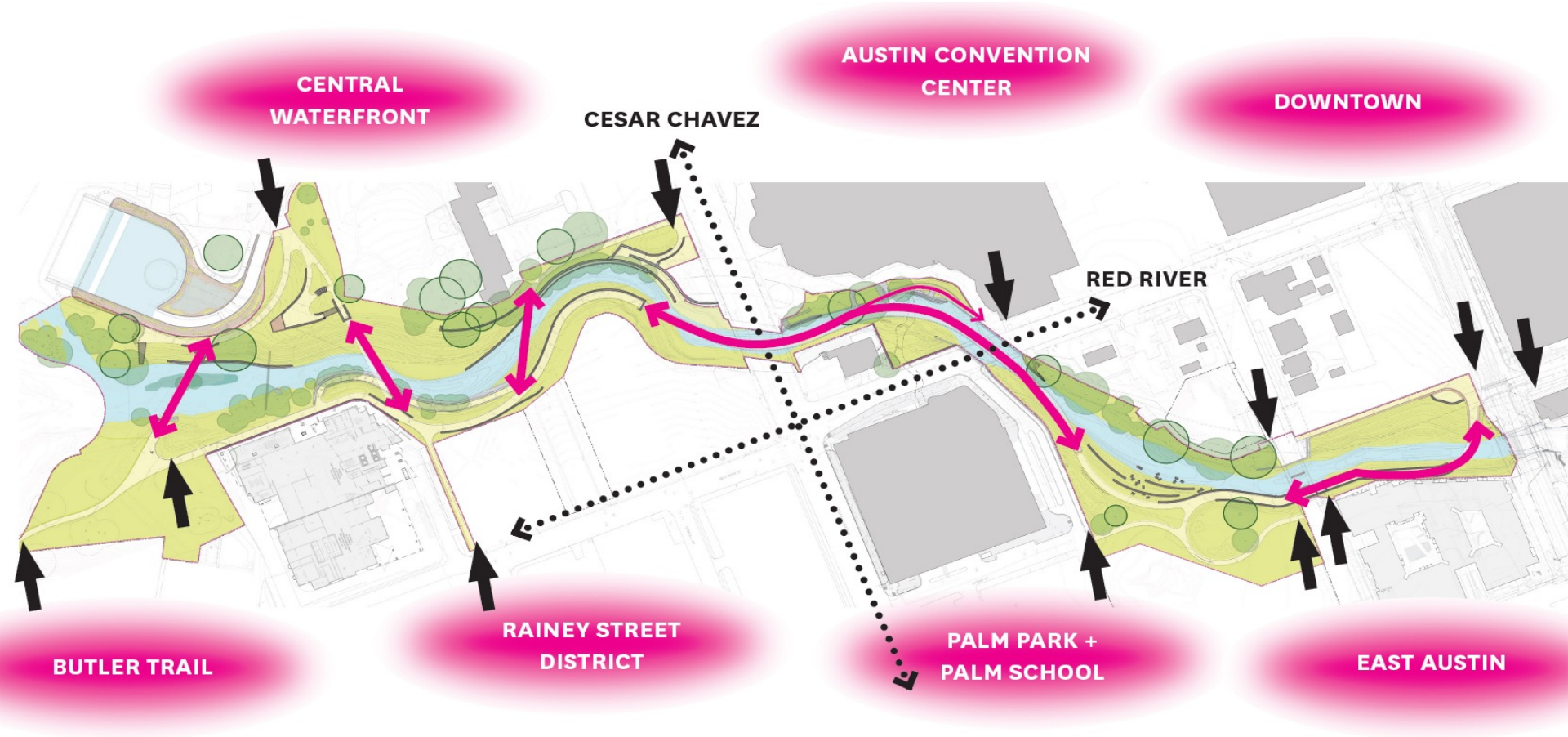

Elevated Walkway + Bridges

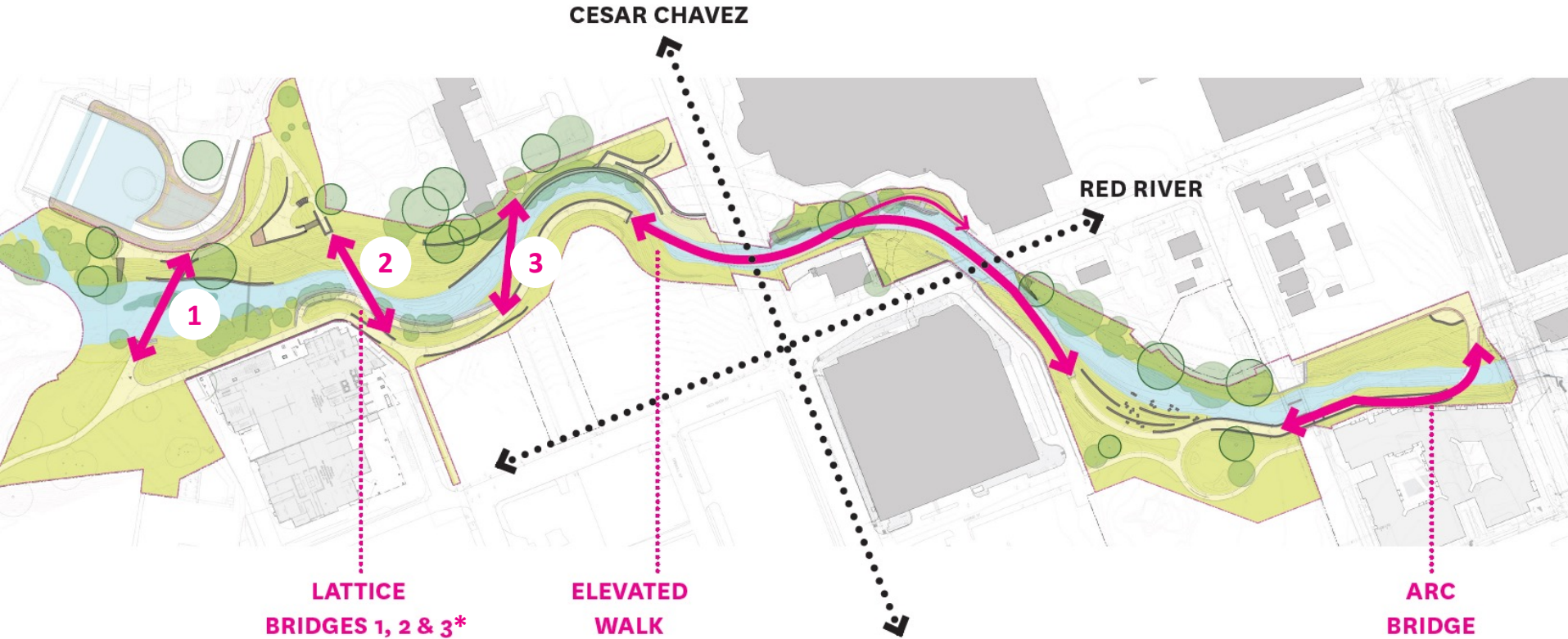

*Lattice Bridge 3 is currently an add/bid alternate.

Lattice Bridges



Elevated Walkway



Cypress Grove + Trailhead Plaza



Lagoon Overlook + Leaf Deck

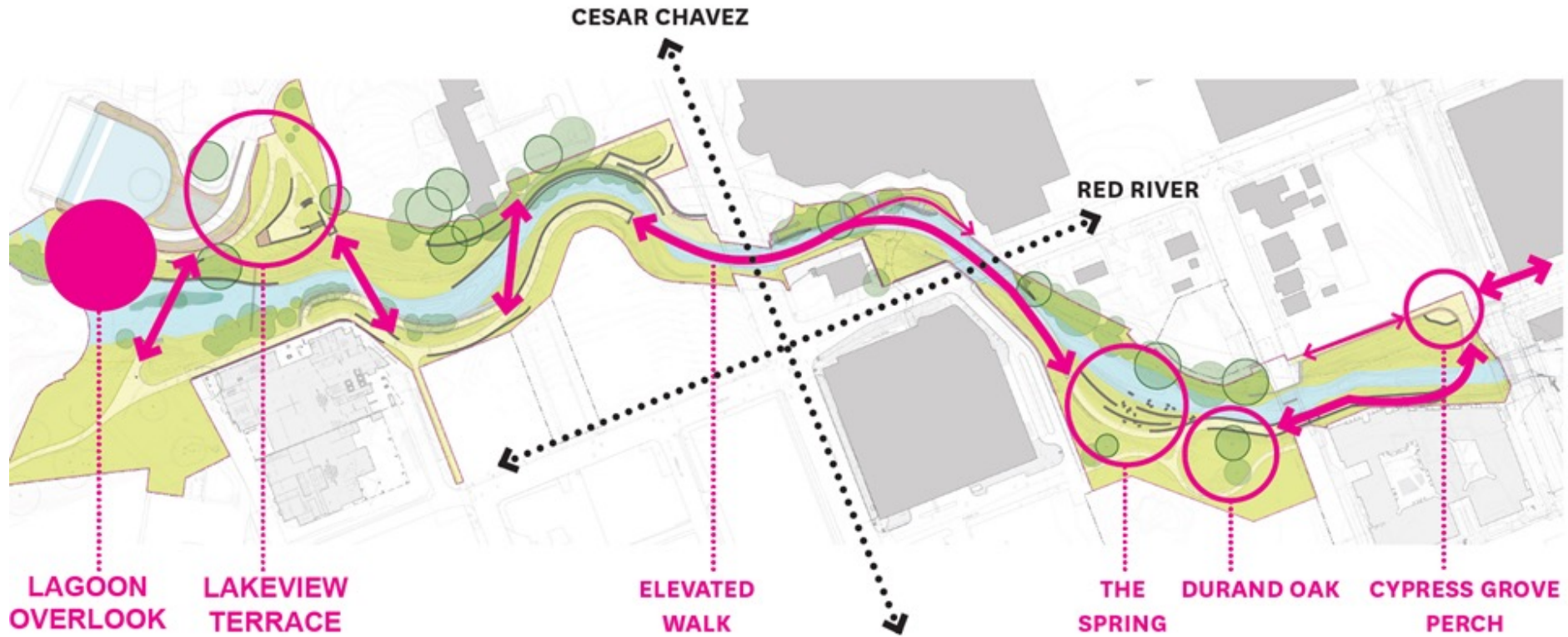

Lakeview Terrace + Explorer's Garden

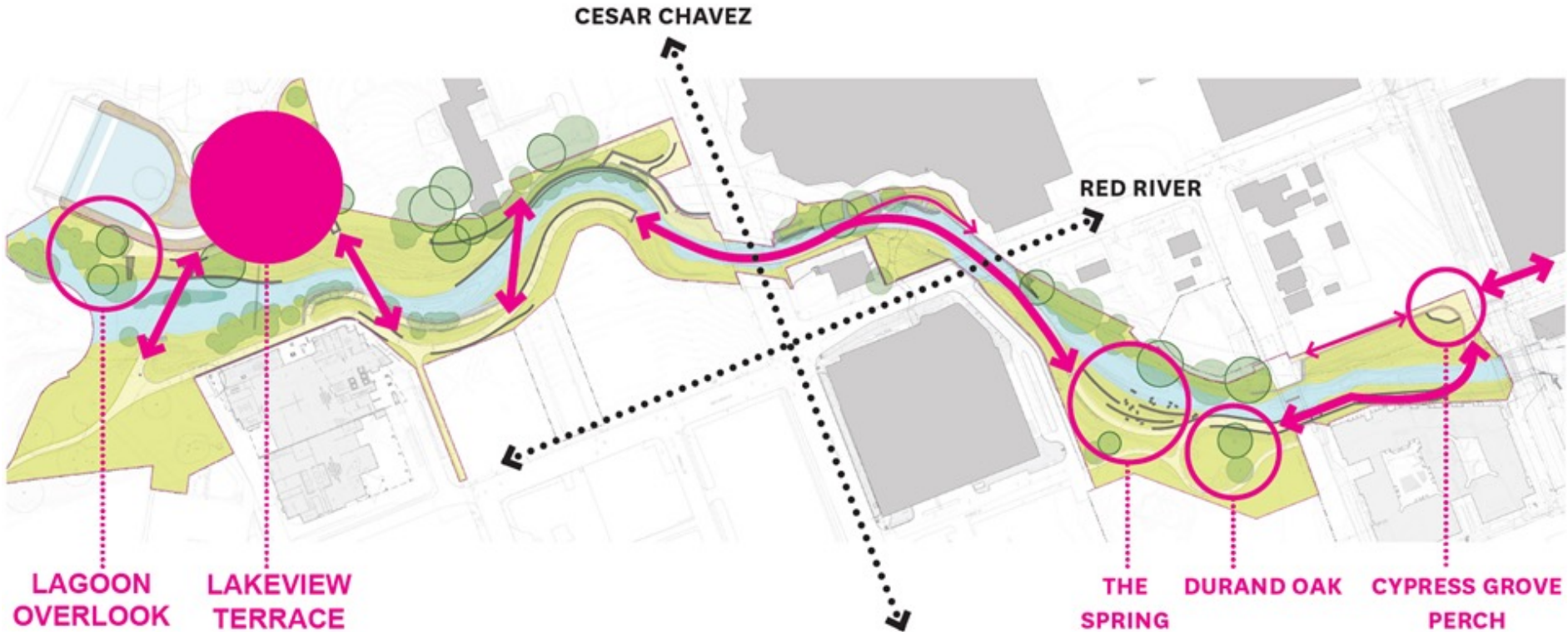

Lakeview Terrace + Explorer's Garden



The Spring

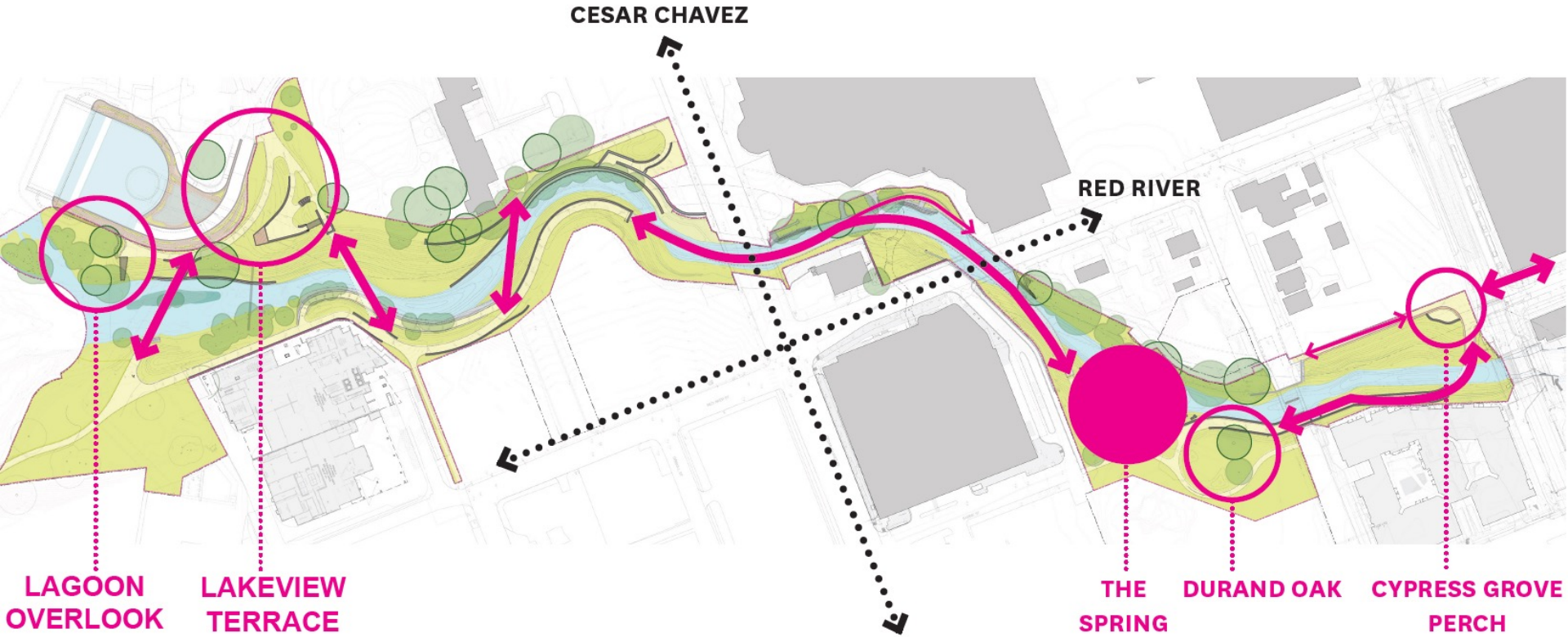

The Spring



Conditional Use for “P” Zoning

- Required for all site development permits on public land over 1 acre
- NOT related to CUP permit for alcohol sales
- **Possible Action: Support of Creek Delta Project & Conditional Use Permit for “P” Zoning**

Creek Delta Schedule

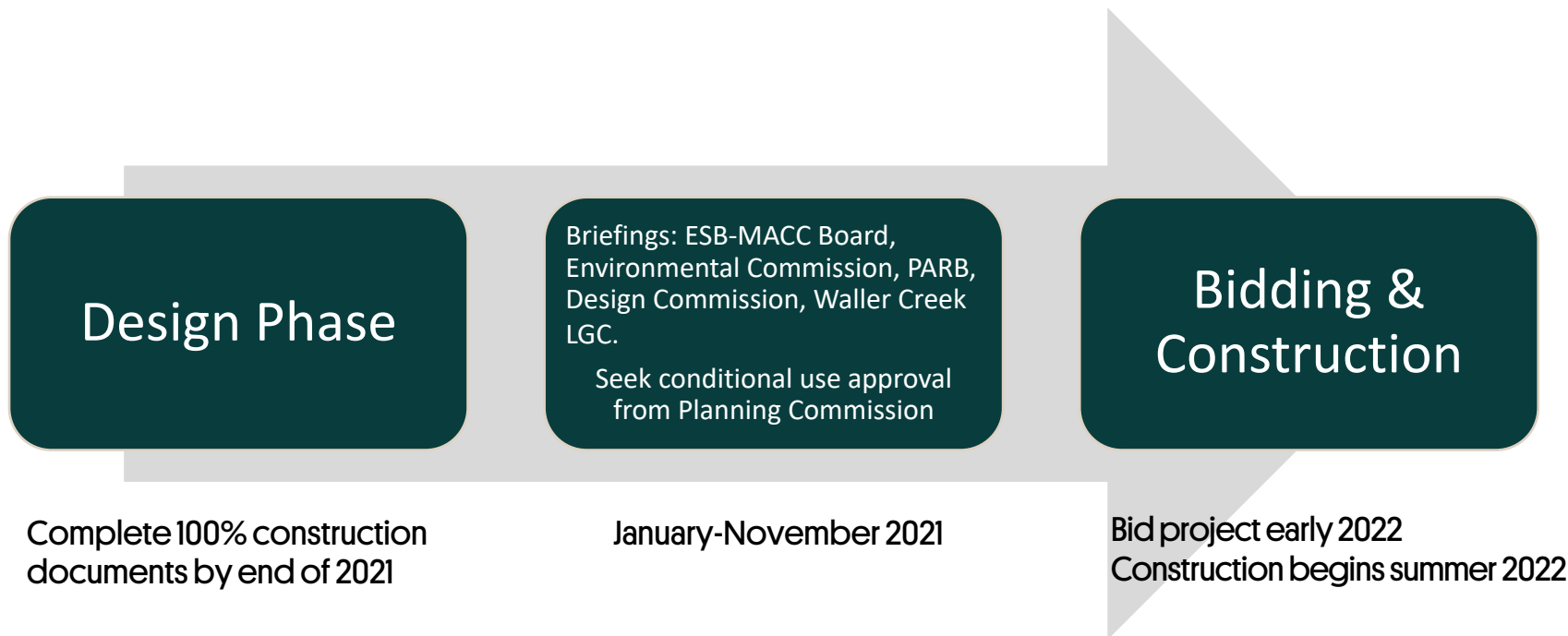

THANK YOU!

Parks & Recreation

Lana Denkeler: lane.denkeler@austintexas.gov

Watershed Protection

Diana Wang: diana.wang@austintexas.gov
[512] 974-7168

Waterloo Greenway

Melissa Ayala: mayala@waterloogreenway.org
Chris Perkes: cperkes@waterloogreenway.org

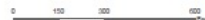

Waller Creek from 4th St to the Colorado River
Austin, Travis County, Texas

30174001.05 | 09.04.2019 | VGInc.com

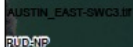

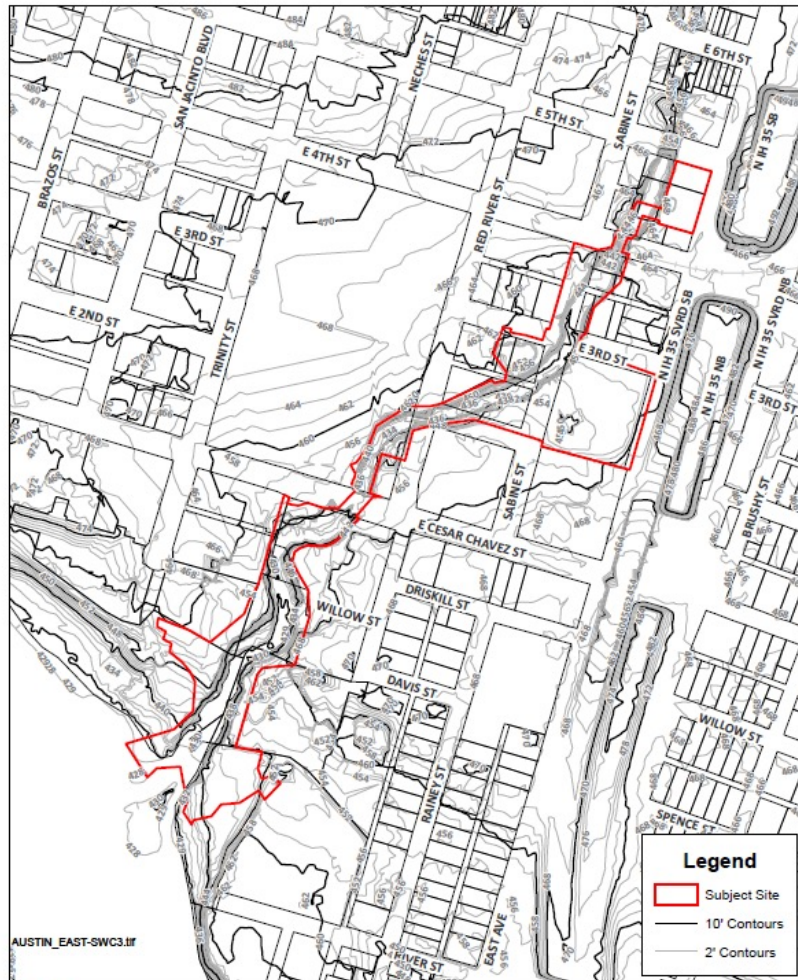

Waller Creek from 4th St to the Colorado River
Austin, Travis County, Texas

☐ Subject Site



Legend

-  Subject Site
-  10' Contours
-  2' Contours