



City of Austin

Housing and Planning Department

P.O. Box 1088, Austin, TX 78767 -1088

(512) 974-3100 ♦ Fax (512) 974-3112 ♦ www.cityofaustin.org/housing

MEMORANDUM

TO: Todd W. Shaw, Chair &
Planning Commission Members

FROM: Maureen Meredith, Senior Planner, Inclusive Planning Division
Heather Chaffin, Senior Planner, Current Planning Division
Housing and Planning Department

DATE: February 28, 2022

RE: **NPA-2020-0015.02.SH**_2011 & 2015 E M Franklin Ave
C14-2022-0008.SH_2011 & 2015 E M Franklin Ave

Staff requests a postponement of the above-referenced cases from the March 8, 2022 Planning Commission hearing to the **March 22, 2022 hearing** date to reduce the case number of discussion cases on the March 8, 2022 agenda.

This postponement request was made in a timely manner and meets the Planning Commission's policy.

Attachments: Plan Amendment Map
Zoning Map

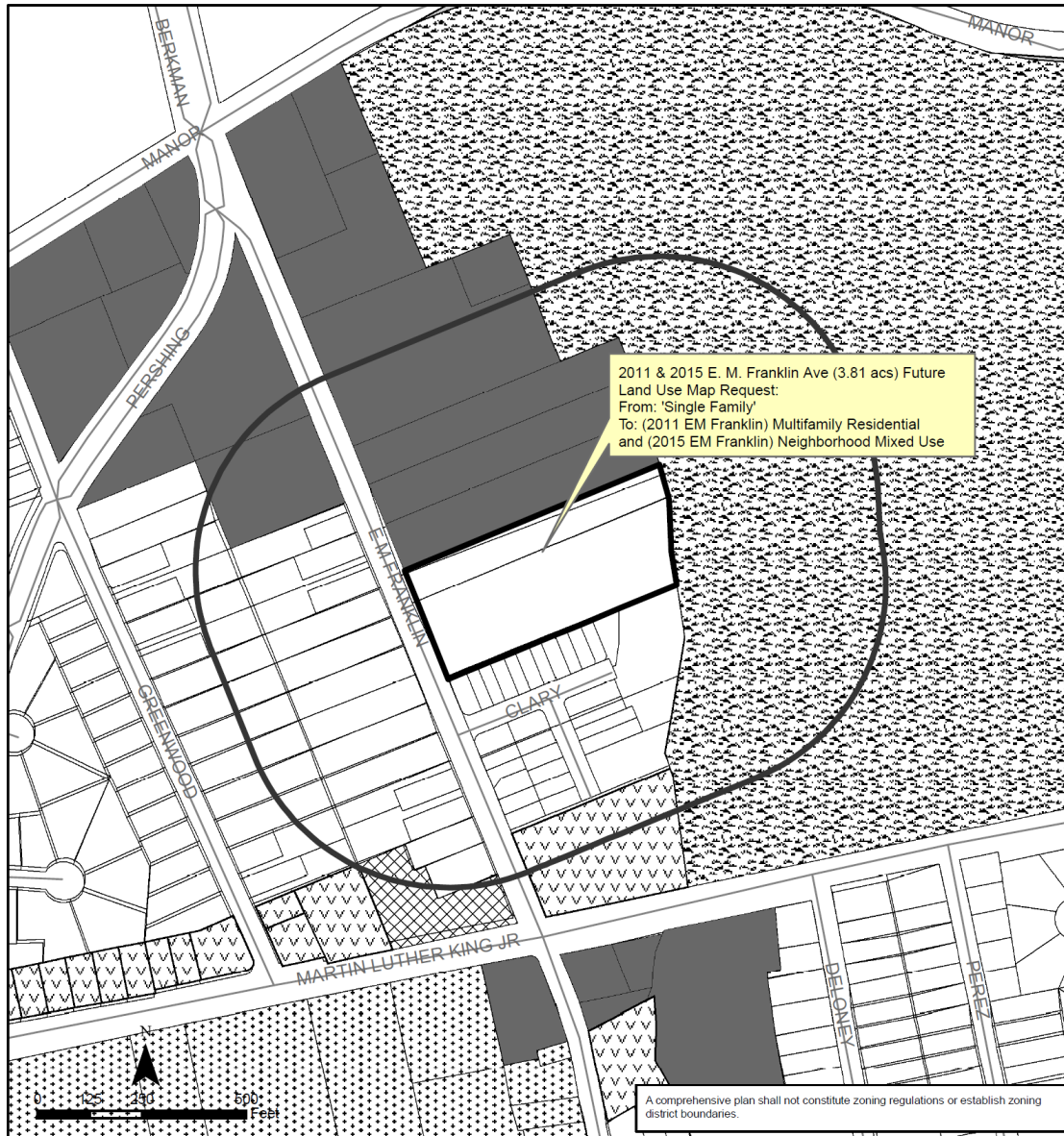

E MLK Combined (MLK) Neighborhood Planning Area NPA-2020-0015.02.SH

This product is for informational purposes and may not have been prepared for or be suitable for legal, engineering, or surveying purposes. It does not represent an on-the-ground survey and represents only the approximate relative location of property boundaries.

This product has been produced by the Planning and Zoning Department for the sole purpose of geographic reference. No warranty is made by the City of Austin regarding specific accuracy or completeness.



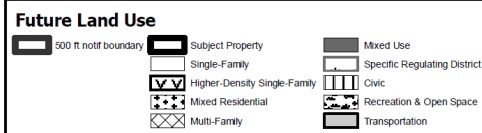

City of Austin
Planning and Zoning Department
Created on 8/6/2020, by: meredithm

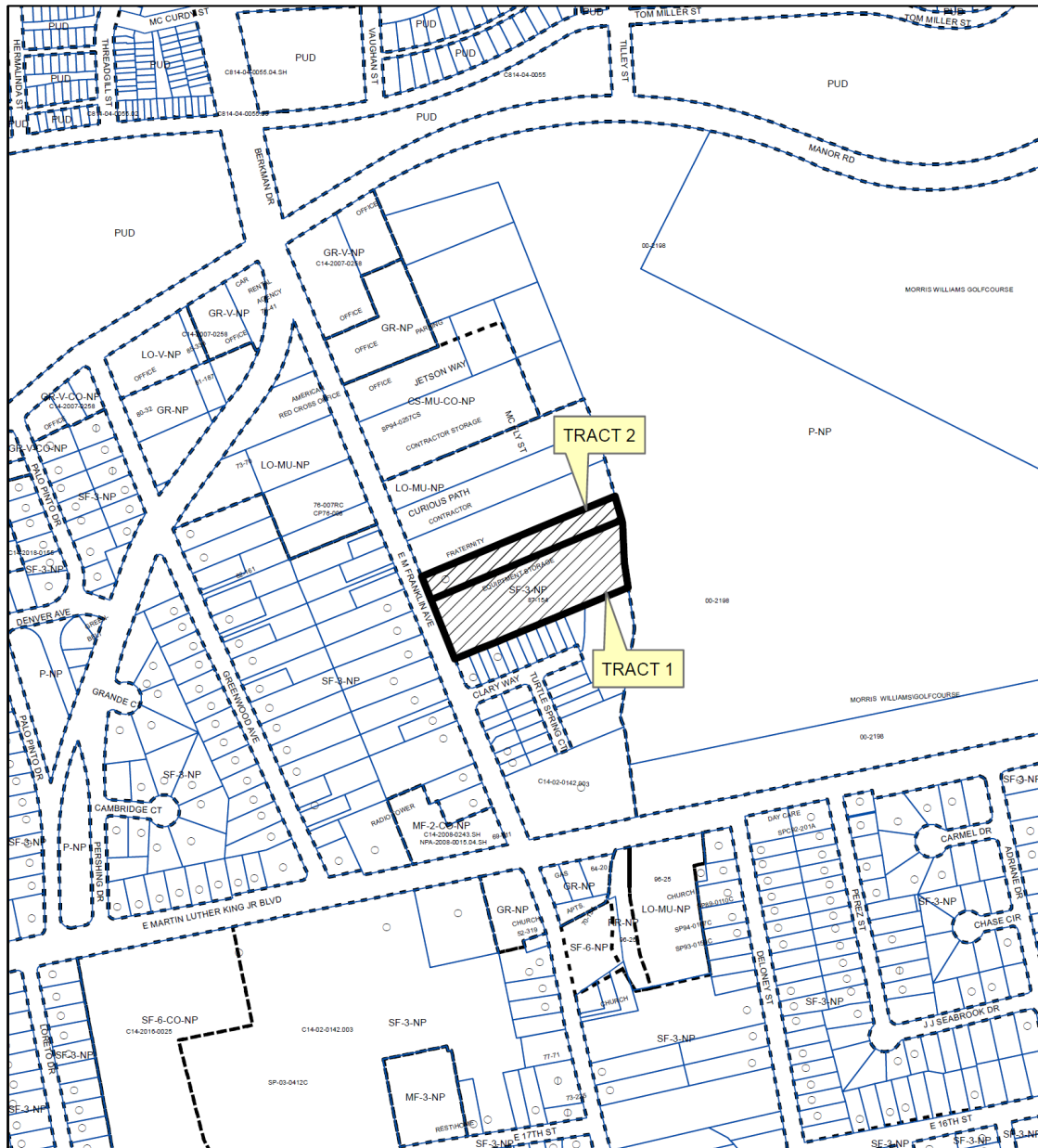



1" = 400'

-  SUBJECT TRACT
-  PENDING CASE
-  ZONING BOUNDARY

ZONING

ZONING CASE#: C14-2022-0008.SH

This product is for informational purposes and may not have been prepared for or be suitable for legal, engineering, or surveying purposes. It does not represent an on-the-ground survey and represents only the approximate relative location of property boundaries.

This product has been produced by the Housing and Planning Department for the sole purpose of geographic reference. No warranty is made by the City of Austin regarding specific accuracy or



Created: 1/20/2022