

# Redevelopment Projects: Chalmers Courts and Rosewood Courts

*Housing Authority of the City of Austin*

May 10, 2022







# PATHWAYS AT CHALMERS COURTS MASTER PLAN



Three phases totaling  
398 units.

Anticipated  
Completion: 2023





# PATHWAYS AT CHALMERS SOUTH

*Phase 1: DONE!*



86 units





# PATHWAYS AT CHALMERS EAST

*Phase 2: DONE!*



156 units







# PATHWAYS AT CHALMERS EAST





# PATHWAYS AT CHALMERS EAST

*CommUnity Care Clinic – Medical & Dental Services*







# PATHWAYS AT CHALMERS EAST

*CommUnity Care Clinic April 4<sup>th</sup> Groundbreaking*







# PATHWAYS AT CHALMERS WEST

*Phase 3: Anticipated Completion Spring 2021*



156 units



\*Subject to change



# PATHWAYS AT CHALMERS COURTS

## *Unit Breakdown*

Bedroom Type	Chalmers South	Chalmers East	Chalmers West	TOTAL	% of Total
1 BR	44	78	75	197	49%
2 BR	32	53	49	134	34%
3 BR	6	17	20	43	11%
4 BR	4	8	12	24	6%
Total	86	156	156	398	





# PATHWAYS AT CHALMERS COURTS

## *Affordability Breakdown*

% of AMI	Chalmers South	Chalmers East	Chalmers West	Total
30%	0	14	14	28
50%	0	54	56	110
60%	86	67	70	223
Market	0	21	16	37



# PATHWAYS AT ROSEWOOD COURTS

## *Site Plan*







# PATHWAYS AT ROSEWOOD COURTS

*New Construction & Historic District*







# PATHWAYS AT ROSEWOOD COURTS

*Welcome Center & Commemorative Park*



**VISITORS CENTER +/- 1,400 SF**

Entry to Park / Entry to History/ Exhibit / Gallery / Venue

**COMMEMORATIVE PARK ~.75 ACRE**

Heritage Trees/Walking Trails/Open to Community/  
Special Events





# PATHWAYS AT ROSEWOOD COURTS

## *Prospect Heights Site Plan*

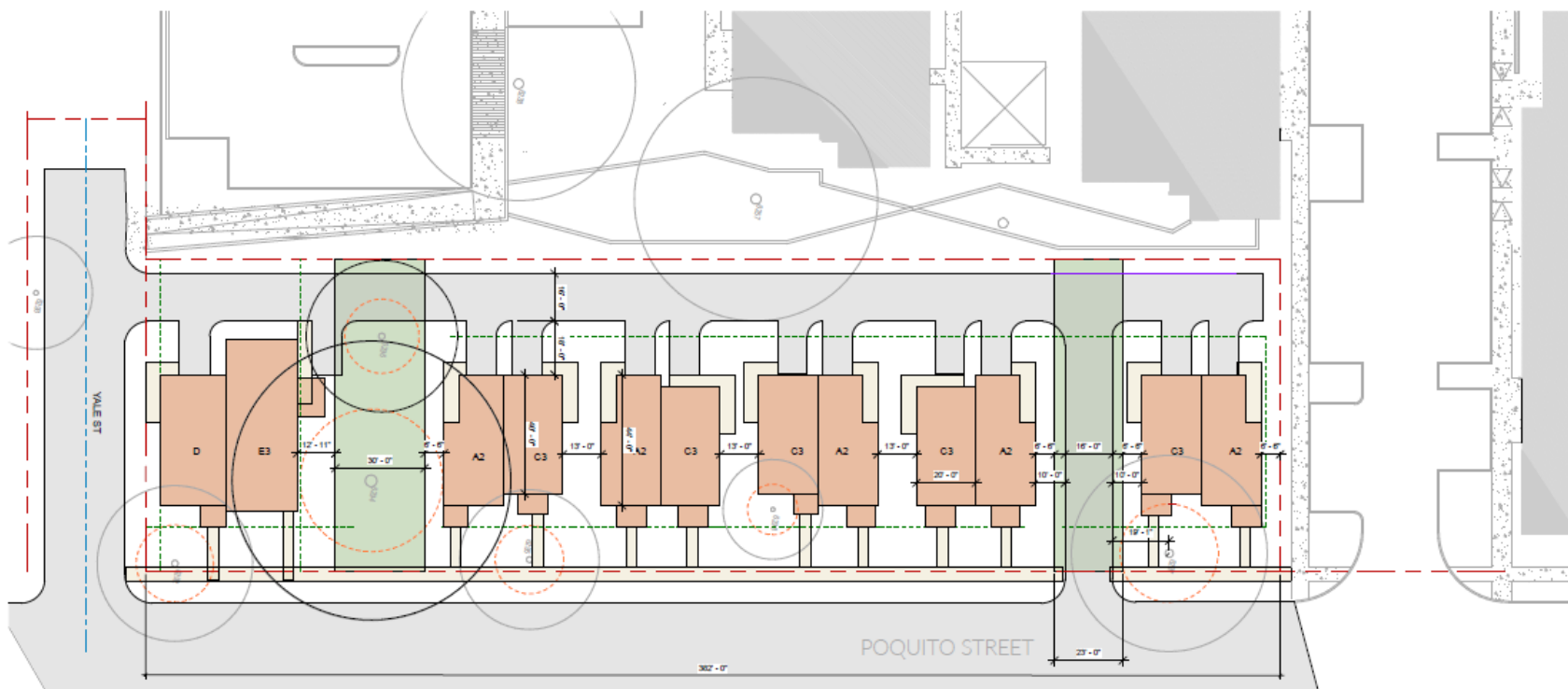



# PATHWAYS AT ROSEWOOD COURTS

## *Milestones*

### TENTATIVE TIMELINE

**March 2022** – Temporary resident relocation began; still underway

**Fall 2022** – Closing. Multifamily construction begins.

**Fall of 2024** – Multifamily Construction Complete. Residents Return!



Timeline Subject to Change



