

Easements Proposed for Acquisition
Located at 4214 N Capital of Texas Hwy SB

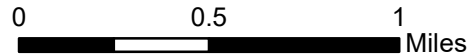

- Proposed Water and Wastewater Line Easement
- Proposed Temporary Work Space Easement
- Proposed Temporary Ingress and Egress Easement
- Property of Interest
- City Council Districts

Nearmap US Vertical Imagery by ESRI

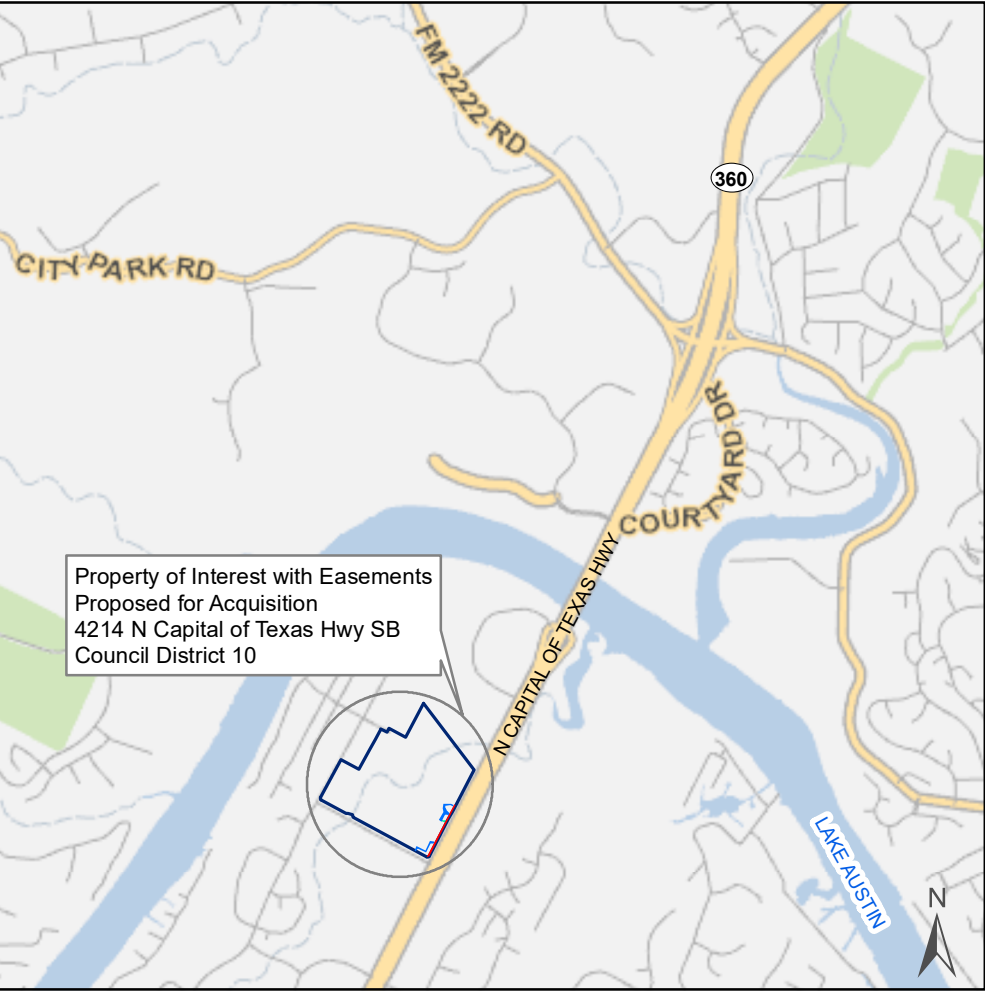

- Key to Proposed Easements
- WWL - Water and Wastewater Line Easement
0.468 Acre (20,386 Square Feet)
- WS - Temporary Work Space Easement
0.024 Acre (1,055 Square Feet)
- I & E - Temporary Ingress and Egress Easement
#1 - 0.225 Acre (9,786 Square Feet)
#2 - 0.346 Acre (15,068 Square Feet)
Total - 0.571 Acre (24,854 Square Feet)

This product is for informational purposes and may not have been prepared for or be suitable for legal, engineering, or surveying purposes. It does not represent an on-the-ground survey and represents only the approximate relative location of property boundaries.

This product has been produced by the Financial Services Department for the sole purpose of geographic reference. No warranty is made by the City of Austin regarding specific accuracy or completeness.

Produced by M McDonald, 7/7/2022
File Number 5239.04

