

ORDINANCE NO. _____

AN ORDINANCE REZONING AND CHANGING THE ZONING MAP FOR THE PROPERTY LOCATED AT 3112 CASEYBRIDGE COURT IN THE SOUTHEAST AUSTIN COMBINED NEIGHBORHOOD PLAN AREA FROM GENERAL COMMERCIAL SERVICES-MIXED USE-CONDITIONAL OVERLAY-NEIGHBORHOOD PLAN (CS-MU-CO-NP) COMBINING DISTRICT TO GENERAL COMMERCIAL SERVICES-MIXED USE-VERTICAL MIXED USE BUILDING-CONDITIONAL OVERLAY-NEIGHBORHOOD PLAN (CS-MU-V-CO-NP) COMBINING DISTRICT.

BE IT ORDAINED BY THE CITY COUNCIL OF THE CITY OF AUSTIN:

PART 1. The zoning map established by Section 25-2-191 of the City Code is amended to change the base district from general commercial services-mixed use-conditional overlay-neighborhood plan (CS-MU-CO-NP) combining district to general commercial services-mixed use-vertical mixed use building-conditional overlay-neighborhood plan (CS-MU-V-CO-NP) combining district on the property described in Zoning Case No. C14-2022-0059, on file at the Housing and Planning Department, as follows:

Lot 1, AMENDED PLAT OF AIRPORT GATEWAY SUBDIVISION, a subdivision in Travis County, Texas, according to the map or plat thereof, recorded in Document No. 201400187, Plat Records of Travis County, Texas (the "Property"),

locally known as 3112 Caseybridge Court in the City of Austin, Travis County, Texas, generally identified in the map attached as **Exhibit "A"**.

PART 2. The Property within the boundaries of the conditional overlay combining district established by this ordinance is subject to the following conditions:

The following uses are prohibited uses on the Property:

Adult Oriented Businesses
Vehicle Storage

Convenience Storage

PART 3. Except as specifically restricted under this ordinance, the Property may be developed and used in accordance with the regulations established for the general commercial services (CS) base district, mixed use (MU) combining district, and other applicable requirements of the City Code.

PART 4. Except as specifically modified by this ordinance, the Property is subject to Ordinance No. 021010-12c that established zoning for the Southeast Neighborhood Plan.

PART 5. This ordinance takes effect on _____, 2022.

PASSED AND APPROVED



_____, 2022

§
§
§

Steve Adler
Mayor

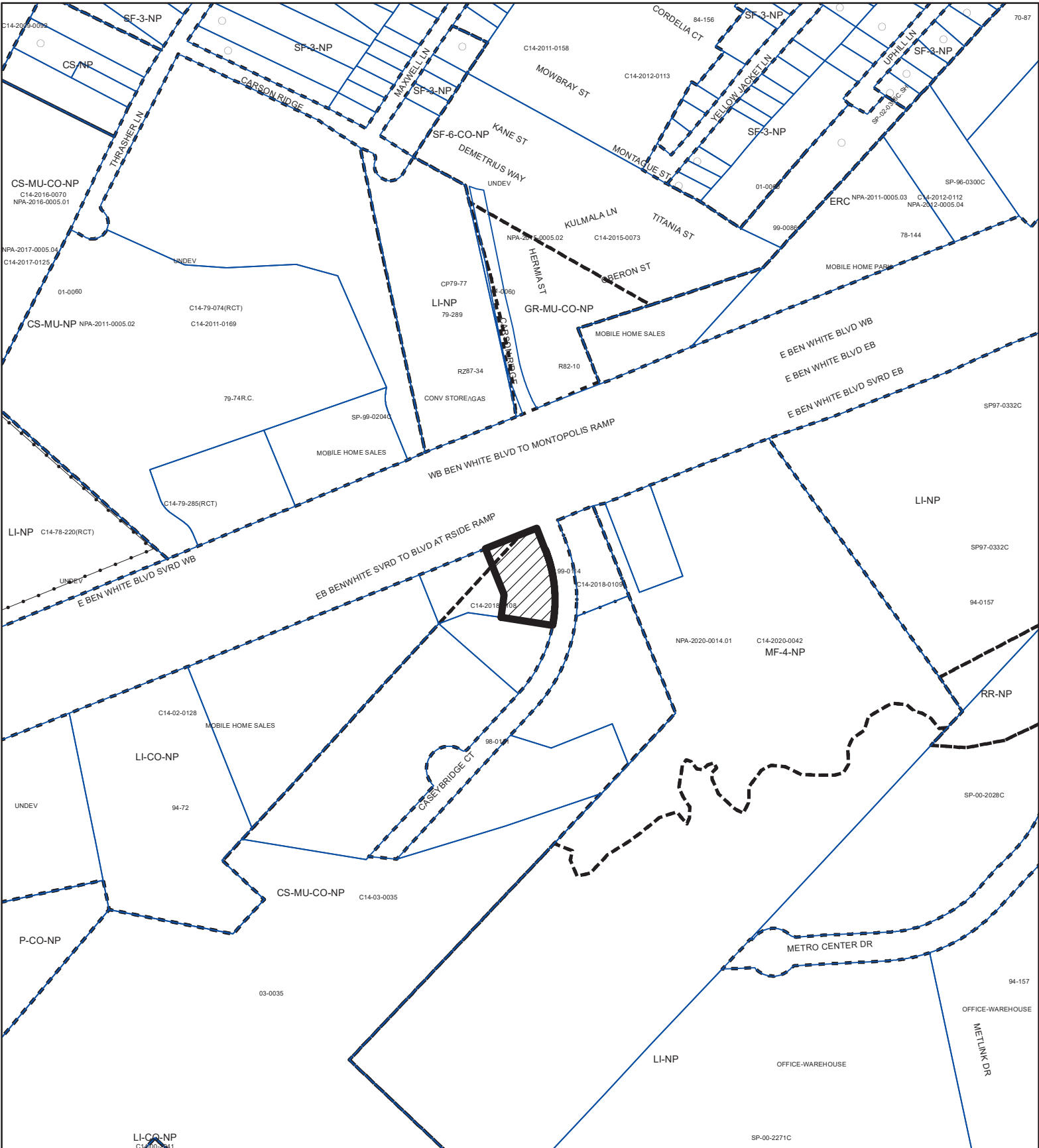
APPROVED: _____ **ATTEST:** _____
Anne L. Morgan Myrna Rios
City Attorney City Clerk



-  SUBJECT TRACT
-  PENDING CASE
-  ZONING BOUNDARY

1" = 400'

ZONING

ZONING CASE#: C14-2022-0059

Exhibit A

This product is for informational purposes and may not have been prepared for or be suitable for legal, engineering, or surveying purposes. It does not represent an on-the-ground survey and represents only the approximate relative location of property boundaries.

This product has been produced by the Housing and Planning Department for the sole purpose of geographic reference. No warranty is made by the City of Austin regarding specific accuracy or



Created: 5/11/2022