

305 S. CONGRESS PUD

Conceptual Open Space Map

EXHIBIT G

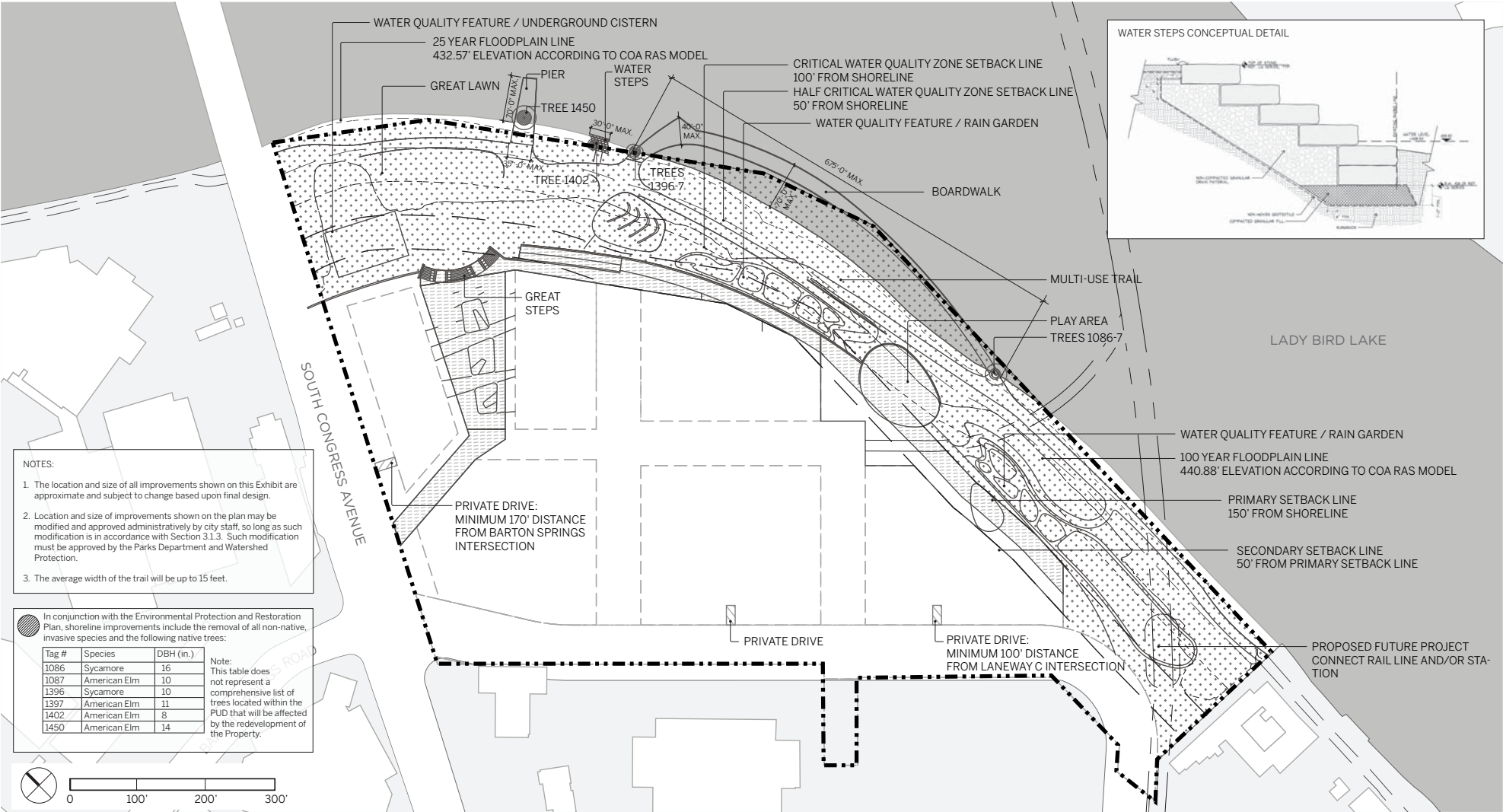

- Site Boundary (821,517 sf/18.86 acre)
- Park Land (284,447 sf/6.53 acre, which includes the inundated land.) *PARKLAND AREA IS SUBJECT TO CHANGE BASED ON FINAL LOCATION AND DESIGN OF CAPMETRO STATION
- Plaza/Landscape Area (69,233 sf/1.59 acre)

CASE NUMBER: C814-89-0003.02

DEFINITIONS:

1. "Amnitized Water Quality Ponds" are drainage and water quality infrastructure designed to function as a filter for storm water runoff through a layer of natural materials before being discharged to the lake. Functionally used to capture pollutants and characteristically have an aesthetically pleasing configuration of native plants, rock configurations, water features, and other natural qualities that may enhance function, and accompanied by education signage. Amnitized Water Quality Ponds cannot be designed as sedimentation/filtration ponds.
2. "Great Lawn" is an open field lawn, 0.5 to 1.5 acres, which allows for people to gather and observe bats, and which also allows for a variety of recreational activities, open field play and enjoyment of the scenery, respectful of the bat population and their habitat.
3. "Great Steps" are terraced platforms sufficient in size to allow small scale numbers of patrons to gather, sit and observe activity within the park while still accommodating individuals traversing from top to bottom, and must include ADA access.
4. "Pier" is a structure extending into navigable water for use as a landing place or promenade for viewing the lake.
5. "Water Steps" are platforms sufficient in size to allow small scale numbers of patrons to immerse feet into water and observe activity within the park and on the lake.

Submitted: July 24, 2019
Updated: June 26, 2020
Updated: October 12, 2020
Updated: April 14, 2021
Updated: July 9, 2022
Updated: December 7, 2022
Updated: January 31, 2022
Updated: April 6, 2022
Updated: June 1, 2022

305 S. Congress Avenue Conceptual Phasing Plan

EXHIBIT H

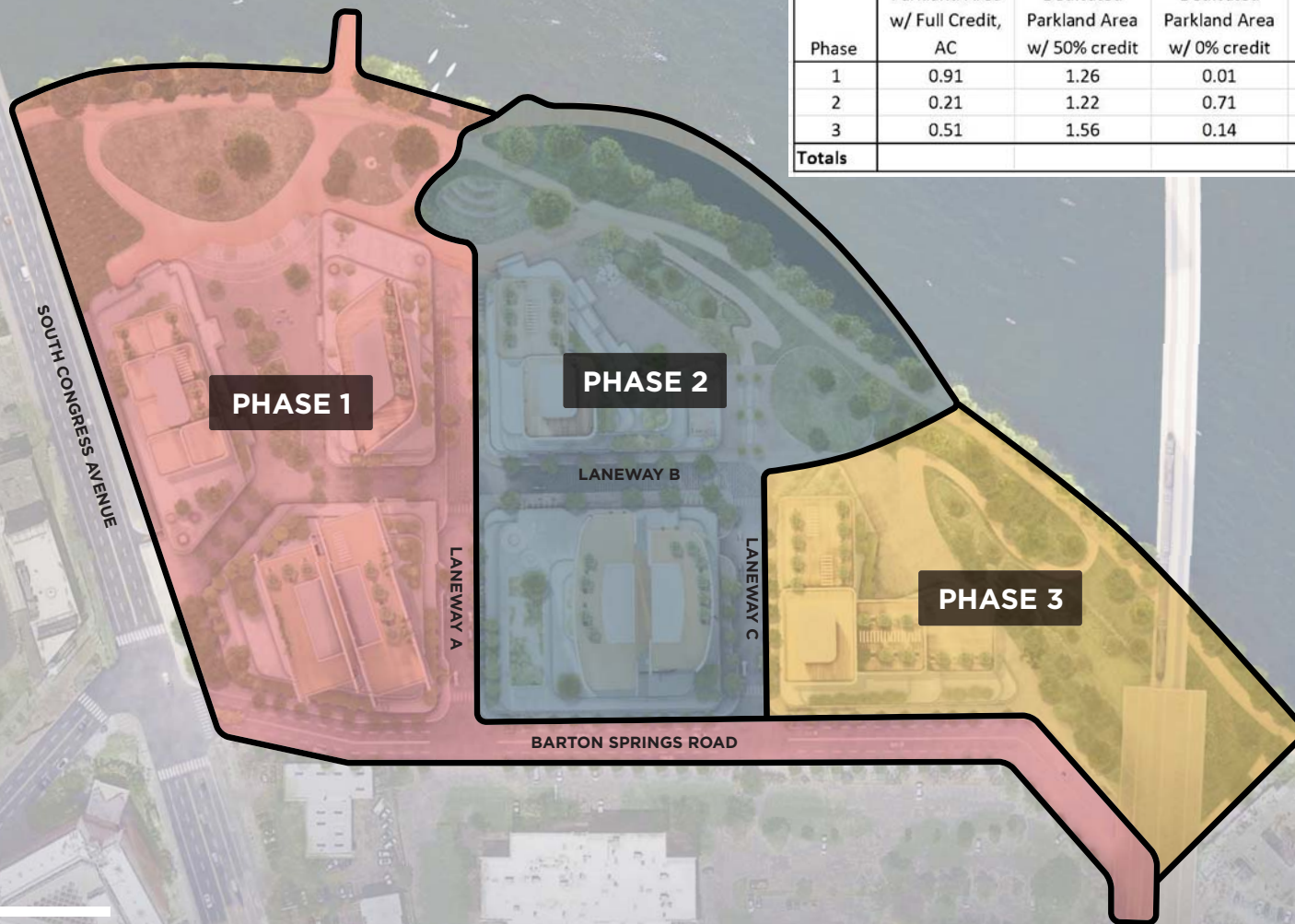

Parkland Dedication By Phase					
Phase	DEDICATED PARKLAND				EASEMENT
	Dedicated Parkland Area w/ Full Credit, AC	Dedicated Parkland Area w/ 50% credit	Dedicated Parkland Area w/ 0% credit	Total Deeded Parkland (by Phase)	Easement (w/50% Credit) by Phase
1	0.91	1.26	0.01	2.18	0.85
2	0.21	1.22	0.71	2.15	0.49
3	0.51	1.56	0.14	2.21	0.25
Totals				6.532	1.59