

RIGHT-OF-WAY VACATION OF CORNELL STREET

DESCRIBING A TRACT OF LAND LOCALLY KNOWN AS CORNELL STREET (NO RECORDING INFORMATION FOUND) CONTAINING 0.75 OF AN ACRE (32,508 SQUARE FEET) IN THE CITY OF AUSTIN, TRAVIS COUNTY, TEXAS, BEING A PORTION OF OUTLOT 62, DIVISION "B", OF THE TOPOGRAPHICAL MAP OF THE GOVERNMENT TRACT ADJOINING THE CITY OF AUSTIN, DATED 1840, OF RECORD IN THE GENERAL LAND OFFICE OF THE STATE OF TEXAS, SAID 0.75 OF AN ACRE (32,508 SQUARE FEET) TRACT BEING FURTHER DESCRIBED AS BEING A PORTION OF THAT CERTAIN TRACT OF LAND DESCRIBED AS 2ND TRACT IN A DEED TO THE HOUSING AUTHORITY OF THE CITY OF AUSTIN BY DEED RECORDED IN VOLUME 593, PAGE 467 OF THE DEED RECORDS OF SAID COUNTY AND STATE, AND BEING A PORTION OF LOTS 5 THROUGH 8 (INCLUSIVE) OF THE W.D. HART SUBDIVISION, A SUBDIVISION RECORDED IN BOOK 2, PAGE 147 OF THE PLAT RECORDS OF SAID COUNTY AND STATE AND BEING ALL OF THE ALLEY ADJOINING SAID LOTS 5 THROUGH 8 (INCLUSIVE) VACATED BY THE CITY COUNCIL OF THE CITY OF AUSTIN, TRAVIS COUNTY, TEXAS AS RECORDED IN VOLUME 602, PAGE 106, DEED RECORDS OF SAID COUNTY AND STATE, SAID 0.75 OF AN ACRE (32,508 SQUARE FEET) TRACT OF LAND BEING MORE PARTICULARLY DESCRIBED BY METES AND BOUNDS AS FOLLOW:

BEGINNING, at a ½" iron rod with plastic cap (Dunaway Assoc. LP) set in the northwest line of said 2nd Tract, same being the southeast right-of-way line of Chicon Street (60' R.O.W.), from which a ½" iron rod with plastic cap (Dunaway Assoc. LP) set at the southwest corner of said 2nd Tract, same being the northwest corner of Lot 1, Block A, College Heights Annex Austin, Texas, a subdivision recorded in Book 3, Page 51, Plat Records of said County and State, bears S20°26'54"W, 149.73 feet;

THENCE, with the northwest line of said 2nd Tract, same being the southeast line of said Chicon Street, N20°26'54"E, 59.09 feet to a ½" iron rod with plastic cap (Dunaway Assoc. LP) set;

THENCE, through the interior of said 2nd Tract, and through the interior of said Lot 5 and Lot 6, N78°14'54"E 634.42 feet to a ½" iron rod with plastic cap (Dunaway Assoc. LP) set in the east line of said Lot 6, same being the west right-of-way line of Poquito Street (50' R.O.W.);

EXHIBIT "A"
Dunaway/UDG #4945
F.N. #1635
Page 2 of 3

City of Austin to
The Housing Authority
of the City of Austin
Cornell Street

THENCE, with the east line of said Lot 6, said alley and said Lot 8, same being the west line of said Poquito Street, S11°45'06"E, 50.00 feet to a ½" iron rod with plastic cap (Dunaway Assoc. LP) set, from which a ½" iron rod with plastic cap (Dunaway Assoc. LP) set at the southeast corner of said Lot 8, same being in the north right-of-way line of Yale Street (40' R.O.W.), bear S11°45'06"E, 130.00 feet;

THENCE, through the interior of said Lot 7 and Lot 8, and through the interior of said 2nd Tract, S78°14'54"W, 665.91 feet to the POINT OF BEGINNING and containing 0.75 of an acre (32,508 square feet) of land.

Field Notes Prepared by:
Dunaway
5707 Southwest Parkway
Building 2, Suite 250
Austin, Texas 78735
(512) 306-8252
TBPLS 10065900





John Noell, R.P.L.S. #2433

March 2, 2022
Date

Map attached.

Basis of Bearings: Bearings shown hereon are based on the Texas State Plane Coordinate System, NAD 83 (1986 Adjustment), Texas Central Zone (4203). All bearings, distances and acreages shown hereon relate to this datum and grid coordinate system.

References: TCAD: 02 0610
Austin Grid: MK-22

FIELD NOTES REVIEWED
BY  DATE: 03/23/22
CITY OF AUSTIN
PUBLIC WORKS DEPARTMENT

TBPE No. F-1114 | TBPLS No. 10065900
5707 Southwest Parkway | Building 2, Suite 250
Austin, TX 78735
512.306.8252

LEGEND

- 1/2" IRON ROD WITH CAP
(DUNAWAY ASSOC. LP) SET

DATE:
MARCH 2, 2022

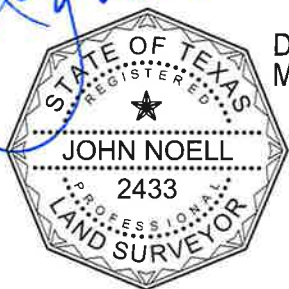

DUNAWAY
TBPLS 10065900

SCALE: 1"=100'

- POINT OF BEGINNING
0.75 OF AN ACRE
(32,508 SQUARE FEET)
FIELD NOTE #1588

THE HOUSING AUTHORITY OF THE CITY OF AUSTIN

VOL. 593 PG. 467
2ND. TRACT

ALLEY VACATED
VOL. 602, PG. 106
(P.U.E. RESERVED)

CORNELL STREET (50' R.O.W.)
(NO RECORDING INFORMATION FOUND)

VOL. 593 PG. 467
2ND. TRACT

VOL. 594
PG. 25

VOL. 594 PG. 21

VOL. 594 PG. 22

VOL. 593 PG. 467
1ST. TRACT

VOL. 594
PG. 272
1ST. TRACT

LOT 2

LOT 1

SUB DIVISION
PAGE 147

LOT 3

LOT 4

HART 2
BOOK
LOT 5

OT

LOT 6

LOT 7

LOT 8

POQUITO STREET (50' R.O.W.)

YALE STREET
(40' R.O.W.)

BLK. A

COLLEGE HEIGHTS ANNEX AUSTIN, TEXAS

BLK. B2