



APPROACH | NPS

SECRETARY OF INTERIOR'S STANDARDS
HISTORIC BUILDINGS NEW ADDITIONS

"Placing functions and services required for the new use in non-character-defining interior spaces rather than installing a new addition."

Constructing a new addition so that there is the least possible loss of historic materials and so that character-defining features are not obscured, damaged, or destroyed.

Locating the attached exterior addition at the rear or on an inconspicuous side of a historic building; and limiting its size and scale in relationship to the historic building.

Designing new additions in a manner that makes clear what is historic and what is new."

PRECEDENTS

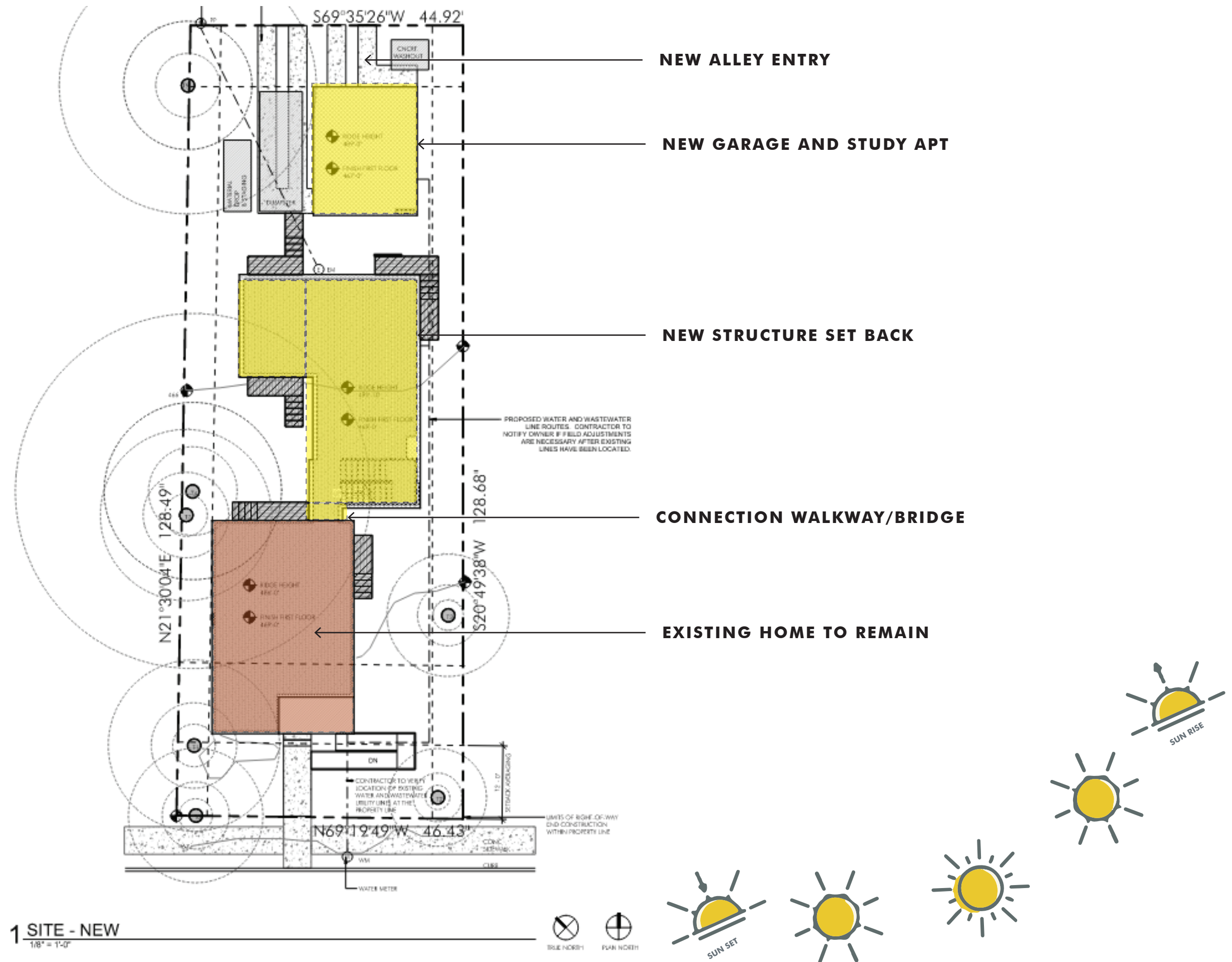

1 SITE - NEW
1/8" = 1'-0"

SITE STUDY



EXISTING PHOTOS



NEW STRUCTURE SET BACK; CLADDING IN WHITE STACK BOND BRICK.

EXISTING HOUSE TO REMAIN. PATCH AND MATCH ANY NEW OPENINGS TO MATCH EXISTING SIDING.

EXISTING PHOTOS



NEW STRUCTURE SET BACK; CLADDING IN WHITE STACK BOND BRICK.

NEW STRUCTURE SET BACK; CLADDING IN WOOD SIDING. FENESTRATION IN BLACK FRAMES.

NEW STRUCTURE SET BACK; CLADDING IN STUCCO. FENESTRATION IN BLACK FRAMES.

EXISTING HOUSE TO REMAIN. PATCH AND MATCH ANY NEW OPENINGS TO MATCH EXITNG SIDING.

NEW STRUCTURE SET BACK; CLADDING IN WHITE STACK BOND BRICK.

EXISTING PHOTOS