



City of Austin

1 of 2

Housing and Planning Department

P.O. Box 1088, Austin, TX 78767 -1088

(512) 974-3100 ♦ Fax (512) 974-3112 ♦ www.cityofaustin.org/housing

MEMORANDUM

TO: Todd W. Shaw, Chair &
Planning Commission Members

FROM: Maureen Meredith, Senior Planner, Inclusive Planning Division
Housing and Planning Department

DATE: December 8, 2022

RE: NPA-2022-0017.01_Crestview Village
6916, 6926, 6928 N. Lamar Blvd and 808, 810, 812, 906 Justin Ln
Crestview/Wooten Combined Neighborhood Planning Area

Staff requests a postponement of the above-referenced case from the **December 20, 2022** Planning Commission hearing to the **February 14, 2022 hearing date** to allow staff additional time to review the application.

The postponement request was made in a timely manner and meets the Planning Commission's policy.

Attachment: Plan Amendment Map

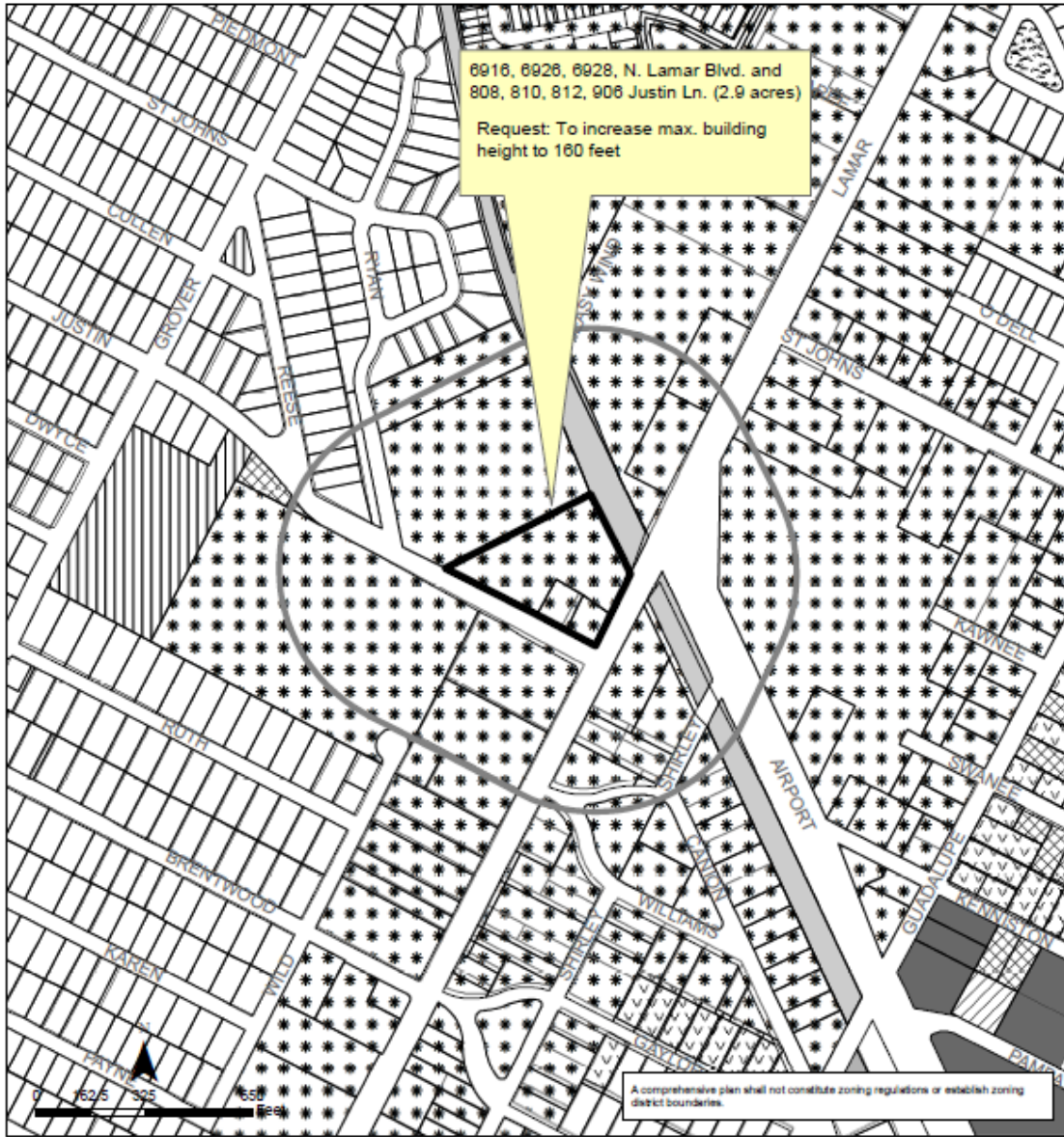

**Crestview/Wooten Combined (Crestview) Neighborhood Planning Area
NPA-2022-0017.01**

This product is for informational purposes and may not have been prepared for or be suitable for legal, engineering, or surveying purposes. It does not represent an on-the-ground survey and represents only the approximate relative location of property boundaries.

This product has been produced by the Housing and Planning Department for the sole purpose of geographic reference. No warranty is made by the City of Austin regarding specific accuracy or completeness.



City of Austin
Housing and Planning Department
Created on 3/1/2022, by: MeeksS

Future Land Use	
Subject Tract	Mixed Use/Office
500 ft. notif. boundary	Multi-Family
CMc	Recreation & Open Space
Commercial	Single-Family
Higher-Density Single-Family	Specific Regulating District
Mixed Use	Transportation