

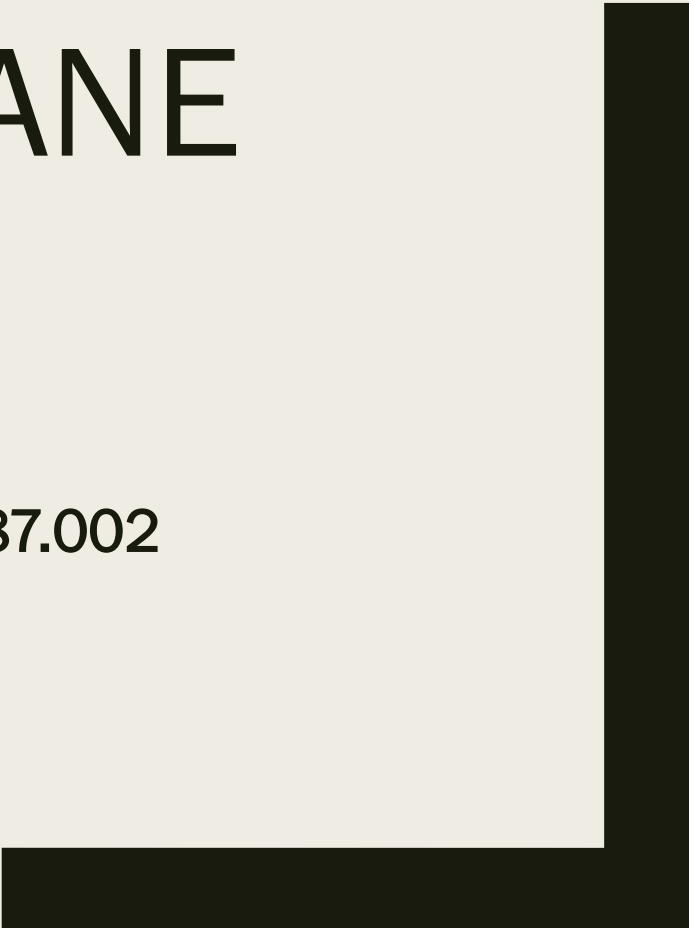

EAST BRAKER LANE EXTENSION

Public Works Department - CIP ID # 7487.002

Presentation to
Austin City Council



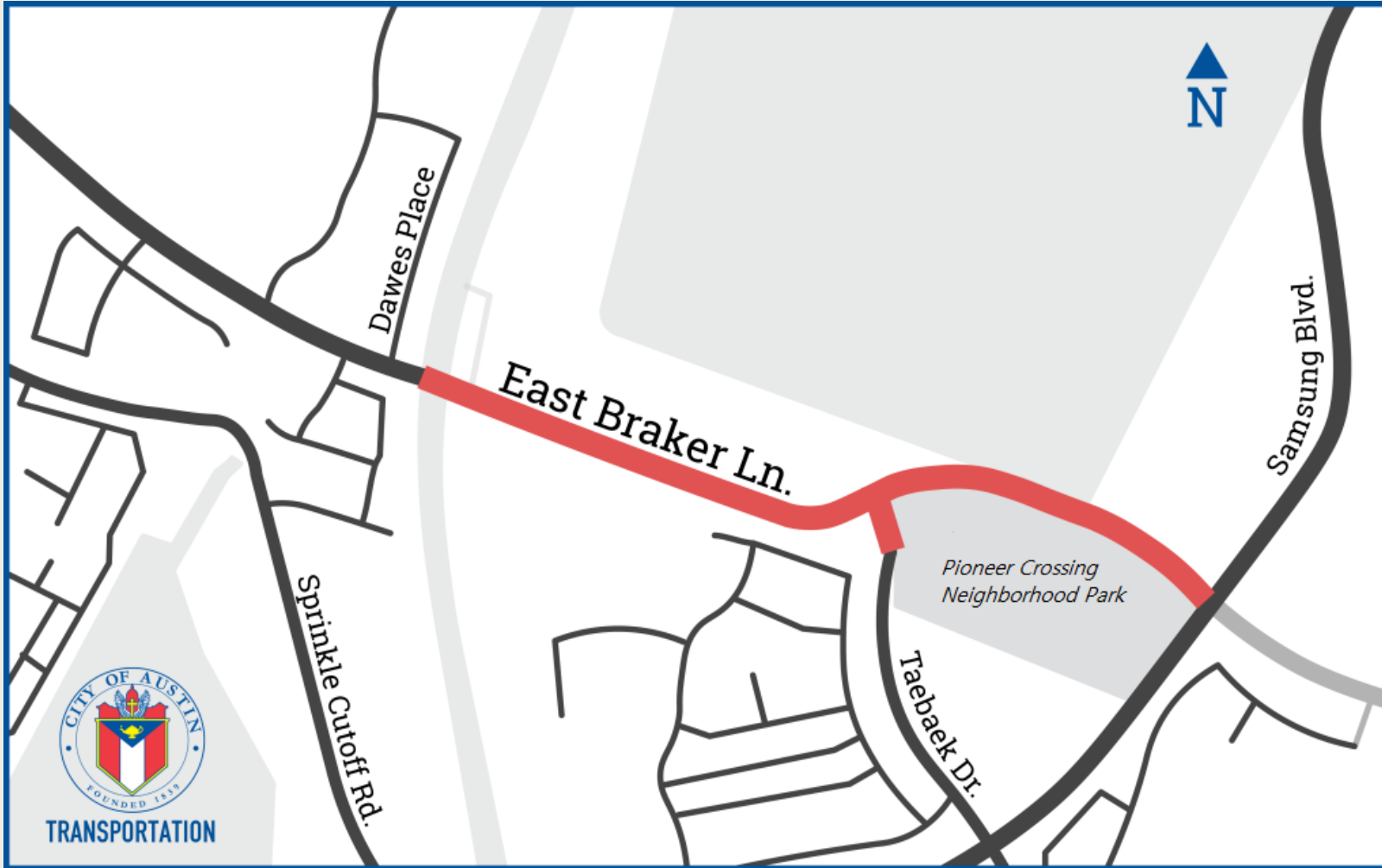

Introduction

- The City is extending East Braker Ln from its current terminus at Dawes Place to Samsung Blvd as well as extending Taebaek Drive to connect with the Braker extension. This project is expected to reduce traffic on Parmer Ln and add significant connectivity for the Pioneer Crossing East and West neighborhoods. The extension will connect to future Safe Routes to School improvements.
- Public Works Department (PWD) requests Chapter 26 Parkland Acquisition and a change in use approval from Austin City Council for the addition of two permanent drainage easements. These easements are necessary to complete the roadway and connect the existing dead-end section of Braker at Dawes Place to Samsung Blvd.

Project Site Description and Proposed Improvements

- The Pioneer Crossing Neighborhood Park is currently undeveloped with surface water runoff to the west, towards the future Taebaek Dr. extension and existing stormwater improvements installed as part of the Pioneer Crossing East neighborhood development.
- Extension of Taebaek Dr. will include a culvert from the east side of the road to a stormwater facility constructed as part of the Braker Ln extension project. This culvert will be constructed in the Taebaek ROW, grading will be required along Taebaek, in the Park property to direct water to the culvert.
- Drainage grading along the Braker Ln ROW will also be required to direct surface flows from the park.

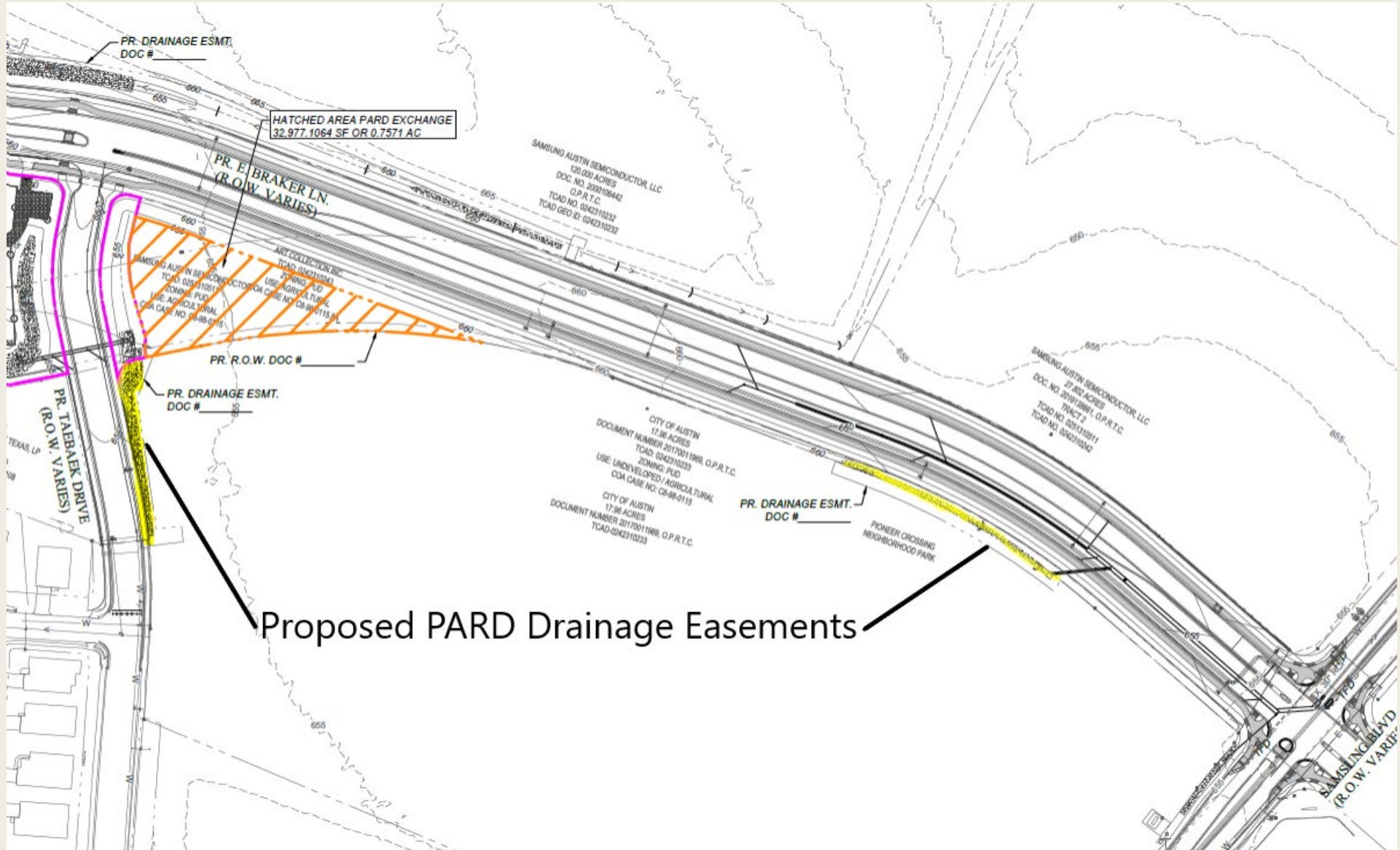

Parkland Mitigation Summary:

- Permanent Use (Drainage): 9,548 sq. ft. = \$76,882
- Total Mitigation Amount = \$76,882

Request and timeline:

- Public Works Department requests City Council approval for the Permanent Drainage Easements along the North and West edges of the Pioneer Crossing Neighborhood Park.
- This project is nearing 100% design and in final phases of permitting.
- Solicitation advertisement is scheduled for mid 2023.
- Construction should start fall 2023.