

ORDINANCE NO. _____

AN ORDINANCE REZONING AND CHANGING THE ZONING MAP FOR THE PROPERTY LOCATED AT 1122 COLORADO STREET, FROM CENTRAL BUSINESS DISTRICT (CBD) COMBINING DISTRICT TO CENTRAL BUSINESS DISTRICT-HISTORIC LANDMARK (CBD-H) COMBINING DISTRICT.

BE IT ORDAINED BY THE CITY COUNCIL OF THE CITY OF AUSTIN:

PART 1. The zoning map established by Section 25-2-191 of the City Code is amended to change the base district from central business (CBD) district to central business-historic landmark (CBD-H) combining district on the property described in Zoning Case No. C14H-2022-0073, on file at the Housing and Planning Department, as follows:

All of that certain parcel of land being the North 1/2 of BLOCK 135, ORIGINAL CITY OF AUSTIN, according to a map on file in the General Land Office, State of Texas, being all of LOTS 1, 2, and 3, BLOCK 135, and the North 1/2 of a vacated alley as described in a deed in Volume 2638, Page 506, Deed Records of Travis County, Texas, and as described in a deed in Volume 2638, Page 508, Deed Records of Travis, Texas,(the "Property"),

locally known as 1122 Colorado Street in the City of Austin, Travis County, Texas, generally identified in the map attached as **Exhibit "A"**.

PART 2. This ordinance takes effect on _____, 2023.

PASSED AND APPROVED

§

§

_____, 2023 § _____



Kirk Watson
Mayor

APPROVED: _____ **ATTEST:** _____

Anne L. Morgan
City Attorney

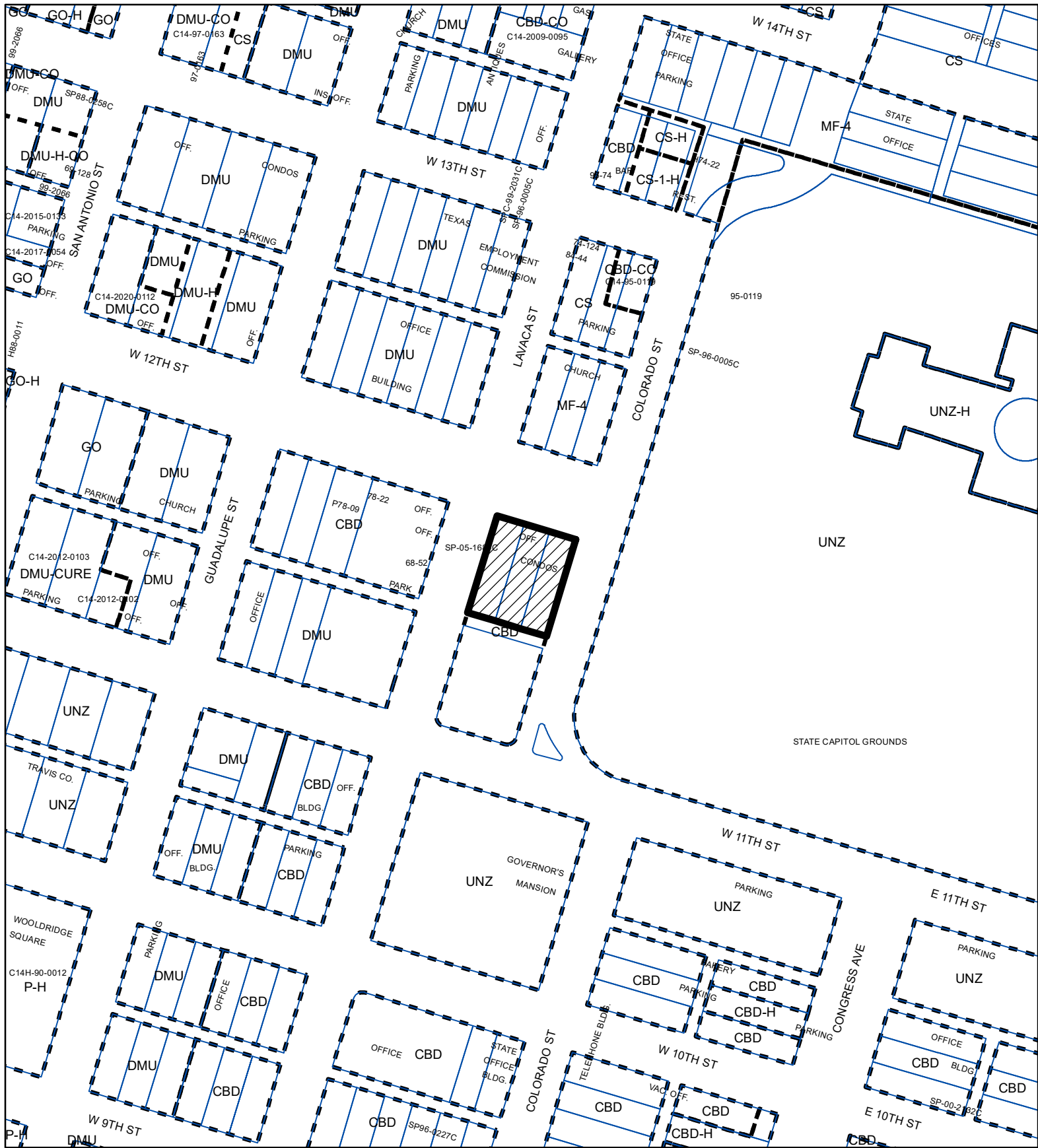
Myrna Rios
City Clerk



-  SUBJECT TRACT
-  PENDING CASE
-  ZONING BOUNDARY

HISTORIC ZONING

EXHIBIT A

ZONING CASE#: C14H-2022-0073

1" = 200'

This product is for informational purposes and may not have been prepared for or be suitable for legal, engineering, or surveying purposes. It does not represent an on-the-ground survey and represents only the approximate relative location of property boundaries.

This product has been produced by the Housing and Planning Department for the sole purpose of geographic reference. No warranty is made by the City of Austin regarding specific accuracy or

