

Reflected Ceiling Plan General Notes

- A. DO NOT SCALE THE DRAWINGS. If a specific dimension is not given, contact ARCHITECT for clarification.
- B. All dimensions are to face of finish, edge of awning, finish opening, or centerline of support. Contact ARCHITECT with any discrepancies.
- C. Contractor (GC) to field verify all existing dimensions prior to construction and/or installation of any equipment, accessories, etc.
- D. Keynotes located on this sheet are for this sheet only.
- E. Center and align all fixtures as shown. If dimension is not provided, Contact ARCHITECT.
- F. All Fire-Sprinkler heads to be compliant with ASTM, 2012 International Fire Code and City of Austin Fire Department's Codes.
- G. Fire Suppression Drawings will be a deferred submittal to City of Austin and AFD for review.
- H. Confirm all lighting fixtures with owners prior to ordering goods.

Light Fixture Schedule

Refer to sheet A2.0

EXIT	WET LISTED EXIT & EMERGENCY LIGHT
Manufacturer:	Lithonia
Product:	LHQM LED G HO SD
Color:	White
Letters:	Green
Options:	High Output Battery, Self-Diagnostic

Reflected Ceiling Plan Keynotes

- Existing patio cover above, non-combustable.
- Existing stem mounted light fixture to remain.
- New steel framed insect screen mesh enclosure. All doors and windows are self-closing.
- Fire box below, fire brick construction (Walls, floor) with steel plate door and frame.
- New Paint Grip metal roofing, unfinished.
- Steel structure, painted.
- Lensed fixture.
Provide rigid conduit and octagonal boxes, painted to match adjacent steel structure.
- New smoker flue.
- Existing downspout.
- Existing steel trellis column.

Seal



2018 April 24

MAGIC

Architecture

Magic Architecture PC
7712 Lazy Lane
Austin, TX 78757
(512) 994-5762
email: scott@scottmagic.com

Project Title

Lambert's Smoker Shed

410 W. 2nd Street, Patio
Austin, Texas 78701

Issue

2018 April 24 Permit Set

Sheet Title

Reflected Ceiling Plan

Sheet Number

A2.1



2018 April 24

M
G
I
C

Architecture

Magic Architecture PC
7712 Lazy Lane
Austin, TX 78757
(512) 994-5782
email: scott@scottmagic.com

Project Title

Lambert's Smoker Shed

410 W. 2nd Street, Patio
Austin, Texas 78701

Issue

● 2018 April 24 Permit Set

Sheet Title

Proposed Elevation - North

Sheet Number

A3.0

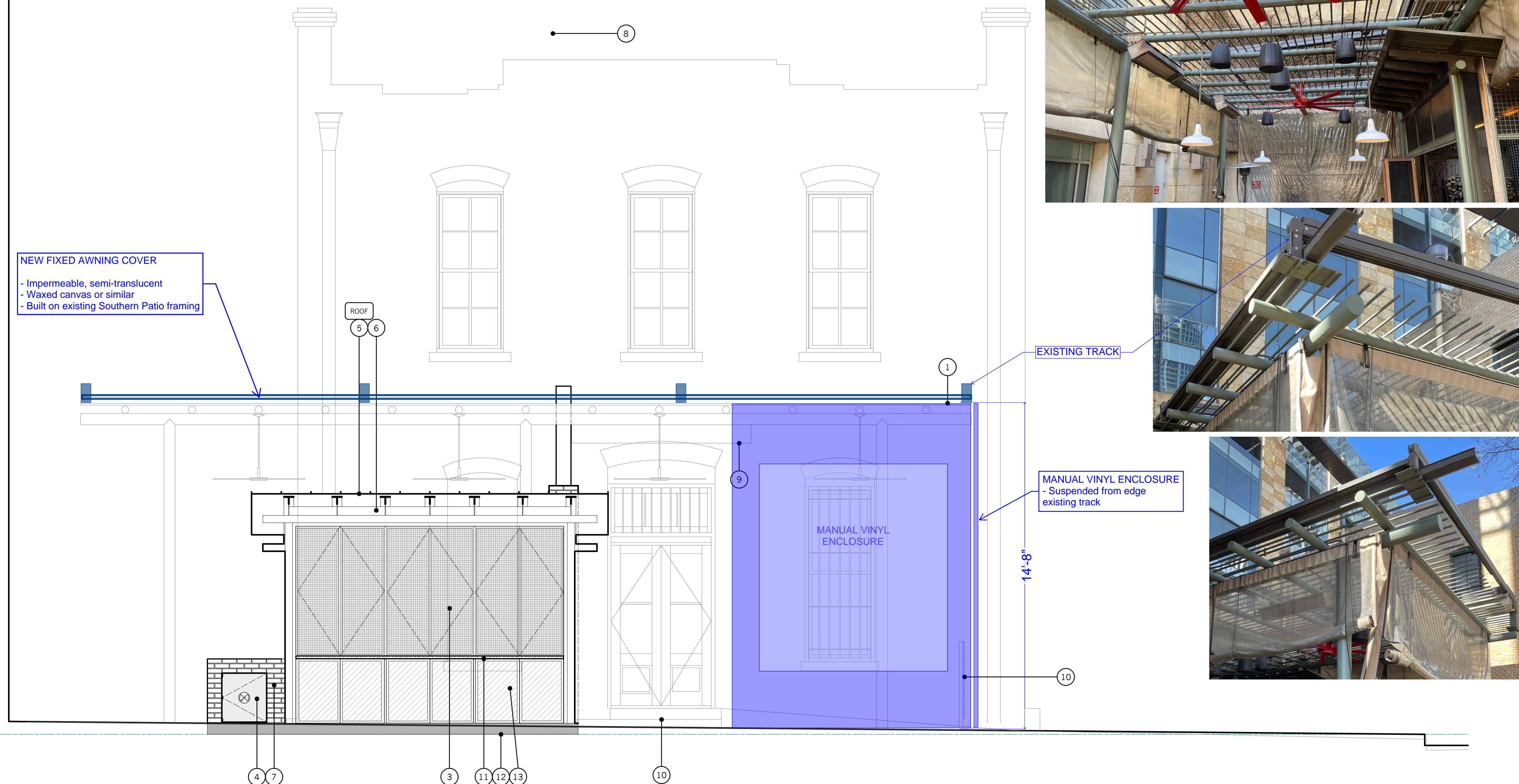

Elevation General Notes

- A. DO NOT SCALE THE DRAWINGS. If a specific dimension is not given, contact ARCHITECT for clarification.
- B. All dimensions are to face of finish, edge of awning, finish opening, or centerline of support. Contact ARCHITECT with any discrepancies.
- C. Contractor (GC) to field verify all existing dimensions prior to construction and/or installation of any equipment, accessories, etc.
- D. Keynotes located on this sheet are for this sheet only.

Elevation Keynotes

- Existing patio cover above, non-combustable.
- Existing stem mounted light fixture to remain.
- New steel framed insect screen mesh enclosure. All doors self-closing.
- Fire box. Fire Brick construction with steel plate access door.
- New Standing Seam Metal Roof, Class-A, [ROOF]. Refer to Roof Plan for specification.
- Steel framing, painted [PT-1].
- Brick load-bearing wall [BRICK-1].
- New smoker flue.
- Existing overhang to remain. Does not touch Historic Building.
- Existing fence, railings, stairs and ramp to remain.
- Wood window ledge, [TEAK].
- Concrete slab on-grade, integral color to match existing steps/ramp.
- 1/4" Steel plate infill panel.



2018 April 24

M
G
I
C

Architecture

Magic Architecture PC
7712 Lazy Lane
Austin, TX 78757
(512) 994-5762
email: scott@scottmagic.com

Project Title

Lambert's Smoker Shed

410 W. 2nd Street, Patio
Austin, Texas 78701

Issue

● 2018 April 24 Permit Set

Sheet Title

Proposed Elevation - East

Sheet Number

A3.1

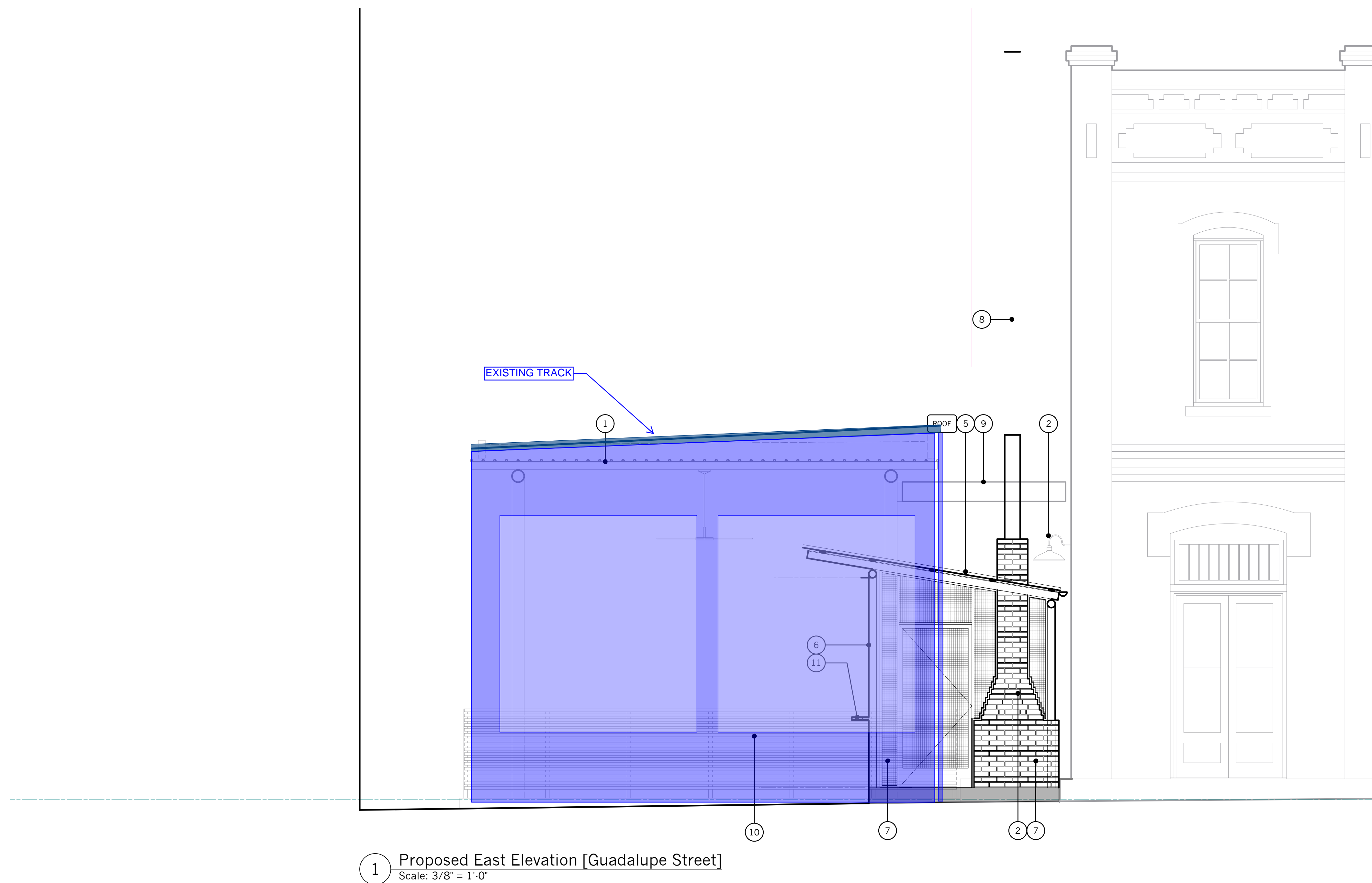

Elevation General Notes

- DO NOT SCALE THE DRAWINGS. If a specific dimension is not given, contact ARCHITECT for clarification.
- All dimensions are to face of finish, edge of awning, finish opening, or centerline of support. Contact ARCHITECT with any discrepancies.
- Contractor (GC) to field verify all existing dimensions prior to construction and/or installation of any equipment, accessories, etc.
- Keynotes located on this sheet are for this sheet only.

Elevation Keynotes

- Existing patio cover above, non-combustable.
- Existing stem mounted light fixture to remain.
- New steel framed insect screen mesh enclosure. All doors self-closing.
- Fire box. Fire Brick construction with steel plate access door.
- New Standing Seam Metal Roof, Class-A. Refer to Roof Plan for specification.
- Steel framing, painted.
- Brick load-bearing wall.
- New smoker flue.
- Existing overhang to remain. Does not touch Historic Building.
- Existing fence, railings, stairs and ramp to remain.
- Wood window ledge.