



# City of Austin

---

## Housing and Planning Department

P.O. Box 1088, Austin, TX 78767 -1088

(512) 974-3100 ♦ Fax (512) 974-3112 ♦ [www.cityofaustin.org/housing](http://www.cityofaustin.org/housing)

### MEMORANDUM

**TO:** Todd W. Shaw, Chair &  
Planning Commission Members

**FROM:** Maureen Meredith, Senior Planner, Inclusive Planning Division  
Housing and Planning Department

**DATE:** February 6, 2023

**RE:** NPA-2022-0017.01\_Crestview Village  
6916, 6926, 6928 N. Lamar Blvd and 808, 810, 812, 906 Justin Ln  
Crestview/Wooten Combined Neighborhood Planning Area

Staff requests a postponement of the above-referenced case from the **February 14, 2023** Planning Commission hearing to the **March 28, 2023 hearing date** to allow staff additional time to review the application.

The postponement request was made in a timely manner and meets the Planning Commission's policy.

Attachment: Plan Amendment Map

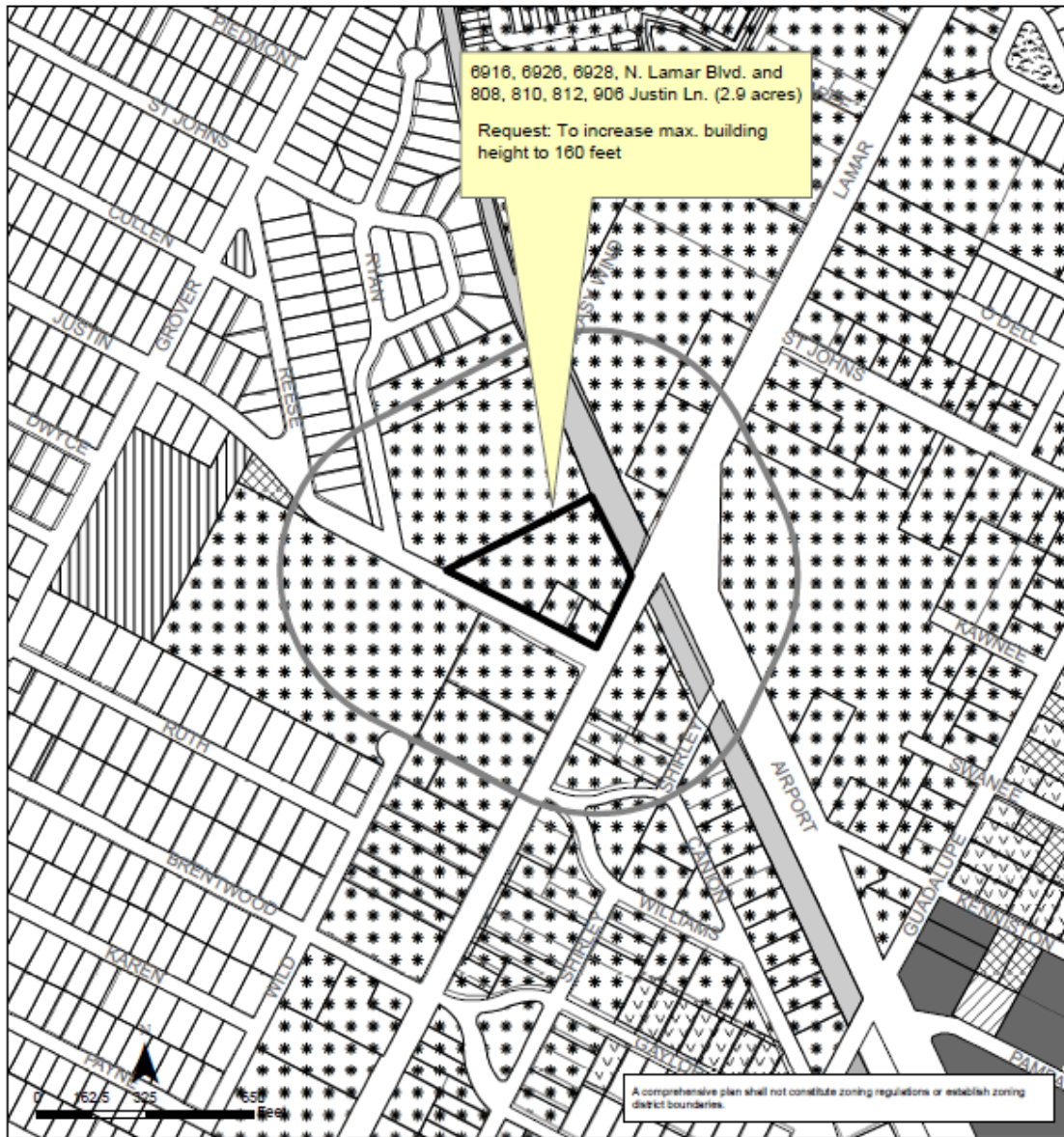

**Crestview/Wooten Combined (Crestview) Neighborhood Planning Area  
NPA-2022-0017.01**

This product is for informational purposes and may not have been prepared for or be suitable for legal, engineering, or surveying purposes. It does not represent an on-the-ground survey and represents only the approximate relative location of property boundaries.

This product has been produced by the Housing and Planning Department for the sole purpose of geographic reference. No warranty is made by the City of Austin regarding specific accuracy or completeness.



City of Austin  
Housing and Planning Department  
Created on 3/1/2022, by: MeeksS

Future Land Use			
	Subject Tract		Mixed Use/Office
	500 ft. notif. boundary		Multi-Family
	CMC		Recreation & Open Space
	Commercial		Single-Family
	Higher-Density Single-Family		Specific Regulating District
	Mixed Use		Transportation