

## ZONING CHANGE REVIEW SHEET

CASE: C14-2022-0106  
Hudson # 3

DISTRICT: 1

ZONING FROM: GR-MU-NP and CS-NP

TO: MF-6-NP

ADDRESS: 6115, 6117, 6201, 6305 Hudson Street and 6300 and 6308 Harold Court

SITE AREA: 6.24 acres

PROPERTY OWNERS: James T. Stewart; Saul & Arnold Sanchez; Hudson MF3 Holdings, LLC; Frank Young; Graper, LLC

AGENT: Alice Glasco Consulting (Alice Glasco)

CASE MANAGER: Heather Chaffin (512-974-2122, [heather.chaffin@austintexas.gov](mailto:heather.chaffin@austintexas.gov))

STAFF RECOMMENDATION:

**Staff supports the applicant's request of MF-6-NP.**

*For a summary of the basis of staff's recommendation, see case manager comments on page 2.*

PLANNING COMMISSION ACTION / RECOMMENDATION:

February 28, 2022:

January 24, 2023: To grant postponement to February 28, 2023, as requested by staff, on consent.

CITY COUNCIL ACTION:

TBD

ORDINANCE NUMBER:

ISSUES:

No issues at this time.

CASE MANAGER COMMENTS:

The subject property is located on the south side of Hudson Street approximately 400 feet west of Ed Bluestein Boulevard. The property also has frontage on Harold Court. The rezoning tract is comprised of multiple lots with GR-MU-NP and CS-NP. The lots are developed with automobile salvage, storage, and repair service land uses. Properties to the east of the rezoning tract are zoned CS-NP and include automobile salvage and storage, convenience storage and undeveloped properties. West of the subject property are properties zoned GR-MU-NP, MF-4-NP, and SF-3-NP. These properties include a mix of commercial, undeveloped and single family uses. The MF-4-NP property was rezoned from SF-3-NP in 2022. Across Hudson Street to the north are properties zoned CS-MU-NP, LI-NP, IP-NP that are developed with a mix of land uses including automotive repair services, plant nursery, and religious assembly. Northwest of the subject property are SF-3-NP zoned residential properties and a P-NP property that contains Travis County International Cemetery. Across Harold Court to the south is Red Bluff Nature Preserve, which is zoned SF-3-NP. Also to the south are properties zoned CS-NP developed with a range of commercial uses, including vehicle storage, convenience storage and other uses. ***Please see Exhibits A and B- Zoning Map and Aerial Exhibit.***

Staff supports the MF-6-NP rezoning request. In the 400-foot distance to Ed Bluestein is a mix of commercial uses; properties west of the site are zoned GR-MU-NP and MF-4-NP that could be developed with multifamily residential that “steps down” to the SF-3-NP properties further west. Multifamily zoning at this location will increase the number of housing units in the area and increase the mix of housing options in the area. This reflects priorities outlined in the Council adopted Strategic Housing Blueprint.

BASIS FOR RECOMMENDATION

1. *The proposed zoning should be consistent with the goals and objectives of the City Council.*
2. *The rezoning should be consistent with the policies and principles adopted by the City Council or Planning Commission.*
3. *Zoning should promote a transition between adjacent and nearby zoning districts, land uses, and development intensities.*
4. *Zoning should promote clearly-identified community goals, such as creating employment opportunities or providing for affordable housing.*

NEIGHBORHOOD PLANNING AREA: East MLK Combined NP (MLK-183)

RELATED CASES: NPA-2022-0015.04

TIA: Deferred to time of site plan, if required.      WATERSHED: Fort Branch

EXISTING ZONING AND LAND USES:

	ZONING	LAND USES
Site	SF-3-NP	Automobile salvage, storage, and repair services
North	SF-3-NP, P-NP, CS-MU-NP, LI-NP, IP-NP	Single family residential, Cemetery, Automotive repair services, Undeveloped, Plant nursery, Religious assembly
South	SF-3-NP, CS-NP	Red Bluff Nature Preserve, mixed commercial including Automobile storage and repair services
East	CS-NP	Automobile salvage, storage Undeveloped, Convenience storage
West	GR-MU-NP, MF-4-NP, SF-3-NP	Single family residential, Undeveloped, mixed commercial uses

NEIGHBORHOOD ORGANIZATIONS:

Austin Heritage Tree Foundation	Austin Independent School District
Austin Innercity Alliance	Austin Neighborhoods Council
Bike Austin	Black Improvement Association
Claim Your Destiny Foundation	Del Valle Community Coalition
East Austin Conservancy	East MLK Contact Team
Friends of Austin Neighborhoods	Friends of Northeast AustinSF-3-NP
FRS Property Owners Association	Hog Pen NA
Homeless Neighborhood Association	Jackie Robinson Acres
Lincoln Garden Association	M.E.T.S.A. Neighborhood Assn
Neighbors United for Progress	Preservation Austin
Reissig Group	Seltexas
Sierra Club Austin Regional Group	Truman Heights Neighborhood Assn
East MLK Combined Neighborhood Association	

AREA CASE HISTORIES:

NUMBER	REQUEST	ZAP/PLANNING COMMISSION	CITY COUNCIL
C14-2022-0017 5711, 5801, 5805, 5809, 5813, 5817, 5901 & 5909 Hudson Street	SF-3-NP to MF-4-NP	5/24/2022: to grant MF-3-NP as rec. by staff	07/28/2022: to grant MF-4-NP
C14-2019-0107.SH 5511, 5515, 5517, & 5519 Jackie Robinson St.	SF-3-NP to SF-6-NP	6/23/2020: To grant SF-6-NP as rec., on consent	7/30/2020: To grant SF-6 as rec., on consent
C14-2017-0097 1321 Delano St, 5600 Jackie Robinson Ln	SF-3-NP to SF-6-NP	01-23-2018 Apvd SF-6-CO-NP with max 62 du, NTA RC	02-15-2018 Grant SF-6-CO-NP as rec by PC

EXISTING STREET CHARACTERISTICS:

Name	ASMP Classification	ASMP Required ROW	Existing ROW	Existing Pavement	Sidewalks	Bicycle Route	Capital Metro (within ¼ mile)
HUDSON ST	Local Mobility - Level 2	72 feet	60 feet	26 feet	No	No	No
HAROLD CT	Local Mobility - Level 2	84 feet	38 feet	32 feet	No	No	No

ADDITIONAL STAFF COMMENTS:Environmental

1. The site is not located over the Edwards Aquifer Recharge Zone. The site is located in the Fort Branch Creek Watershed of the Colorado River Basin, which is classified as an Urban Watershed by Chapter 25-8 of the City's Land Development Code.
2. Zoning district impervious cover limits apply in the Urban Watershed classification.
3. According to floodplain maps there is no floodplain within or adjacent to the project location.
4. Standard landscaping and tree protection will be required in accordance with LDC 25-2 and 25-8 for all development and/or redevelopment.
5. At this time, site specific information is unavailable regarding vegetation, areas of steep slope, or other environmental features such as bluffs, springs, canyon rimrock, caves, sinkholes, and wetlands.
6. This site is required to provide on-site water quality controls (or payment in lieu of) for all development and/or redevelopment when 8,000 s.f. cumulative is exceeded, and on site control for the two-year storm.

Site PlanGeneral

- SP1. A site plan will be required for any new development other than single-family, two-family or duplex residential.
- SP2. Any new development is subject to the design standards in Subchapter E of the Land Development Code. Additional comments will be made when the site plan is submitted.
- SP3. This site will be subject to the multifamily density provisions in 25-2-563.
- SP4. Any development which occurs in an SF-6 or less restrictive zoning district which is located 540-feet or less from property in an SF-5 or more restrictive zoning district will be subject to compatibility development regulations.

Compatibility Standards

- SP5. The site is subject to compatibility standards. Along the east, south and west property lines, the following standards apply:

- ☐ No structure may be built within 25 feet of the property line.
- ☐ No parking or driveways are allowed within 25 feet of the property line.
- ☐ No structure in excess of two stories or 30 feet in height may be constructed within 50 feet of the property line.
- ☐ No structure in excess of three stories or 40 feet in height may be constructed within 100 feet of the property line.
- ☐ For a structure more than 100 feet but not more than 300 feet from property zoned SF-5 or more restrictive, the height is limited to 40 feet plus one foot for each 10 feet of distance in

excess of 100 feet from the property zoned SF-5 or more restrictive.

□ For a structure more than 300 feet but not more than 540 feet from property zoned SF-5 or more restrictive, the height is limited to 60 feet plus one foot for each four feet of distance in excess of 300 feet from the property zoned SF-5 or more restrictive.

□ A fence, berm, or dense vegetation must be provided to screen adjoining properties from views of parking, mechanical equipment, storage, and refuse collection.

□ An intensive recreational use, including a swimming pool, tennis court, ball court, or playground, may not be constructed 50 feet or less from adjoining SF-3 property.

□ Additional design regulations will be enforced at the time a site plan is submitted.

SP6. The applicant is responsible for requesting demolition or relocation permits upon site plan approval. The City of Austin Historic Preservation Officer will review all proposed building demolitions and relocations prior to site plan approval. If a building is deemed to meet city historic criteria, the Historic Landmark Commission may initiate a historic zoning case on the property.

SP7. The site is located within the Controlled Compatible Land Use Area of the Austin-Bergstrom Airport. No use will be allowed that creates electrical interference with navigational signals or radio communications between airport and aircraft, makes it difficult for pilots to distinguish between the airport lights and others, results in glare in the eyes of pilots using the airport, impairs visibility in the vicinity of the airport, creates bird strike hazards or otherwise in any way endangers or interferes with the landing, taking off, or maneuvering of aircraft intending to use the Austin-Bergstrom Airport. Height limitations and incompatible uses with each Airport Overlay zone are established in the Airport Overlay Ordinance. Airport Hazard Zoning Committee review may be required prior to Planning Commission Hearing.

Hazardous Pipeline Ordinance

SP8. Due to its presence within the Hazardous Pipelines overlay, this site is subject to the Hazardous Pipeline Ordinance. Development in a restricted pipeline area is regulated by Sec. 25-2-516. Review by the Fire Department will be required for any proposed development. Before a person may place a road, surface parking lot, or utility line in a restricted pipeline area, the person must deliver to the Director a certification by a registered engineer stating that the proposed construction activity and structure are designed to prevent disturbing the pipeline or impeding its operation.

Neighborhood Planning Area

SP9. This site is located in the East MLK Combined Neighborhood Plan. Please see the City's Neighborhood Plans and Resources webpage for a copy of the recommended design guidelines.

### Transportation

- ATD 1. Assessment of required transportation mitigation, including the potential dedication of right of way and easements and participation in roadway and other multi-modal improvements, will occur at the time of site plan application. A traffic impact analysis shall be required at the time of site plan if triggered per LDC 25-6-113.
- ATD 2. The Austin Strategic Mobility Plan (ASMP) calls for 72 feet of right-of-way for HUDSON ST. It is recommended that 36 feet of right-of-way from the existing centerline should be dedicated for HUDSON ST according to the Transportation Plan with the first subdivision or site plan application. [LDC 25-6-51 and 25-6-55].
- ATD 3. The Austin Strategic Mobility Plan (ASMP) calls for 84 feet of right-of-way for HAROLD CT. It is recommended that 42 feet of right-of-way from the existing centerline should be

dedicated for HAROLD CT according to the Transportation Plan with the first subdivision or site plan application. [LDC 25-6-51 and 25-6-55].

ATD 4. The adjacent street characteristics table is provided below:

Name	ASMP Classification	ASMP Required ROW	Existing ROW	Existing Pavement	Sidewalks	Bicycle Route	Capital Metro (within ¼ mile)
HUDSON ST	Local Mobility - Level 2	72 feet	60 feet	26 feet	No	No	No
HAROLD CT	Local Mobility - Level 2	84 feet	38 feet	32 feet	No	No	No

### Parks & Recreation

PR1: Parkland dedication will be required for the new residential units proposed by this development, multifamily with MF-6-NP zoning, at the time of subdivision or site plan, per City Code § 25-1-601. Whether the requirement shall be met with fees in-lieu or dedicated land will be determined using the criteria in City Code Title 25, Article 14, as amended. Should fees in-lieu be required, those fees shall be used toward park investments in the form of land acquisition and/or park amenities within the surrounding area, per the Parkland Dedication Operating Procedures § 14.3.11 and City Code § 25-1-607 (B)(1) & (2). If the applicant wishes to discuss parkland dedication requirements in advance of site plan or subdivision applications, please contact this reviewer: [thomas.rowlinson@austintexas.gov](mailto:thomas.rowlinson@austintexas.gov). At the applicant's request, PARD can provide an early determination of whether fees in-lieu of land will be allowed.

### Water Utility

AW1. The landowner intends to serve the site with City of Austin water and wastewater utilities. The landowner, at own expense, will be responsible for providing any water and wastewater utility improvements, offsite main extensions, utility relocations and or abandonments required by the land use. The water and wastewater utility plan must be reviewed and approved by Austin Water for compliance with City criteria and suitability for operation and maintenance.

Based on current public infrastructure configurations, it appears that service extension requests (SER) will be required to provide service to this lot. Service Extension Requests 5387 (W) and 5388 (WW) are submitted for review but not approved. For more information pertaining to the Service Extension Request process and submittal requirements contact the Austin Water SER team at [ser@austintexas.gov](mailto:ser@austintexas.gov). The landowner must pay the City inspection fee with the utility construction. The landowner must pay the tap and impact fee once the landowner makes an application for a City of Austin water and wastewater utility tap permit.



AW2. 30 TAC §285, §15-5, §15-9: City records indicate a portion of the site is served by an On-Site Sewage Facility (OSSF). The owner must connect the site to city wastewater service through the cutover process. For more information pertaining to the wastewater cutover process, contact the AW OSSF team at [OSSF@austintexas.gov](mailto:OSSF@austintexas.gov) or call (512)-972-0050.

### INDEX OF EXHIBITS TO FOLLOW

- A: Zoning Map
- B. Aerial Exhibit

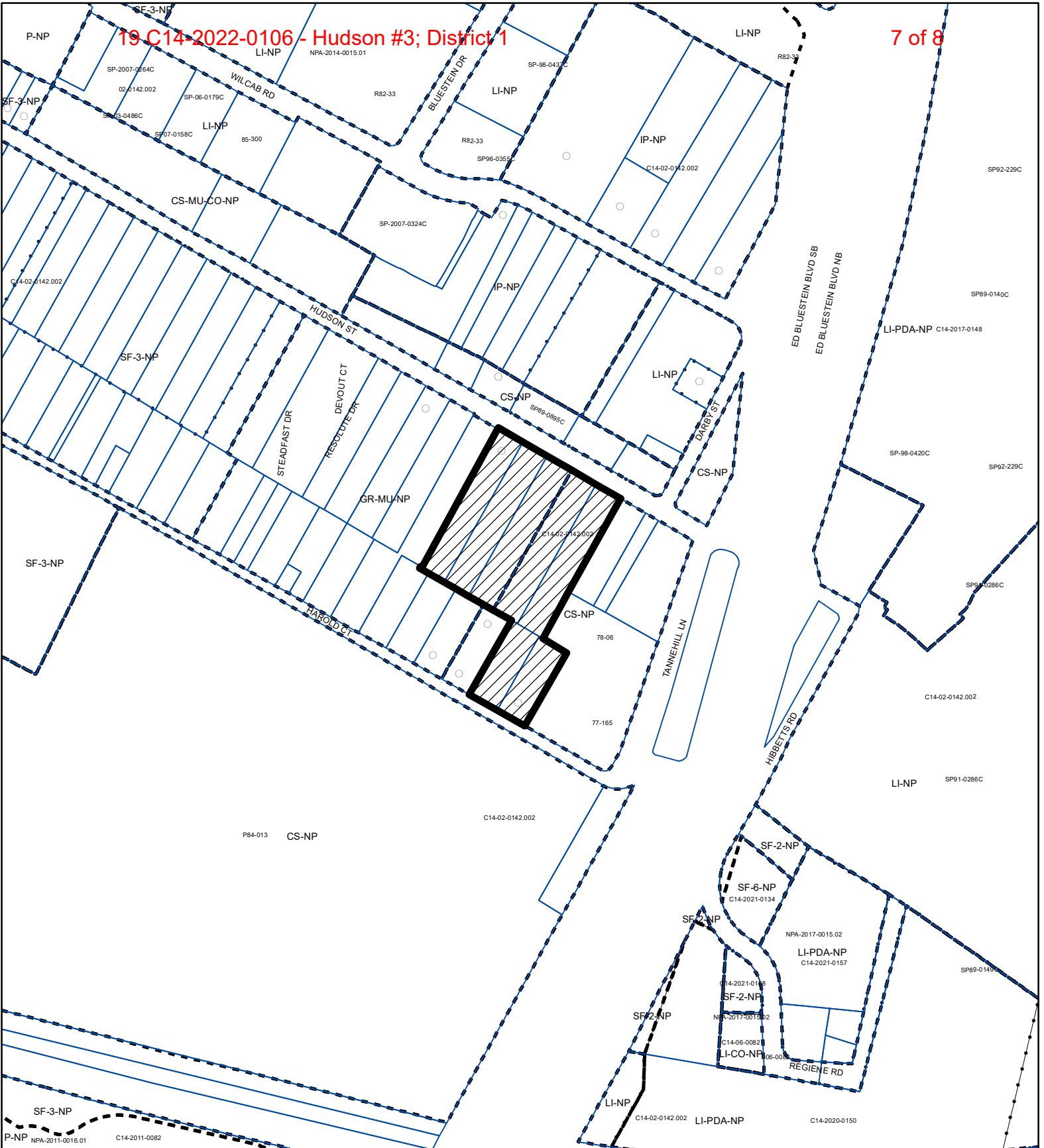



-  SUBJECT TRACT
-  PENDING CASE
-  ZONING BOUNDARY

## ZONING

ZONING CASE#: C14-2022-0106

1" = 400'

This product is for informational purposes and may not have been prepared for or be suitable for legal, engineering, or surveying purposes. It does not represent an on-the-ground survey and represents only the approximate relative location of property boundaries.

This product has been produced by the Housing and Planning Department for the sole purpose of geographic reference. No warranty is made by the City of Austin regarding specific accuracy or



Created: 7/27/2022





### Hudson #3

ZONING CASE#: C14-2022-0106  
 LOCATION: 6115, 6117, 6201, 6305 Hudson St  
 SUBJECT AREA: 6.24 Acres  
 GRID: M22  
 MANAGER: Heather Chaffin



This product has been produced by the Housing and Planning Department for the sole purpose of geographic reference. No warranty is made by the City of Austin regarding specific accuracy or completeness.

Created: 1/18/2023