



# City of Austin

---

1 of 2

## Housing and Planning Department

P.O. Box 1088, Austin, TX 78767 -1088

(512) 974-3100 ♦ Fax (512) 974-3112 ♦ [www.cityofaustin.org/housing](http://www.cityofaustin.org/housing)

### MEMORANDUM

**TO:** Todd W. Shaw, Chair &  
Planning Commission Members

**FROM:** Maureen Meredith, Senior Planner, Inclusive Planning Division  
Housing and Planning Department

**DATE:** March 21, 2023

**RE:** NPA-2022-0017.01\_Crestview Village  
6916, 6926, 6928 N. Lamar Blvd and 808, 810, 812, 906 Justin Ln  
Crestview/Wooten Combined Neighborhood Planning Area

Staff requests a postponement of the above-referenced case from the **March 28, 2023** Planning Commission hearing to the **May 23, 2023 hearing date** to allow staff additional time to review the application.

The postponement request was made in a timely manner and meets the Planning Commission's policy.

Attachment: Plan Amendment Map

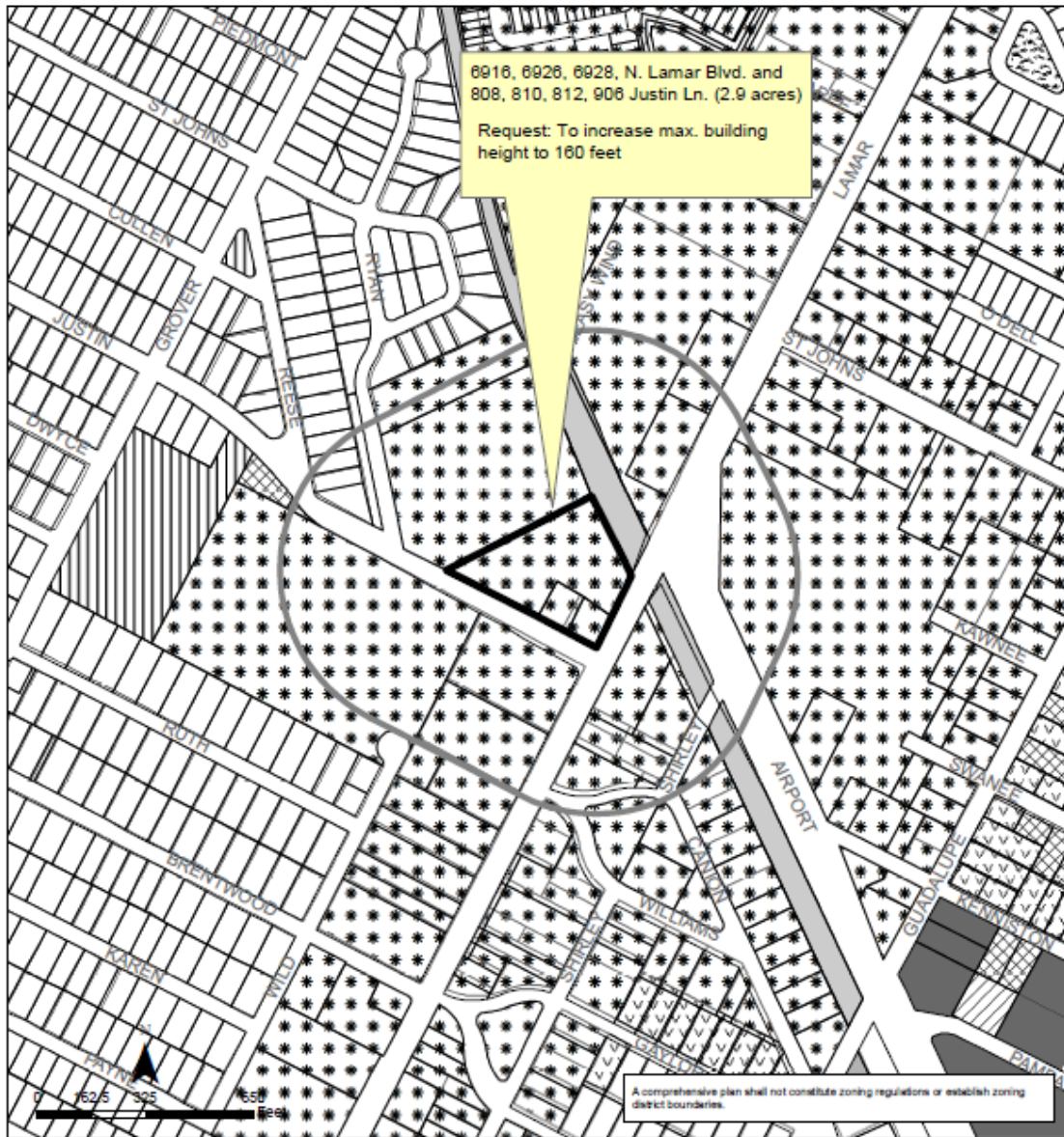

**Crestview/Wooten Combined (Crestview) Neighborhood Planning Area  
NPA-2022-0017.01**

This product is for informational purposes and may not have been prepared for or be suitable for legal, engineering, or surveying purposes. It does not represent an on-the-ground survey and represents only the approximate relative location of property boundaries.

This product has been produced by the Housing and Planning Department for the sole purpose of geographic reference. No warranty is made by the City of Austin regarding specific accuracy or completeness.



City of Austin  
Housing and Planning Department  
Created on 3/1/2022, by: MeeksS

Future Land Use	
Subject Tract	Mixed Use/Office
500 ft. notif. boundary	Multi-Family
Civic	Recreation & Open Space
Commercial	Single-Family
Higher-Density Single-Family	Specific Regulating District
Mixed Use	Transportation