

**JULY 12, 2023**

**Pilar Sanchez**

**County Executive**

**Travis County Health &  
Human Services**

512.854.4101

[pilar.sanchez@traviscountytexas.gov](mailto:pilar.sanchez@traviscountytexas.gov)

**Ana Almaguel**

**Program Manager - Public Health**

**Travis County Health &  
Human Services**

512.854.5870

[ana.almaguel@traviscountytexas.gov](mailto:ana.almaguel@traviscountytexas.gov)

# TRAVIS COUNTY HEALTH & HUMAN SERVICES: DEPARTMENT OVERVIEW

The purpose of Travis County HHS is to address community needs through  
**internal and external investments and services**  
to maximize the quality of life for all our residents.

# TRAVIS COUNTY HEALTH & HUMAN SERVICES

- **Who we are:** A Department of Travis County that serves the community under the guidance of the Commissioners Court
- **What we do:** Address community needs through internal and external investments and services
- **What we strive to accomplish:** Maximize quality of life for all people in Travis County
  - Protect vulnerable populations
  - Invest in social and economic well-being
  - Promote healthy living: physical, behavioral, and environmental

# DIRECT SERVICES: FAMILY SUPPORT SERVICES

- The Family Support Services (FSS) division is the largest provider in Travis County of **basic needs emergency assistance, through financial and non-financial services.**
- Financial assistance offered: Rent, mortgage, utilities, indigent burial/cremation
- Non-financial assistance offered: Basic needs supplies (food, clothing, hygiene, diapers, PPE), supportive case management, social work services
- Services are provided at 6 central and rural community centers throughout the county

A photograph of a large, modern university building with a central tower and multiple wings. The building is light-colored with dark window frames. A large flagpole stands in front of the central tower, flying the North Carolina state flag. The building is surrounded by green lawns and some trees.

A photograph of a large, modern building with a prominent glass facade and a dark, patterned exterior. A green tree is in the foreground, partially obscuring the view. The building has a gabled roof and large windows.

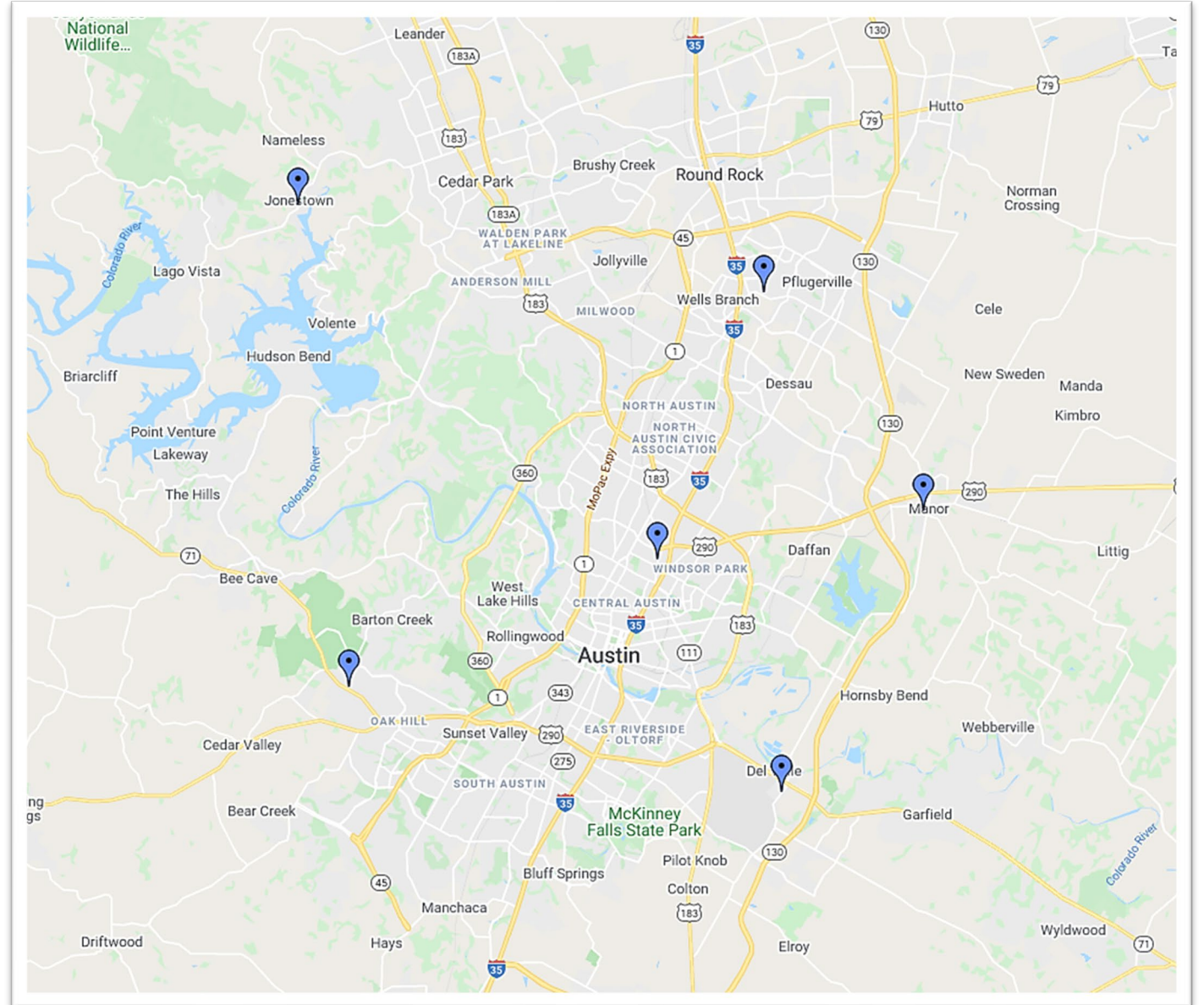

# DIRECT SERVICES: OFFICE OF CHILDREN'S SERVICES

- The Office of Children Services (OCS) mission is the promotion of services, supports and policies that enhance the well-being of children, youth and their families. The division focuses in these key areas: Early Childhood, Child Welfare, Behavioral Health, and development of a Social Service workforce through Internships.
- OCS oversees these programs:
  - Healthy Families Travis County – Early Childhood Program
  - Travis County Family First – Child Welfare
  - Travis County Family Drug Treatment Court/Parenting in Recovery (PIR) – Child Welfare
  - Community Partners for Children/CRCG – Behavioral Health
  - The Children's Partnership – Behavioral Health

# DIRECT SERVICES: COMMUNITY SERVICES DIVISION

- The Community Services Division (CSD) houses a wide array of programs that focus on youth, people with disabilities, and older adults in Travis County
- CSD programs:
  - Summer Youth Employment
  - Neighborhood Conference Committee
  - Housing Services (home repair and weatherization)
  - engAGE (senior programming)
  - Services for the Deaf and Hard of Hearing

# DIRECT SERVICES: AGRILIFE

- The [Texas A&M AgriLife Extension Service](#) in Travis County is part of the statewide Texas A&M AgriLife Extension Service and the Cooperative Extension Program at Prairie View A&M University.
- Agrilife improves the lives of people, businesses, and communities by providing **outreach and continuing education programs and services** to the residents of Travis County:
  - Agriculture and Natural Resources
  - Horticulture
  - Integrated Pest Management
  - Family and Consumer Sciences
  - Nutrition, Health and Wellness
  - 4-H and Youth Development
  - 4-H CAPITAL
  - Cooperative Extension Program

# DIRECT SERVICES: RESEARCH & PLANNING DIVISION

R&P works within the Department, County, and community to find solutions to complex human service issues.

## Informing Our Community

Support informed decision making by creating access to data and promoting quality data standards

- *Data reports and storymaps*
- *Research briefs*

## Finding Solutions

Support group processes that improve productivity and encourage collaborative problem solving and informed decision making

- *Community planning*
- *Task groups and collaborations*
- *Group facilitation*

## Ensure Effectiveness

Promote effective and transparent allocation of Travis County resources through planning, evaluation, and process improvement

- *Performance measurement*
- *Evaluation processes*
- *Reporting*

## Invest in Social Services

Coordinate, plan, and implement social service investments that are strategic, targeted, and responsive to community need

- *Planning*
- *Procurement*
- *Contract management*

# PURCHASED SERVICES: SOCIAL SERVICE ISSUE AREAS

Issue Areas	Goals
<b>Access to Basic Supports: Food</b>	<ul style="list-style-type: none"> <li>▪ Reduce food insecurity</li> <li>▪ Prevent hunger</li> </ul>
<b>Access to Basic Supports: Legal Rights &amp; Benefits</b>	<ul style="list-style-type: none"> <li>▪ Help residents obtain/maintain public benefits</li> <li>▪ Help residents obtain/maintain immigration benefits, legal status, or protections for which they are eligible</li> </ul>
<b>Behavioral Health</b>	<ul style="list-style-type: none"> <li>▪ Identify and treat mental health and substance use disorders</li> <li>▪ Promote increased access to mental health services for adults, youth, children and families</li> <li>▪ Promote increased access to crisis response services for both children and adults</li> <li>▪ Increase investment in the continuum of services for substance use prevention, intervention and treatment</li> </ul>
<b>Child &amp; Youth Development</b>	<ul style="list-style-type: none"> <li>▪ Improve childcare access, affordability, and quality</li> <li>▪ Increase supports to vulnerable families with children</li> <li>▪ Provide out-of-school time programming</li> </ul>
<b>Housing Continuum</b>	<ul style="list-style-type: none"> <li>▪ Promote safe, decent, affordable, and stable housing</li> <li>▪ Prevent homelessness</li> <li>▪ Reduce housing cost burden</li> </ul>
<b>Public Health Social Services</b>	<ul style="list-style-type: none"> <li>▪ Provide services to residents living with HIV/AIDS</li> <li>▪ Prevent teen pregnancies and sexually transmitted infections</li> </ul>
<b>Safety Intervention Services</b>	<ul style="list-style-type: none"> <li>▪ Prevent victimization [unfunded]</li> <li>▪ Promote safety and well-being for victims</li> <li>▪ Reduce barriers to well-being for people with involvement in the criminal legal system [unfunded]</li> </ul>
<b>Supportive Services for Community Living</b>	<ul style="list-style-type: none"> <li>▪ Promote the independence and well-being of older adults and people with disabilities</li> </ul>
<b>Workforce Development</b>	<ul style="list-style-type: none"> <li>▪ Help individuals improve workplace skills, obtain employment, and succeed in the workplace</li> <li>▪ Help employers secure a skilled workforce</li> </ul>

# PURCHASED SERVICES: SOCIAL SERVICE INVESTMENTS

- Over \$26 million in purchased general fund social services in Travis County in **FY22**
- Contracts with nonprofit and community-based organizations
- Interlocals with Austin Public Health, Animal Services Office, and Integral Care

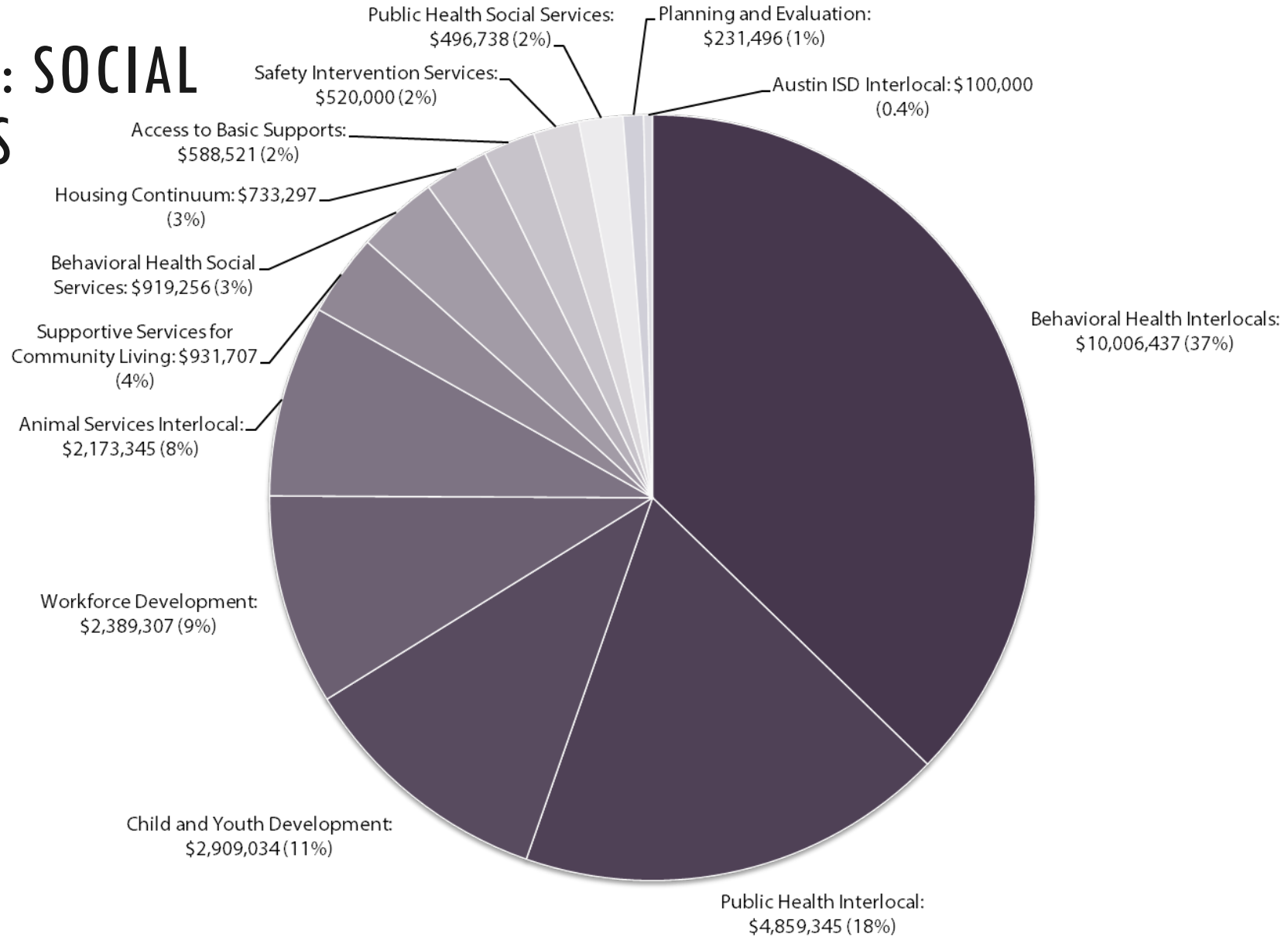

*Note: Not included in the social services investments: HHS direct services and ARPA-LFRF and other federal pandemic response funds*

# INTEGRAL CARE INTERLOCAL AGREEMENTS

Program	Description
ACT Team Expansion	Provides ongoing behavioral health treatment including rehabilitation and support services to individuals who typically have a history of multiple hospitalization treatments, chronic health conditions, criminal justice involvement, and/or chronic homelessness in Travis County
Child Therapist for Parenting In Recovery/Family Drug Treatment Court	Designed to maintain children in the care of their parents while they begin the journey of recovery from Substance Use Disorder and develop the skills and ability to safely parent their children. Focused on stopping the cycle of abuse and neglect and to promote strong mental health for the next generation.
EMCOT (Expanded Mobile Crisis Outreach Team)	Focused on diverting jail bookings and emergency department admissions and providing short-term community-based interventions to stabilize a psychiatric crisis and link individuals to appropriate services.
EMCOT: Expanded 911 Services	Takes mental health crisis calls in order to assess for appropriate, alternative safe response for individuals experiencing a mental health crisis in-lieu of law enforcement response.
Families with Voices/Familias Con Voces Collaborative	Helps families overcome challenges, meet their everyday needs, and improve their health and well-being. Services include help with food, transportation, job training, one-on-one emotional support, and connection to local resources.
Main Mental Health Interlocal	
Main Mental Health Interlocal: IDD Care Coordinator	A care coordinator position dedicated to The Children's Partnership, exclusively serving children and youth with co-occurring IDD and Mental Health diagnoses
Main Mental Health Interlocal: IDD Crisis Respite	Short-term crisis respite to individuals with confirmed or suspected IDD experiencing a mental health crisis. Decreases time between identified need and access to crisis respite and improving access to facility-based services by providing additional staffing supports.
Main Mental Health Interlocal: IDD In-Home Respite	Increases access to respite for individuals who historically have difficulty locating providers. Supports caregivers' ability to continue to help taking care of individual and provides the individual and caregiver with a break.

# INTEGRAL CARE INTERLOCAL AGREEMENTS

Program	Description
Main Mental Health Interlocal: IDD Intake and Enrollment Coordinator	Designed to decrease the time between request and completion of eligibility determination, and between the release of a slot and enrollment into the HCS Waiver Program
Main Mental Health Interlocal: Intensive Mobile Crisis Outreach Team (MCOT) Services for Children and Families	Focuses on expanding school, home, and community-based intervention services to prevent unnecessary inpatient hospitalization, provide continuity of care and crisis support following an initial crisis response, and act as hospital liaisons to Dell Children's ED. Goal is to stabilize crisis and bridge the client/family to on-going support in the community.
Main Mental Health Interlocal: Jail-Based Intake and Care Navigation	Embeds intake and care navigation services at Travis County Correctional Complex to assess for eligibility and connect to ongoing behavioral health services.
Main Mental Health Interlocal: Outpatient Competency Restoration Program	Helps individuals deemed incompetent to stand trial to restore competency, thereby allowing legal proceeding to continue. Services can aid in resolution of charges, reentry into the community, and linkage to appropriate community services.
Main Mental Health Interlocal: Safe Landing	Provides additional supports in the foster care system with focus on Children Without Placement. Licensed Professional of the Healing Arts completes intake and diagnosis review.
Substance Abuse Managed Services Organization (SAMSO)	Maintains and expands a network of providers to increase access to high-quality SUD services across the service treatment continuum
SAMSO: MAT	Medical consultation, access to medication for treatment of opioid addiction, and participation in recovery supports and treatment, focusing on high-risk individuals who do not have qualifying insurance to cover MAT
SAMSO: ThriveCare of Travis County	Increases access to SUD treatment for individuals who are involved or at risk of involvement with the criminal justice system and who have a history of ED and/or EMS involvement. Promotes increased screenings and navigation for high-risk populations through Psychiatric Emergency Services
System of Care Managed Services Organization	

# INTEGRAL CARE INTERLOCALS: FY22 INVESTMENTS

TOTAL:  
**\$10,006,437**

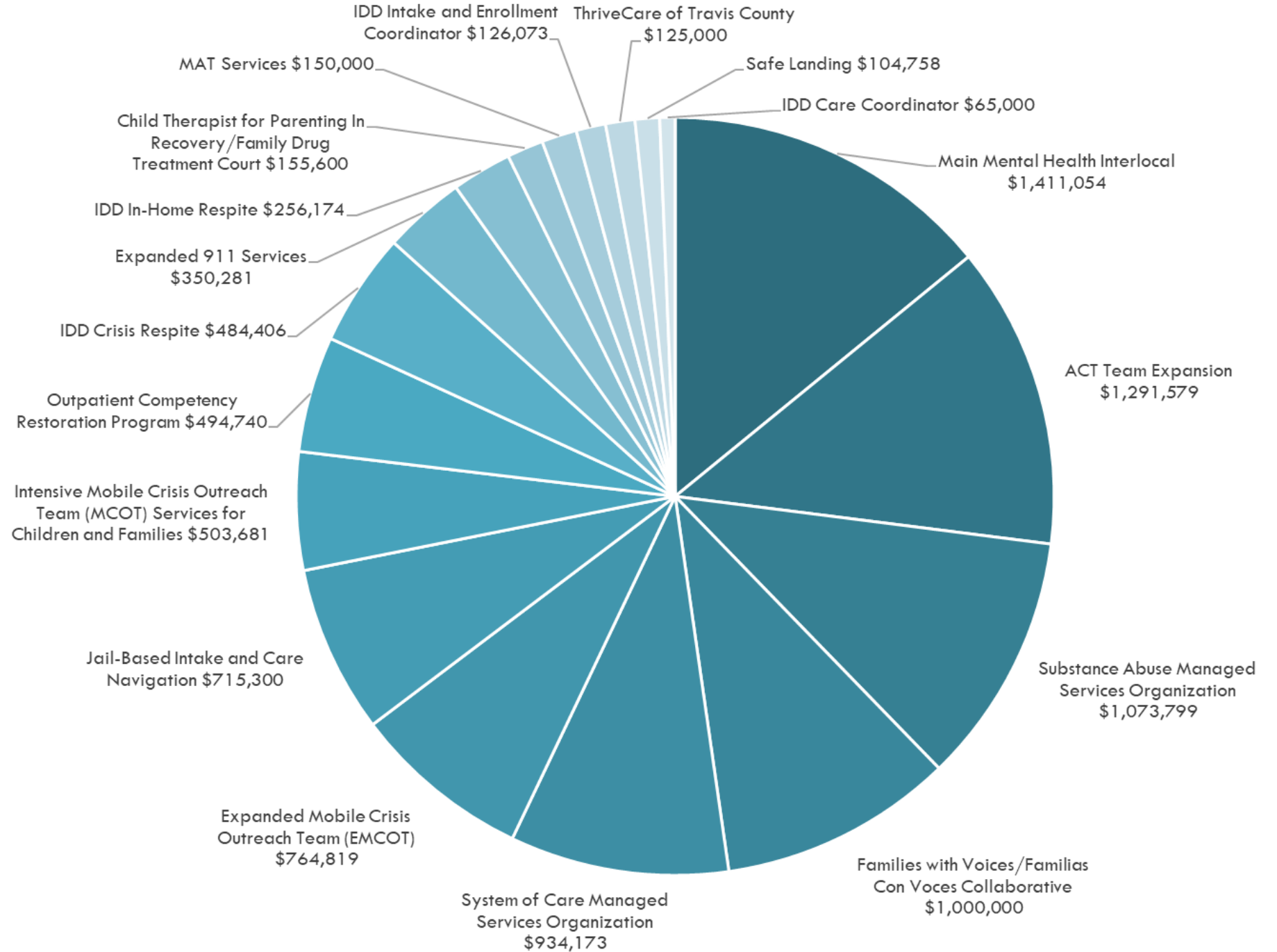

# INTERLOCAL AGREEMENTS WITH THE CITY OF AUSTIN FOR ANIMAL SERVICES AND PUBLIC HEALTH

Animal Services  
Interlocal Agreement:  
\$2,497,614

Public Health Interlocal  
Agreement:  
\$7,181,706

# BACKGROUND TO ANIMAL SERVICES ILA

- State laws governing ownership of domestic and exotic animals are enforced by both jurisdictions through local policies and adopted rules and ordinances. The roaming nature of some animals across jurisdictional boundaries is best served by a collaborative effort.
- The purpose of the Agreement is to allow the City and the County to combine resources and capabilities in providing a collaborative animal control enforcement and shelter services program that serves a regional populace in the identification and vaccination of domestic pets, the maintenance of shelter facilities, and the control of animals at large (both domestic and wild).

# ANIMAL CONTROL SERVICES

- Rabies Control activities
- Training. Ensure that Animal Protection Officers and Travis County Sheriff's Office (TCSO) personnel are adequately trained on the animal regulations and rules of Travis County Code and Texas Health and Safety Code any other applicable statutes.
- Sick and Injured Animals. Respond to calls for sick and injured stray animals and transport those animals to the shelter or after hour's emergency clinic for care.
- Dangerous Dog Hearings. City conducts Dangerous Dog investigations and hearings.
- Customer Services. City provides customer service either by telephone or directly to residents who visit the shelter
- Customer Complaints. City dispatches personnel to resolve customer complaints/calls for service associated with enforcement of County Regulations.
- Dispatch Services. Includes: management of field resources while they are in the field; distribution of service requests to field resources; customer service resolution by telephone; filing of citations; and bite report tracking for all reported animal bites requiring rabies quarantine.

# SHELTER SERVICES

**Acceptance and Maintenance of Animals** - The Austin Animal Center (AAC) accepts every lost animal from unincorporated areas of Travis County delivered to the shelter by animal control, emergency service personnel and those brought in/dropped off by residents. Shelter services include the following:

1. **Quarantine** - A fully accredited quarantine facility and system to provide for the strict isolation and close observation of dogs, cats, and domestic ferrets during quarantine to determine whether the animal was capable of transmitting rabies at the time it bit a person.
2. **Medical Care** - Emergency veterinary treatment and care is provided to any animal with an unknown owner or any surrendered animal requiring medical care upon arrival at the ACC.
3. **Vaccinations/Microchips** - Every animal leaving the shelter is provided a microchip and rabies immunizations unless proof of current vaccinations is provided.
4. **Sterilization and Immunization –**
  - a. **Shelter** - The shelter performs castrations and ovariectomies on animals prior to their release (as per state law) through the placement programs.
  - b. **County clinics** - County sterilization and immunization, as part of prevention services, is provided through immunization and sterilization clinics in targeted areas of Travis County.
5. **Euthanasia** - Animals that are not released to the owner, placed into the custody of a new owner, or placed with another animal welfare organization for the purpose of rehoming or sanctuary; or, when the shelter cannot provide treatment necessary to maintain the animal at a humane level of pain, that animal will be humanely euthanized according to applicable law.
6. **Adoption** - An attempt is made to place all adoptable animals in new homes and /or place them with approved partner animal welfare agencies for the purposes of rehoming or sanctuary.

# PREVENTION SERVICES

Provide education/outreach and prevention programs to impact animal welfare and reduce shelter intake. Programs are designed to improve the conditions and standards of care that animals experience as well as reduce the number of unwanted animals coming into the shelter. Examples of current programs include:

- Responsible Pet Owner class. First time violators of pet laws may have citations waived by attending the course on responsibilities of pet ownership.
- Speakers are available for education opportunities in neighborhoods (group meetings, newsletters, church meetings, schools, clubs, etc.)
- Free rabies vaccination program.
- Free sterilization services are provided in East Austin neighborhoods on a weekly basis.
- Free micro-chips and identification tags are provided for all Travis County residents so that pets can avoid being impounded at the shelter.

# PREVENTION PROGRAMS

**Wildlife Management Program** – The City of Austin Animal Services Office (ASO) extends wildlife management services similar to those provided within city limits to the unincorporated areas of Travis County.

The County has an Animal Protection Officer (APO) dedicated to respond to coyote and other wildlife concerns solely in the unincorporated areas of the County.

The APO's responsibilities include:

- call analysis and response, and,
- field response which includes data collection through
  - environmental observation,
  - game camera placement and,
  - community canvassing), yard audits, and outreach.

# PROGRAMS PURCHASED VIA PUBLIC HEALTH ILA

- Austin Healthy Adolescent (AHA)
- Chronic Disease Prevention and Control
- Communicable Diseases
- Comprehensive Public Health Planning
- Environmental Health
  - Consumer Health and Food Safety
  - Health and Safety Code Compliance
  - Information, Referral and Permitting
  - Pool & Spa Permitting
  - Rodent and Vector Control and Nuisance Abatement
- Epidemiology and Disease Surveillance
  - Public Health Emergency Preparedness
- Immunizations
- Injury Prevention
- Public Health Commission staffing support
- Quality of Life
- Sickle Cell

## Public Health ILA FY23 Percentage of Costs by Program

Total amount = \$7,181,706

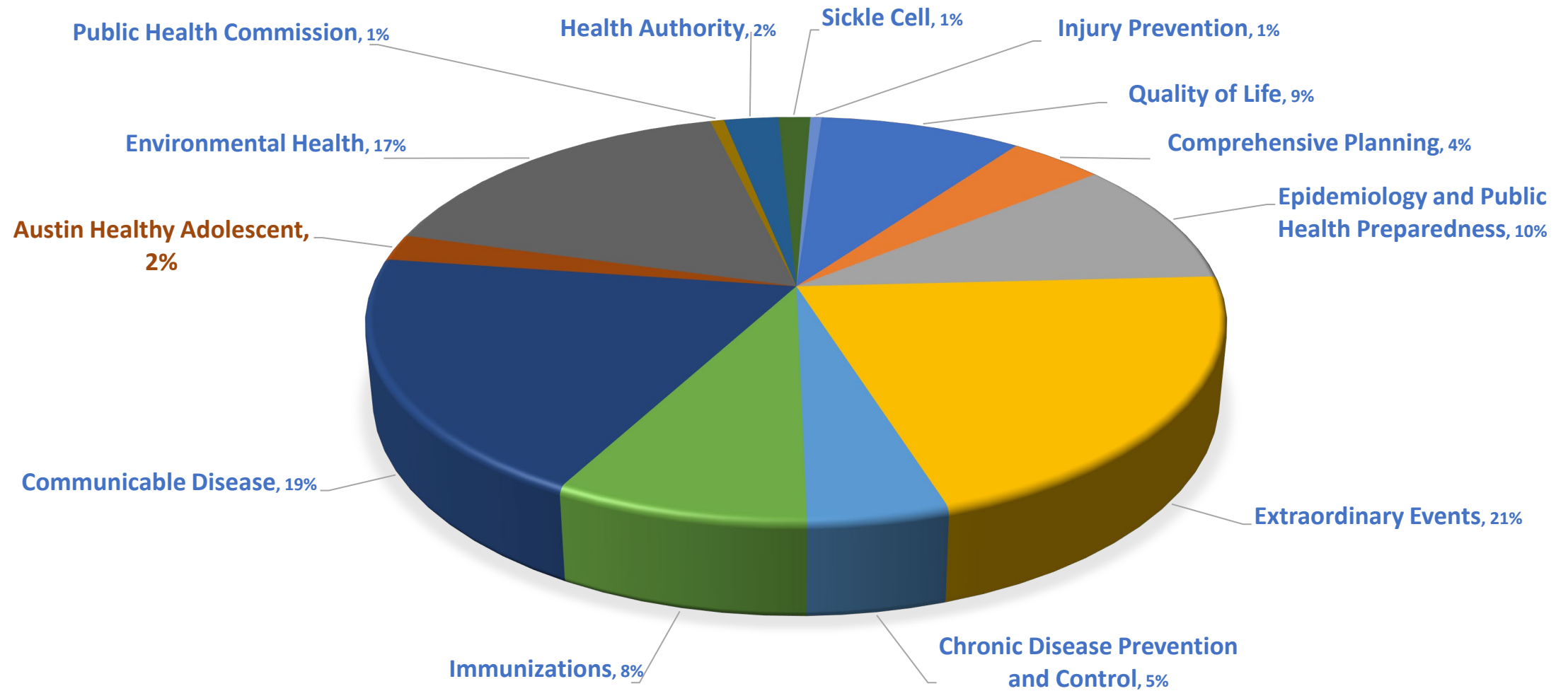

# NEW INITIATIVES AT HHS

## Top of Mind

New Public Health Commission

New Substance Use Disorder Consortium

SUD CRISIS

Diversion: Jail, MH, and Unhoused  
July 25 Diversion Center Town Hall - [RSVP](#)

\$110 Million in Affordable Housing

Gun Violence Prevention

Evolving Department

# LOCAL FISCAL RECOVERY FUNDS (LFRF) ALLOCATION UNDER THE AMERICAN RESCUE PLAN ACT (ARPA)

- Travis County's allocation is \$247,450,630.
  - LFRF funds are all one-time funds.
- County has developed separate "tracks" for these funds. Social services are a large part:
  - Travis County Commissioners Court approved some initial funding (approx. \$38M) in Spring 2021 for known/identified needs. In social services this included: food, workforce, childcare, behavioral health. Investment processes are currently underway (mix of competitive solicitations and direct negotiations).
  - Court also voted to allocate a significant portion (\$110M) towards supportive housing, planning and implementation currently in development.
  - In November 2022, the Court allocated \$500K for a two-year pilot Hospital-based Violence Intervention Program.
  - In May 2023 Court allocated the remaining funds, including \$1M to partner with the City on establishing a Trauma Recovery Center.

# DRUG OVERDOSE PREVENTION PUBLIC HEALTH CRISIS DECLARATION: TARGETED INVESTMENTS

- On May 24, 2022, the Court declared a public health crisis in Travis County related to drug overdoses. The goal of this declaration is to reduce overdose deaths in the community and support harm reduction activities and strategies. Investments made in response to this crisis included:
  - Training, purchase, and distribution of NARCAN to Non-Profit Organizations: Communities for Recovery, SAFE Alliance, Safe Haven, Sunrise Community Church, Sunrise Homeless Navigation Center, Texas Harm Reduction Alliance, The Other Ones Foundation, The Other Ones Foundation – Esperanza, Trinity Center of Austin, Urban Alchemy, and WorkingGroup512
  - Peer Recovery Coaching, with two coaches housed at community providers – one at The Other Ones Foundation - Esperanza and one at Sunrise Homeless Navigation Center
  - Medication Assisted Treatment (MAT) – Methadone Services with two community providers: Community Medical Services and Addiction and Psychotherapy Services

# PUBLIC HEALTH CRISIS DECLARATION: OTHER ACTIVITIES AND EFFORTS

- HHS hosted 7 Community Listening Sessions in 2022, both in-person and virtual, and developed a [summary](#) of key themes and strategies
- HHS produced a [report](#) on Travis County's funding allocation for mental health and substance use services and supports
- HHS, in collaboration with other County Departments and community organizations, developed a plan to place Sharps Collection Kiosks in the community
- Travis County PIO has been actively collaborating with community partners including Central Health, Austin Public Health, and Integral Care on a media education and awareness [campaign](#)

# OPIOID ABATEMENT FUNDS

- Travis County received an initial disbursement of \$1,476,519.10 in opioid abatement funds on March 2, 2023.
- Travis County's total allocation is anticipated to be \$4,703,473.
- The terms of the settlement agreements allow for varying payments to be received annually over a period of 18 years.
- HHS will provide an update to the Travis County Commissioners Court on August 1.

# SUD CONSORTIUM

- Various community discussions pointed clearly to the need for a single collaborative entity to provide guidance and recommendations for Substance Use Disorder (SUD) investments in supports and services across the continuum, so the Travis County Commissioners Court assigned HHS to facilitate a community planning process
- Following the 2020-2021 SUD Community Planning Process (recommendations are available [here](#)), community participants recommended creation of a new planning structure called the SUD Consortium, which will be led by an independent convener
- Travis County, City of Austin, and Central Health are the three funding partners of the convener and are in the process of executing an MOU that will guide the investment, solicitation process, and selection of a convener
- The convener is responsible for implementing the SUD Consortium, which will then begin the process of developing a community plan for SUD investment

# JAIL DIVERSION ENHANCEMENT AND FURTHER DEVELOPMENT OF A DIVERSION SYSTEM

“Diversion is a broad term referring to ‘**exit ramps**’ that move people away from the criminal legal system, offering an alternative to arrest, prosecution, and a life behind bars.”

“Diversion programs target the underlying problems that led to the criminalized behavior in the first place. By **addressing the root causes** of community instability—challenges such as food and housing insecurity, joblessness, lack of educational resources, and unmet mental health needs—diversion programs not only help improve long-term community safety and reduce crime but have also proven to be cost-efficient.”

Vera Institute of Justice, <https://www.vera.org/diversion-programs-explained>

# JAIL DIVERSION

## BUILDING ON CURRENT DIVERSION SYSTEM RESOURCES

### Elements of a Diversion System Are Already in Place

- **Crisis Services** (e.g., Emergency Behavioral Health Unit at Dell Seton, crisis respite, crisis residential, private hospitals)
- **Co-Responder Teams** (e.g., APD and TSCO Crisis Intervention Teams, Expanded Mobile Crisis Outreach Team)
- **Specialty Courts** (e.g., Travis County's Adult Diversion Court, Veteran's Treatment Court, DACC)
- **Peer Support** (e.g., Via Hope, Communities for Recovery)
- **Supportive Housing & Vouchers** (funding via the Finding Home ATX initiative)

### The Work Ahead

- Expanding and implementing existing services
- Aligning and linking diversion resources
- Building a Diversion Center

# LEARNING FROM PEER COMMUNITIES

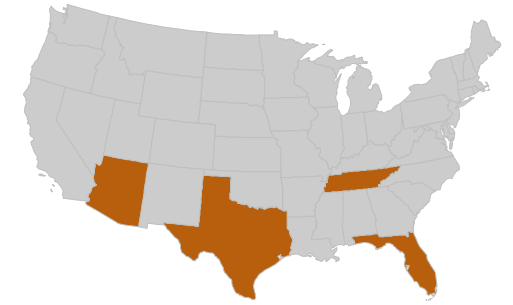

## High Level Take-Aways

- **Core elements** of an effective diversion system: **accountability, collaboration, and continuous improvement with data**
- The component parts of each diversion system were similar, but **no system is the same;**
  - local needs, state laws, available financing streams, and existing resources will dictate the design of a local diversion system
- **The integration of services** - from behavioral health, to legal counseling, to housing and supportive services, to peer support - **is vital to success**
- **“JUST GET STARTED!”** – Judge Liefman’s (from Miami-Dade) advice to Austin/Travis County

## Results from Peer Communities

### Diversion Site Visits

- Sites visited: Harris County, Bexar County, Nashville, Tucson, and Miami-Dade County

### Data Highlights

#### ***Miami-Dade County***

- Closed an entire jail facility; \$12M annual cost savings
- Reduction of nearly 110,000 inmate jail days annually; cost avoidance of \$29M

#### ***Tucson***

- Pre-arrest diversion services have resulted in over 95% of the clients being stabilized without an arrest, and 85% of the clients remain stable in the community 45 days after receiving care

# KEY ELEMENTS FOR A DIVERSION CENTER

## Travis County Central Booking, Intake & Diversion Center

### **Diversion Center**

- Include pre-arrest and post-arrest services
- Increase access to beds for people in need of behavioral health stabilization
- Include follow-up and connection to supportive services (e.g., psychiatric care, housing, peer support, health care, workforce development)
- Not be a substitute for the State of Texas's obligation to provide competency restoration and indigent mental health services
- Help ensure that participants who successfully complete their clinical treatment shall not be prosecuted for legal issues related to the underlying behavioral health issue
- Focus on decreasing the number of people with behavioral health needs entering jail, help them exit jail, and then keep them out of jail

### **Central Booking**

- Sufficient space for counsel at first appearance, clinical personnel, peer support specialists, and other innovative practices

# PILOTING DIVERSION FOCUSED ON SERVICES & HOUSING

## Key Elements & Goals

- Leverage existing resources and programs to create a pathway between medical/clinical care, support services, and housing
- Test and refine services and operational protocols to create strong hand-offs between diversion services, bridge housing, and long-term stable housing
- Stabilize behavioral health issues for people experiencing crisis in our jail and on the streets
- Reduce the jail population with behavioral health needs
- Reduce the number of unsheltered individuals on the street and in jails
- Initiate the modernization of data and technology

# PILOTING DIVERSION FOCUSED ON SERVICES & HOUSING

## Expanded Stabilization Services

- Expand Psychiatric Emergency Services (PES) to 24 hours/7 days a week
- Accept referrals from multiple entry points, including pre- and post-arrest
- Provide short-term stabilization from a behavioral health crisis, including triage, clinical assessments, treatment, and facilitated referral to both short and longer-term crisis residential services (The Inn, Guy Herman Center, and 15<sup>th</sup> Street)
- Annual Budget: \$4.6M

## Expanded Residential Services

Repurpose the 15<sup>th</sup> Street facility to serve individuals that cycle in and out of the criminal legal system, who have behavioral health issues and experience homelessness

- Capacity: 25 beds
- Duration: 30-90 days
- Services: Recovery and peer support, medical and psychiatric care, medication support, case management, life skills training, and an outreach specialist to help clients access long-term housing
- Annual Budget: \$4.0M



THE COUNTY IS PROPOSING TO INITIATE A 100-DAY CHALLENGE TO WORK WITH PARTNERS TO REFINE THE PILOT DESIGN, DEFINE THE ELIGIBILITY CRITERIA, AND RAISE THE NECESSARY FUNDING

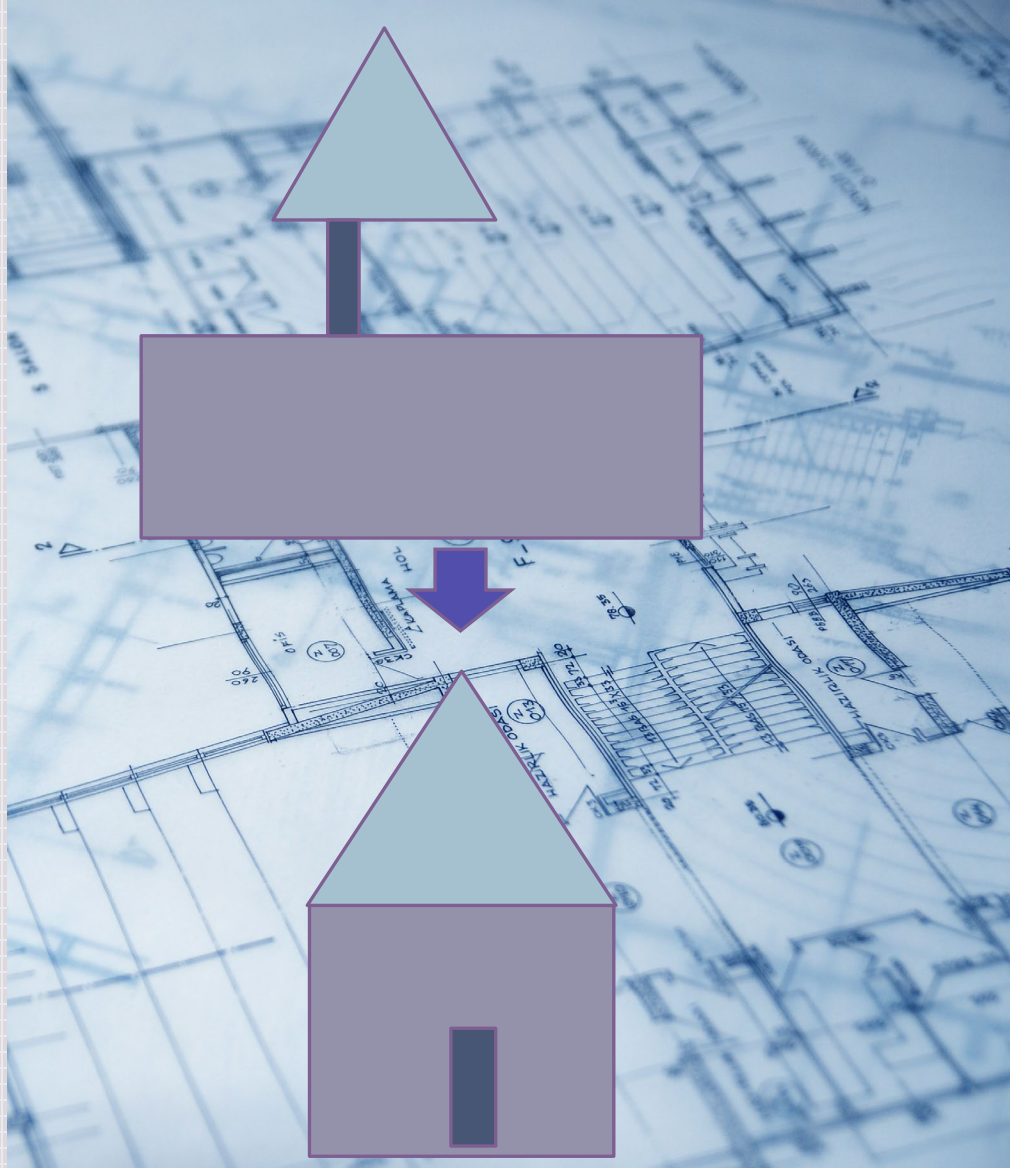

# TC SHIP

TRAVIS COUNTY  
SUPPORTIVE  
HOUSING INITIATIVE  
PIPELINE

# SHIP CATALYZES HOUSING, SUPPORT SERVICES, AND PARTNERSHIPS TO ADDRESS HOMELESSNESS

**\$110 Million investment is a part of a larger community goal to end homelessness and increase the supply of deeply affordable housing for vulnerable populations**

- **Unique public-private partnership**
- **American Rescue Plan Act (ARPA) funds**
- **Leveraging resources and expertise across Federal, State, City and County government, local non-profits, private developers and advocacy organizations**
- **For low-income Travis County residents and those experiencing homelessness**

## TC SHIP ADDS >2,000 SUPPORTIVE HOUSING UNITS ACROSS THE CONTINUUM

### Partner Organizations

Foundation Communities  
Mobile Loaves & Fishes  
The Other Ones Foundation  
Austin Area Urban League  
Caritas  
Family Eldercare  
Integral Care  
Life Works  
A New Entry  
SAFE Alliance

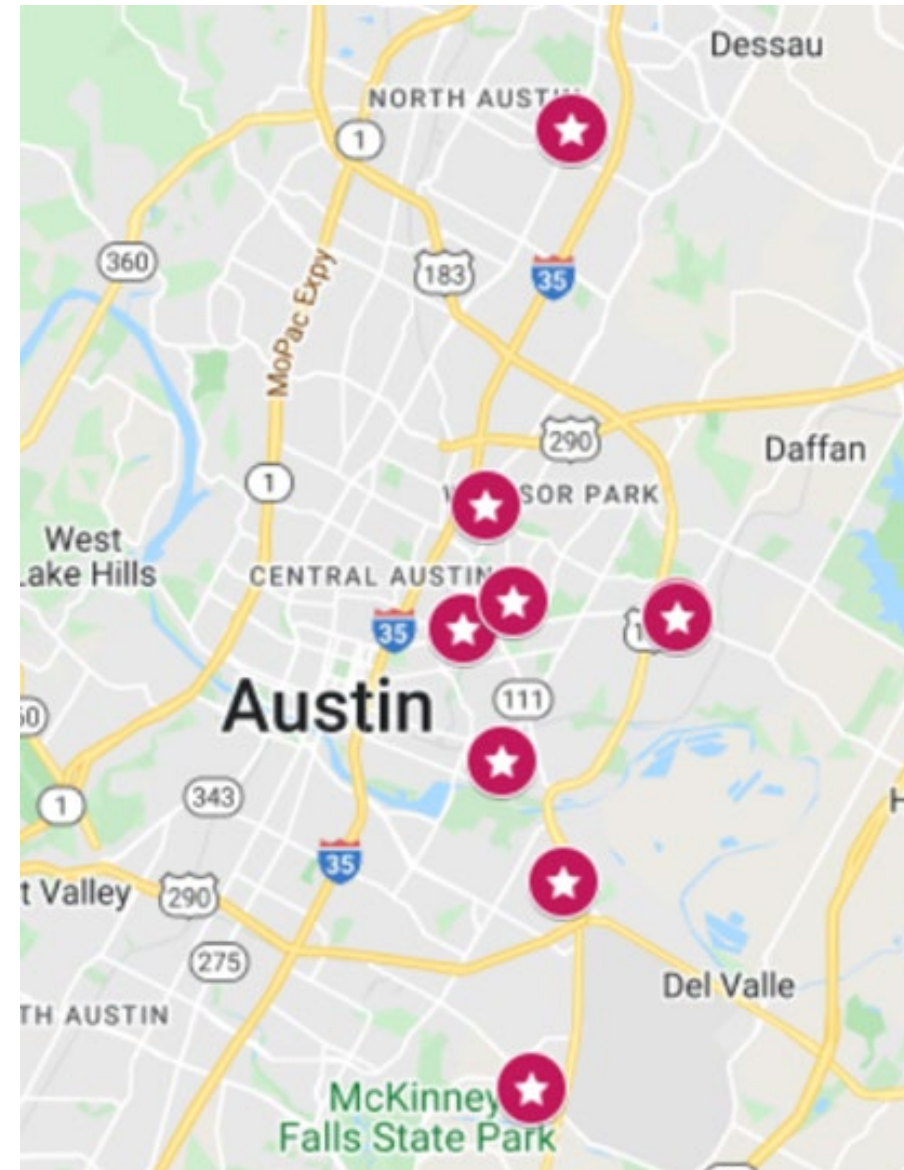

# SHIP ADDRESSES CROSS SECTIONS HOMELESSNESS, BEHAVIORAL HEALTH, AND CRIMINAL JUSTICE SYSTEM

**HOUSING IS ESSENTIAL TO JAIL DIVERSION**

**SHELTERS**

**RESIDENTIAL  
TREATMENT  
BEDS**

**HOUSING**

**RE-ENTRY**

**CASE  
MANAGEMENT**

**MH & SUD  
TREATMENT**

**PEER SUPPORT**

**PLANS,  
PLACEMENTS**

**HOUSING CONTINUUM &  
SUPPORT SERVICES**

# SAFER TRAVIS COUNTY RESOLUTION NOVEMBER 1, 2022

- Item #2. Directed Health & Human Services (HHS) to **provide to Court a proposal for the creation of a two-year pilot hospital-based violence intervention program (HVIP)**, to help disrupt cycles of gun violence by connecting survivors of gun violence with support services. The proposal will include:
  - Review of best practices, possible partners, recommended locations, a cost estimate, and a plan for an evaluation on the efficacy and impact on gun violence reduction.
  - HHS was directed to work with other county divisions and offices to complete this proposal.
- Item #4. Directed Justice and Public Safety (another Department of Travis County) to work with HHS and law enforcement to work with local and national experts as needed to **acquire data as to how and why homicides and community violence are happening in Travis County, in order to develop a public health approach to addressing the challenge.**
- Item #6. Directed the Planning & Budget Office (PBO) to earmark from American Rescue Act Plan Act, or other appropriate funding source as determined by PBO, **\$500,000 over two years to invest in a hospital-based violence intervention pilot program.**

# WHAT IS A HOSPITAL-BASED VIOLENCE INTERVENTION PROGRAM (HVIP)?

The Health Alliance for Violence Intervention (HAVI) provides a thorough and useful definition:

- “HVIPs are multidisciplinary programs that combine the efforts of medical staff with trusted community-based partners to provide safety planning, services, and trauma-informed care to violently injured people, many of whom are boys and men of color.
- Engaging patients in the hospital, during their recovery, is a golden opportunity to improve lives and reduce retaliation and recidivism. The support network continues once patients are released with a pathway for outpatient care and other services.”

## HVIPs are part of the Community Violence Intervention (CVI) Ecosystem

- “CVI is an approach that uses evidence-informed strategies to reduce violence through tailored community-centered initiatives.
- These multidisciplinary strategies engage with individuals and groups to prevent and disrupt cycles of violence and retaliation, and establish relationships with individuals and community assets to deliver services that save lives, address trauma, provide opportunity, and improve the physical, social, and economic conditions that drive violence.” ([www.lisc.org](http://www.lisc.org) “what is community violence intervention”)

## Model of the intervention at the hospital

Image below taken from PPT presentation (slide 12) at the Policies that Work to Reduce Gun Violence Forum in 2019 ([https://www.apha.org/-/media/files/pdf/topics/gun/gun\\_forum\\_panel\\_2.ashx](https://www.apha.org/-/media/files/pdf/topics/gun/gun_forum_panel_2.ashx))

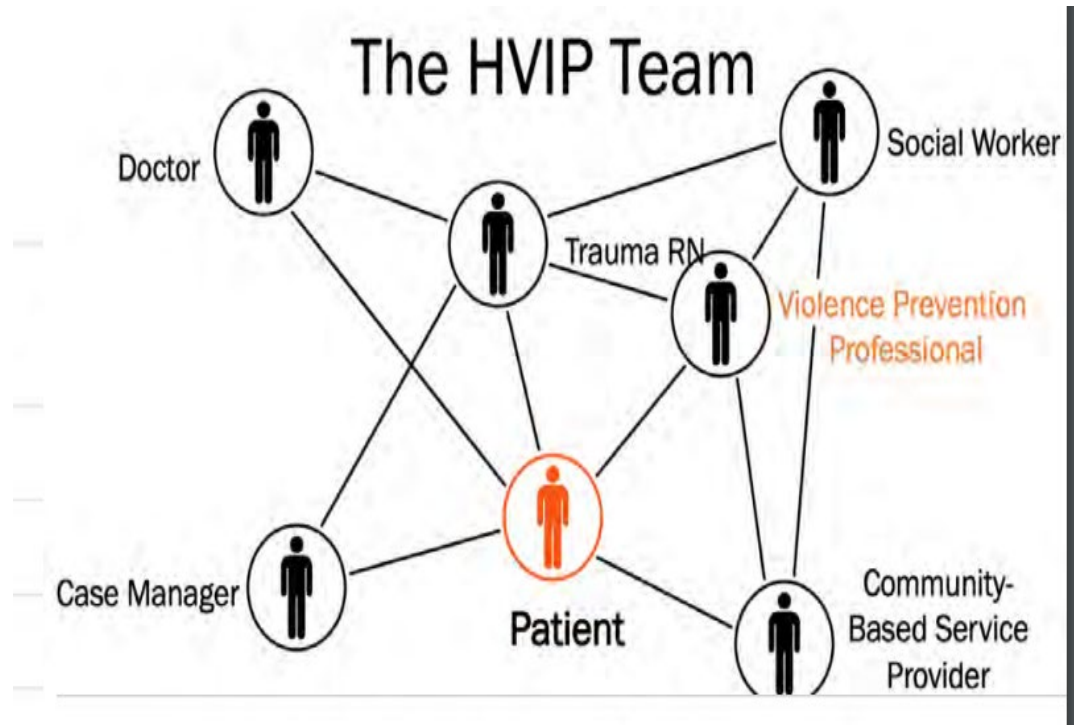

# WHAT IS A TRAUMA RECOVERY CENTER?

- One-stop centers to support victims of violent crime through recovery process
- Wide-ranging, comprehensive support, from mental health counseling and case management to navigating the justice system, help relocating - and more
- Confidential support in a trusted, community-centered environment

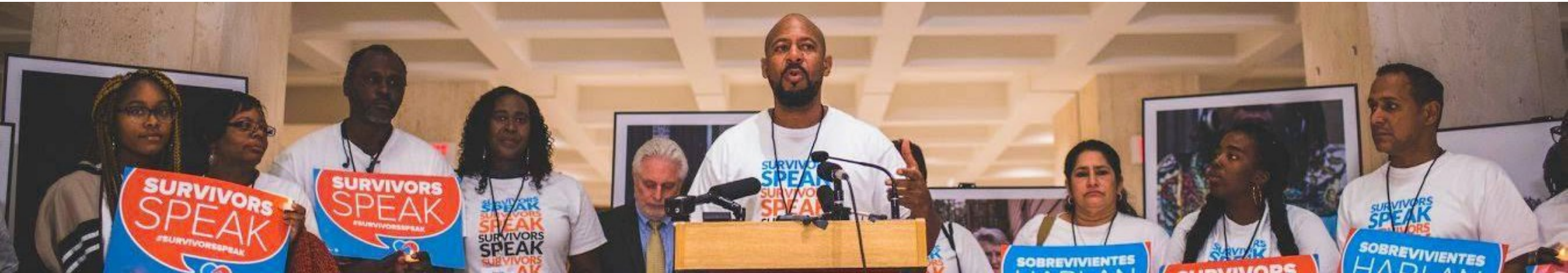

# THE MODEL



**Assertive outreach**  
and engagement to engage  
crime survivors in services.



**Proven approaches**  
to address crime survivor needs,  
like evidence-based psychotherapy  
that targets specific symptoms.

## **Clinical case management**

to address survivors' basic needs  
(medical, legal, financial, housing)  
and coordination of care across  
systems.



## **A mission to respond both to victims of crimes that are underserved**

(such as community violence) and to people who  
face challenges in accessing usual care, such as  
low-income people and those who are young,  
homeless or from communities of color.

# THE NEED

- Unaddressed trauma has costly consequences for the survivor, their family, and the larger community.

**1** IN **10** RECEIVE ASSISTANCE



**ONLY ABOUT ONE IN 10 PEOPLE WHO SURVIVE A  
VIOLENT CRIME RECEIVE DIRECT ASSISTANCE FROM  
A VICTIM SERVICE AGENCY.**

# PREVENTING REPEAT VICTIMIZATION

- The data show that victims of violent crime are 4 times as likely to be repeat crime victims and that more than one third of victims of violent crime have been repeatedly victimized.
- The comprehensive services provided by TRCs heal individuals, families, and communities, preventing repeat victimization and breaking cycles of crime and violence.

# WHY TRAUMA RECOVERY CENTERS?

- Work hand-in-hand with existing victims services and community resources. Traditional victims' services are one of the biggest sources of referrals to TRCs.
- Serve people who do not go through the criminal justice system.
- Serve people of color and people experiencing homelessness at higher rates.
- Increases access to victim compensation for survivors who are young, and who have less education.
- Serve survivors of a wider variety of crimes, including people experiencing community violence and family members who have lost loved ones to violence.
- Are more cost effective.
- Improve health and well-being of clients.

# IMPACT OF TRAUMA RECOVERY CENTERS

## **More Victims Access Supportive Services and the Justice System**

- Increased rate of sexual assault survivors receiving mental health from 6% to 71%
- Increased access to mental health services 72% TRC vs 38% usual care
- Increased cooperation with police – a 69% increase in police reports filed
- Decreased rate of 41 % in homelessness of survivors served by a TRC vs. usual care

## **Victims Experience Improvement in Health and Life Functioning**

- **74%** show an improvement in mental health
  - **51%** show an improvement in physical health
  - **52%** show a decrease in alcohol use
  - PTSD symptoms decrease **46%**
  - Depression symptoms decrease **47%**
- Impacts hold across different TRC's that have been studied

# COST AND SUSTAINABILITY OF TRAUMA RECOVERY CENTERS

- Clients served through a TRC vs usual care can be served at a third of the cost.
- The minimum cost of a TRC is \$1 million annually
- The County and City have agreed to partner, and will provide funding for two years, at \$500,000 per year.
- The TRC can serve hundreds of survivors a year.

# Trauma Recovery Centers

## Northern California

- Alameda County TRC - Family Justice Center
- West Contra Costa Family Justice Alliance
- Partnerships for Trauma Recovery, Berkeley
- Ruby's Place TRC, Castro Valley
- Solano TRC, Fairfield
- UC San Francisco TRC

## Southern California

- Long Beach TRC
- Downtown Women's Center/Peace Over Violence, Los Angeles
- CSUN - Strength United, Northridge
- Harbor-UCLA TRC, Torrance
- HOPICS/SSG TRC, Los Angeles
- Chadwick Center for Children & Families, San Diego
- Miracles Counseling Center TRC, Gardena
- Christian Counseling Service, Redlands
- Amanecer Community Counseling Service (LA)
- Palomar Health Foundation, San Diego
- Olive View UCLA, Los Angeles
- A Quarter Blue, Orange County



## Illinois

- Advocate TRC, Chicago
- Advocate Condell TRC, Lake County
- OSF STRIVE TRC, Peoria
- OSF St. Anthony TRC, Rockford
- SIU Survivor Recovery Center (SIU) TRC, Springfield

## Iowa

- Central Iowa TRC, Des Moines

## Ohio

- Seven Hills TRC, Cincinnati
- May Dugan TRC, Cleveland
- MetroHealth TRC, Cleveland
- Brenda Glass TRC, Cleveland
- OhioHealth TRC, Columbus
- OSU-STAR, Columbus
- C'tlookout TRC, Springfield
- Mercy Health TRC, Toledo

## Pennsylvania

- Central PA Center for Trauma & Healing - TRC, Harrisburg

## New Jersey

- Jersey City Medical Center TRC, Jersey City
- Newark Community Street Team TRC, Newark
- University Hospital TRC, Newark
- CarePlus TRC, Bergen County

## Georgia

- Grady Hospital TRC, Atlanta

## Florida

- Thriving Minds South Florida Trauma Recovery Network

**39 TRCs Nationally** (as of 7.1.2021)

**Q & A**