

BE IT ORDAINED BY THE CITY COUNCIL OF THE CITY OF AUSTIN:

§§§

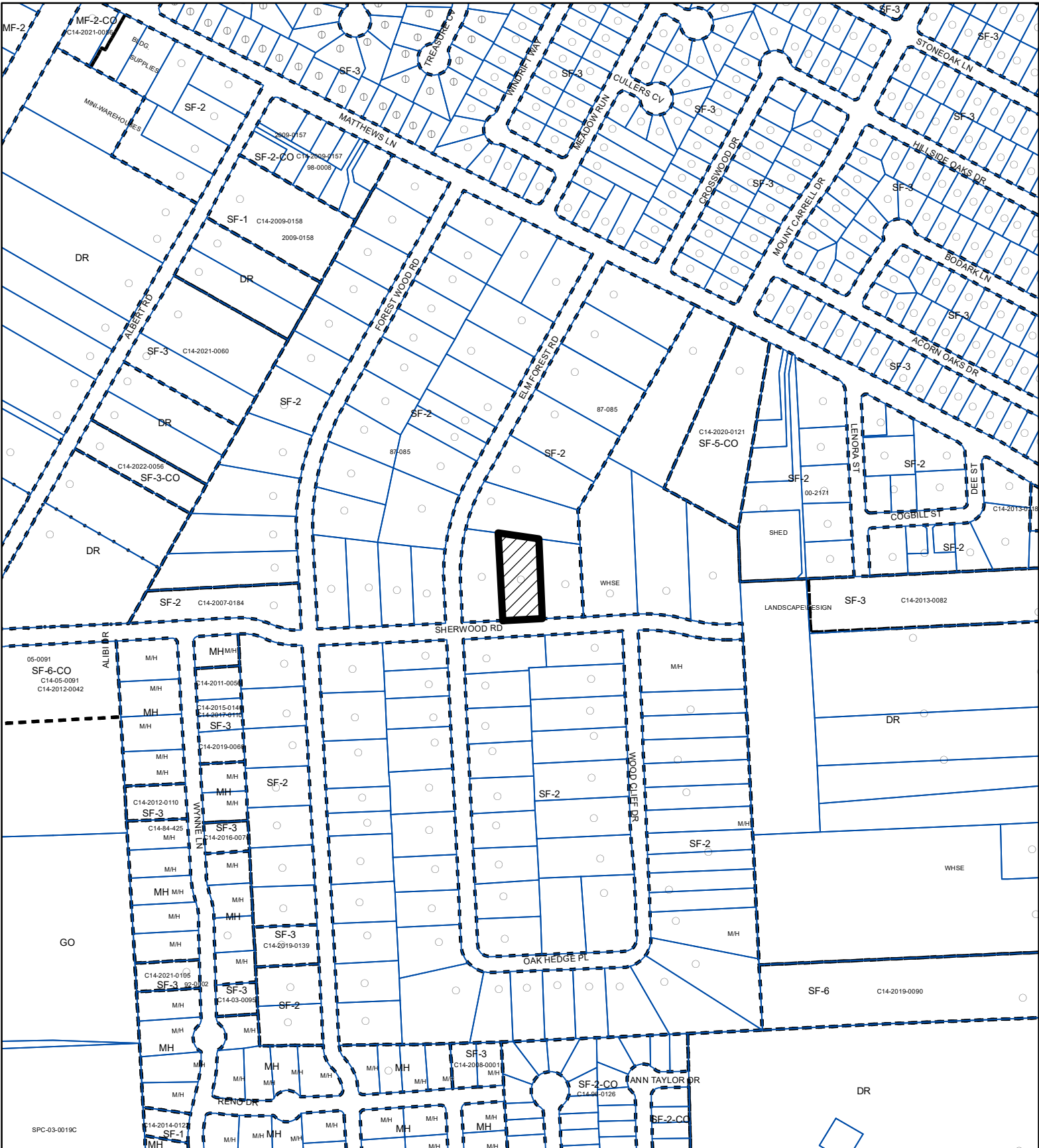

N

SUBJECT TRACT

PENDING CASE

ZONING BOUNDARY

ZONING

EXHIBIT A

ZONING CASE#: C14-2023-0004

1" = 400'

This product is for informational purposes and may not have been prepared for or be suitable for legal, engineering, or surveying purposes. It does not represent an on-the-ground survey and represents only the approximate relative location of property boundaries.

This product has been produced by the Housing and Planning Department for the sole purpose of geographic reference. No warranty is made by the City of Austin regarding specific accuracy or



Created: 1/23/2023