

ORDINANCE NO. _____

AN ORDINANCE AMENDING ORDINANCE NO. 040513-30, WHICH ADOPTED THE BRENTWOOD/HIGHLAND COMBINED NEIGHBORHOOD PLAN AS AN ELEMENT OF THE IMAGINE AUSTIN COMPREHENSIVE PLAN, TO CHANGE THE LAND USE DESIGNATION ON THE FUTURE LAND USE MAP FOR PROPERTY LOCATED AT 7009 GUADALUPE STREET.

BE IT ORDAINED BY THE CITY COUNCIL OF THE CITY OF AUSTIN:

PART 1. Ordinance No. 040513-30 adopted the Brentwood/Highland Combined Neighborhood Plan as an element of the Imagine Austin Comprehensive Plan.

PART 2. Ordinance No. 040513-30 is amended to change the land use designation from high density single family to multifamily residential for the property located at 7009 Guadalupe Street on the future land use map attached as **Exhibit "A"** and incorporated in this ordinance and described in File NPA-2023-0018.04 at the Planning Department.

PART 3. This ordinance takes effect on _____, 2023.

PASSED AND APPROVED

_____, 2023 §
 §
 §

Kirk Watson
Mayor

APPROVED: _____ **ATTEST:** _____

Anne L. Morgan
City Attorney

Myrna Rios
City Clerk

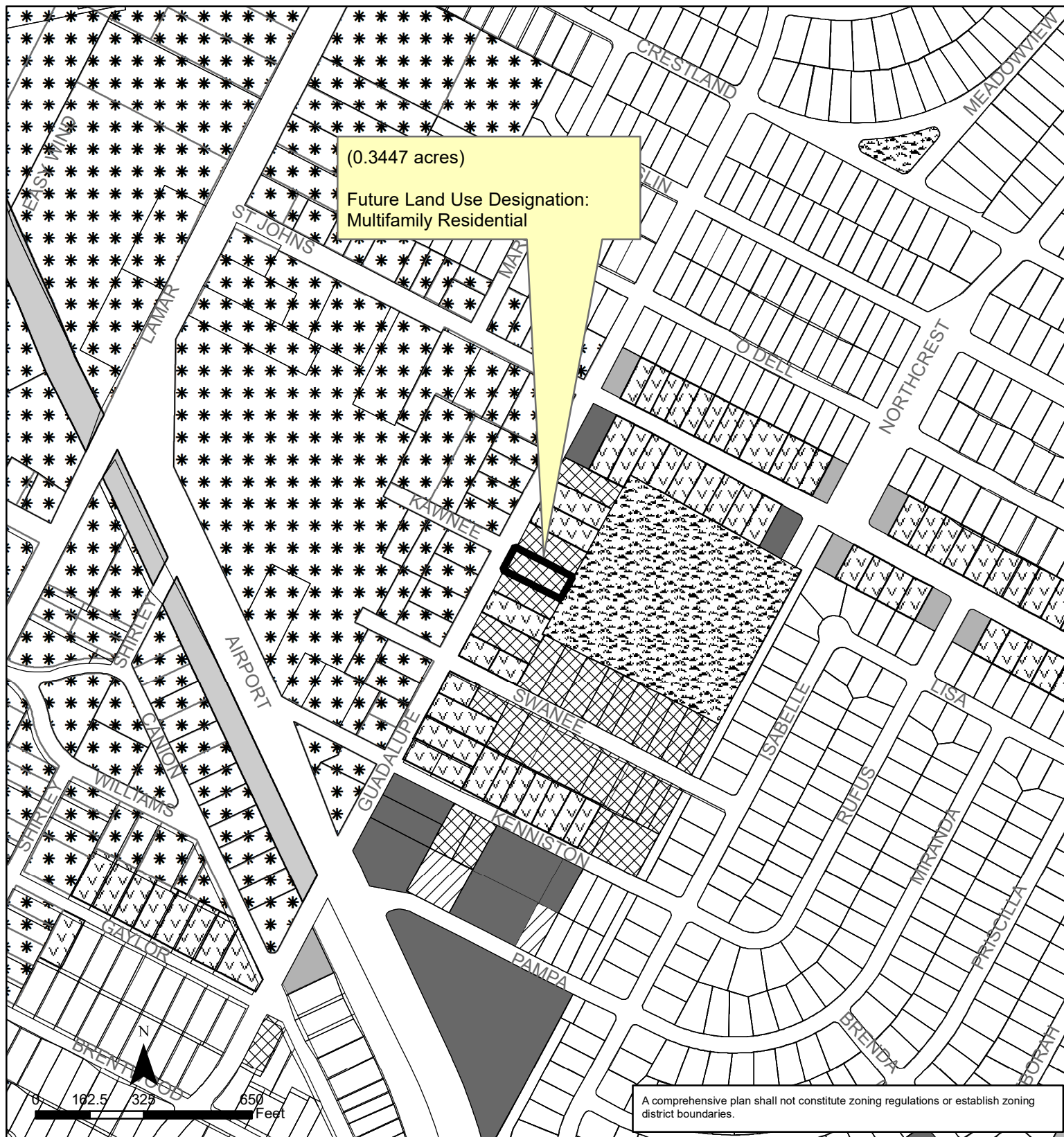

Exhibit A

Brentwood/Highland Combined Neighborhood Planning Area

NPA-2023-0018.04

This product is for informational purposes and may not have been prepared for or be suitable for legal, engineering, or surveying purposes. It does not represent an on-the-ground survey and represents only the approximate relative location of property boundaries.

This product has been produced by the Housing and Planning Department for the sole purpose of geographic reference. No warranty is made by the City of Austin regarding specific accuracy or completeness.



City of Austin
Housing and Planning Department
Created on 3/8/2023, by: meekss

Future Land Use

| | | | |
|--|------------------------------|--|------------------------------|
| | Subject Tract | | Multifamily Residential |
| | Commercial | | Recreation & Open Space |
| | Higher-Density Single-Family | | Single-Family |
| | Mixed Use | | Specific Regulating District |
| | Mixed Use/Office | | Transportation |