



THE CREATIVE STUDIO
OF ARTIST **KEVIN MUÑOZ**

**ART IN PUBLIC PLACES
AFD STATION 22 / ATCEMS STATION 12
(EAST RIVERSIDE)**

**FINAL-DESIGN PRESENTATION
AUGUST 2023**

Community Engagement

AFD 22

United team.
Great morale

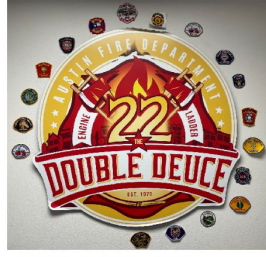

Thankful
community
for service

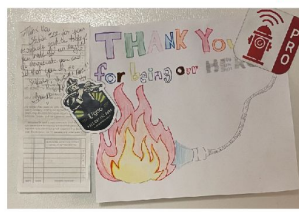
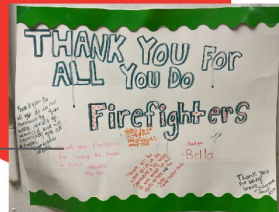

Lots of pride
in their call
numbers

I spent 16 hours with two crews at 22/12 and had a lovely experience on my ride outs, which were as informative as they were exhilarating.

I found a camaraderie among fire department 22 that I believe is only surpassed by their dedication to the community. It was inspiring to see the crew always working, learning, and in a moment's notice, out the door and on the engine to tend to the needs of others.

Community Engagement

ATCEMS 12

Ready at
moment's notice
to serve
community



Go from call
to call with
smiles on
their faces

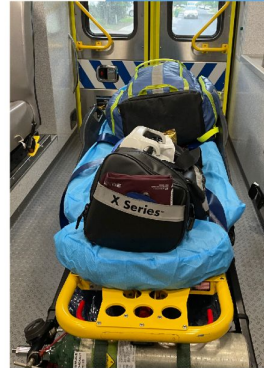

Like Fire, ATCEMS 12 were a pleasant bunch of folks putting their lives on the line day after day, shift after shift in order to tend to those in the community that need their help. This first hand experience helped inform the fence design I came up with.

Previous Design



Final Design & Site Rendering

The artwork will replace a section of the station's decorative fence facing East Riverside Dr. The art will be visible from both the street side and the building side. The art barrier is meant to provide privacy but it is also meant to fit seamlessly with the building and landscape design, as well as the neighborhood at large.



64' 10" x 8'



Galvanized Steel

Corten Steel

Stainless Steel

Painted Steel

Of service day and night

Community

Caring hands & Nature

22 River

Shooting star

12 Speed

Magic in the community

Nature Community

Austin / Portal to hill country

Of service day and night

Project Narrative

Public Art Concept:

The art barrier I have designed is made of different types of metals. The metals themselves vary in the way they appear and are meant to reflect the community as well as the AFD and ATCEMS's diversity.

Each element illustrated in negative space within the fence is a nod to either 22/12, the community itself, or the natural elements and landscapes that surround the building.

The hand drawn brush work that I used in the illustrations is a nod to the working class community that helped make the neighborhood what it is.

Site Location

Site Aerial View

The artwork will run east to west, parallel with East Riverside Drive in front of the new construction at AFD 22 ATCEMS 12.

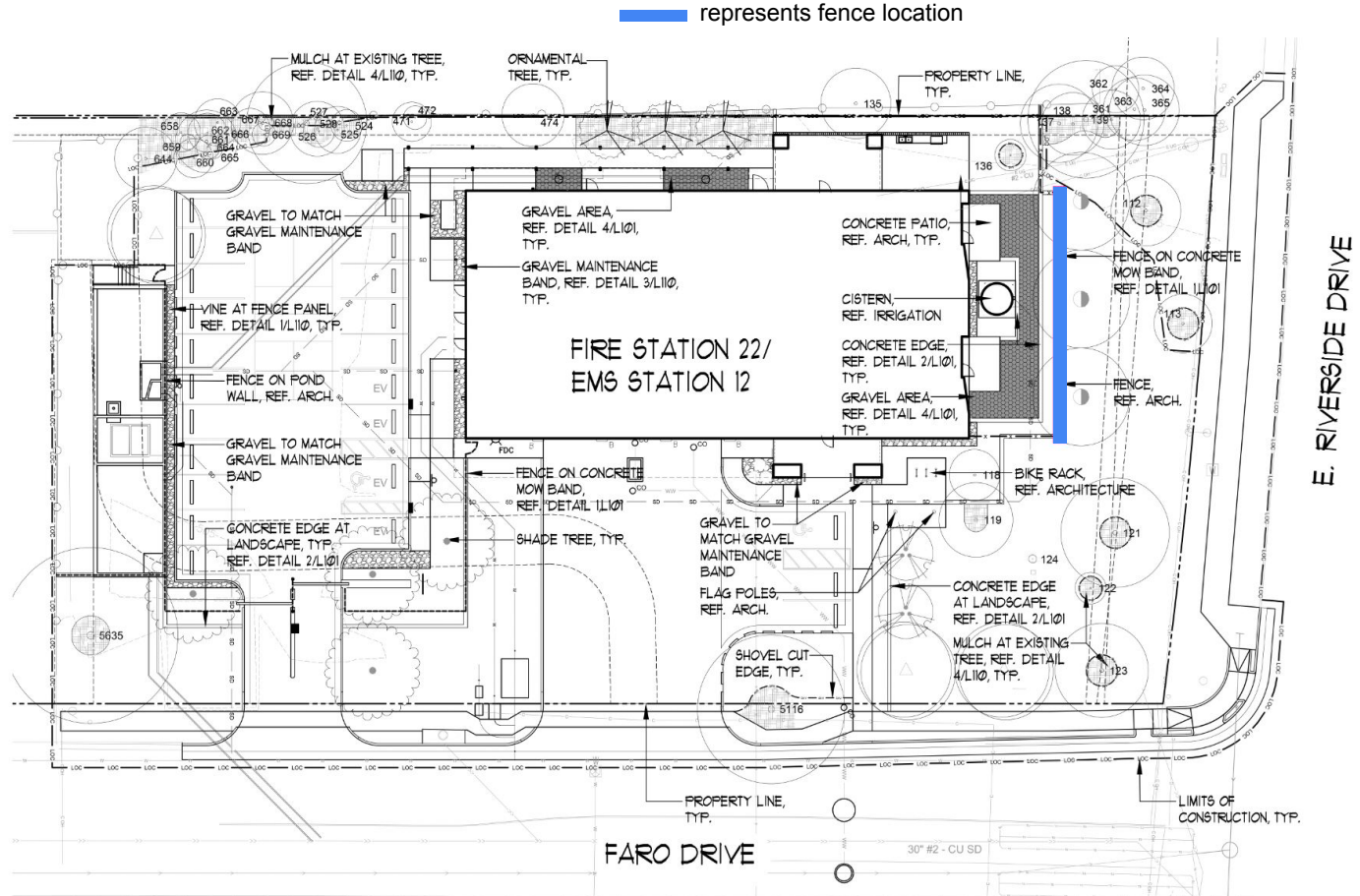

Structural Engineering

Site Aerial View

16 sheets of metal (5 corten steel, 7 carbon steel, 4 stainless steel) will be sourced and water jet cut along paths I have designed. My fabricator will then take 4 carbon sheets to be galvanized. 3 carbon sheets will be painted in black paint the other 9 (5 corten and 4 stainless steel) will remain as is. Once the galvanizing and painting is done, they will be installed to the custom made carbon steel vertical posts that will have been installed by embed plates on site where the foundation will have been poured.

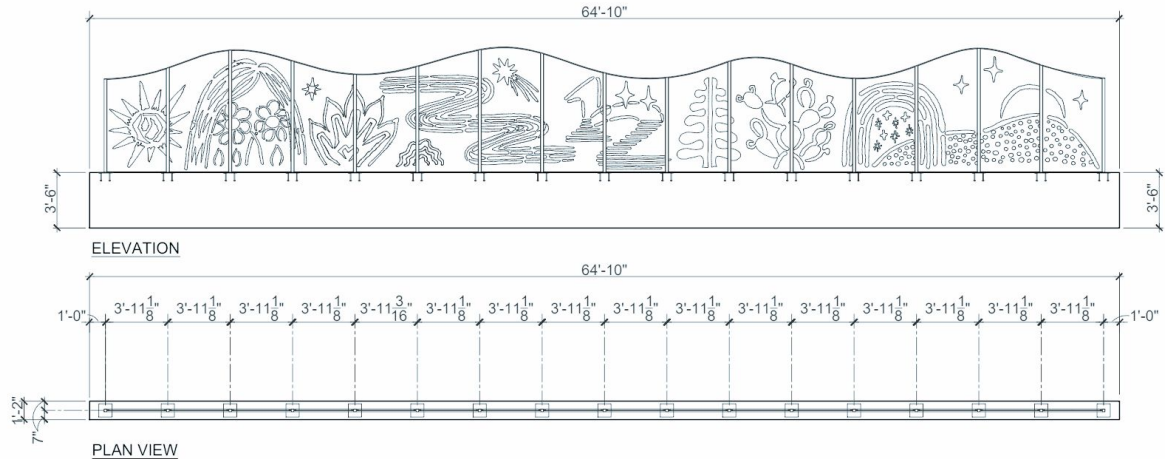

Base plates, the welded connections at the top of each post, and the contoured top bar connections will also be painted black.

1. FOOTING FOR "FIREHOUSE AIPP SCULPTURE"

SCALE: 3/16"=1'-0"

PLAN NOTES:

1. VERIFY MISCELLANEOUS SCULPTURE INFORMATION WITH SCULPTURE METAL SHOP DRAWINGS.
2. G.C. SHALL VERIFY DIMENSIONS WITH SHOP DRAWINGS AND SHALL NOTIFY ENGINEER OF DISCREPANCIES PRIOR TO CONSTRUCTION.
3. SEE SHEET S-2 FOR STRUCTURAL NOTES.
4. NOTIFY LOC 36 HOURS PRIOR TO PLACEMENT OF CONCRETE FOR A REBAR INSPECTION. FAILURE TO NOTIFY LOC FOR REBAR INSPECTION SHALL NEGATE ANY LIABILITY FOR THE PERFORMANCE OF THE FOUNDATION DESIGN.

Structural Engineering

Continued

Installation method will consist of simpson stud embed plates cast into concrete footers. Erecting vertical posts. All sheets assembled with welded tabs with EPDM gaskets and standard galvanized hardware.

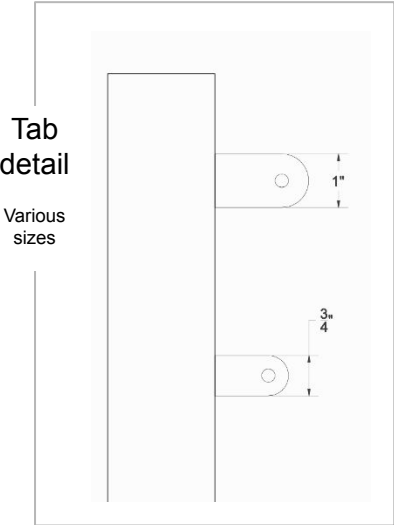

STRUCTURAL NOTES

DESIGN LOADS: 2021 IBC.

1. LIVE LOADS
A. SCULPTURE NA
2. DEAD LOADS
A. SELF WEIGHT OF SCULPTURE ELEMENTS
3. WIND LATERAL LOAD - ASCE / SEI 7-16 REQUIREMENTS, EXPOSURE C, V = 115 MPH (ULT.)

CONCRETE

1. ALL CONCRETE SHOULD BE STONE AGGREGATE CONCRETE UNLESS NOTED OTHERWISE. MINIMUM CONCRETE COMPRESSIVE STRENGTH WHEN TESTED AT 28 DAYS, SHALL BE 3000 POUNDS PER SQUARE INCH WITH A MAXIMUM 5" SLUMP.
2. REINFORCING STEEL SHALL BE DEFORMED NEW BILLET STEEL BARS IN ACCORDANCE WITH ASTM SPECIFICATIONS A615 GRADE 60.
3. TACK WELDING ON REINFORCING STEEL WILL NOT BE PERMITTED.
4. HEAT SHALL NOT BE USED IN THE FABRICATION OR INSTALLATION OF REINFORCEMENT.
5. REINFORCING STEEL COVERAGE SHALL BE AS FOLLOWS:
A) GRADE BEAMS- 1 1/2" TOP, 3" BOTTOM, 2" SIDE FORMED, 3" SIDE FORMED AGAINST EARTH

REQUIRED SPECIAL INSPECTIONS (Structural)

REQUIRED INSPECTION	REFERENCED STANDARD		SPECIAL INSPECTOR
1. STRUCTURAL STEEL:	SECTION 1705.2	AISC 360	
a. FIELD WELDING, HIGH-STRENGTH BOLTING		AISC 360	LOC STRUCTURAL
2. CONCRETE:	SECTION 1705.3		
a. INSPECTION OF REINFORCING STEEL PLACEMENT	ACI 318: 3.5, 7.1-7.7		LOC STRUCTURAL
b. INSPECTION OF ANCHORS CAST IN CONCRETE	ACI 318:		LOC STRUCTURAL

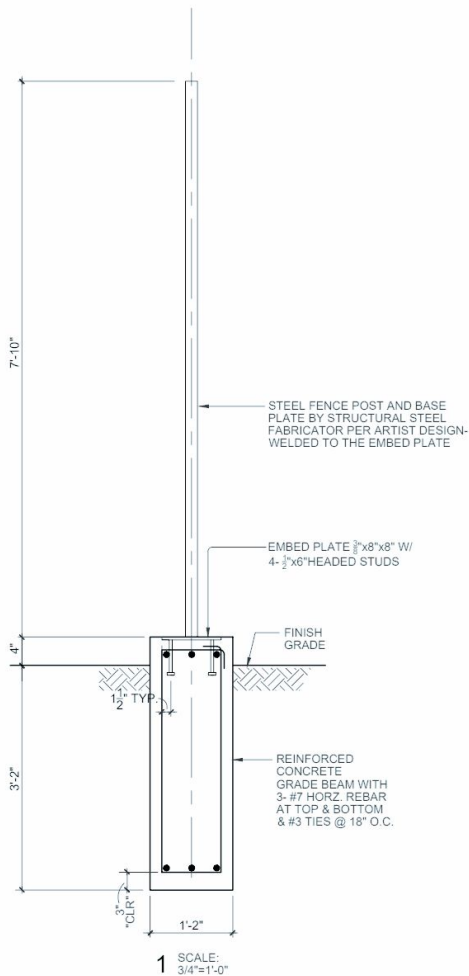

Materials Info

Material List:

1. Concrete footings with engineered rebar
2. (5) Corten steel sheet (12 gauge)
3. (4) A36 carbon steel sheet; hot dipped galvanized (steel in hot zinc 850°) (12 gauge)
4. (3) A36 carbon steel sheet (12 gauge)
5. (4) Stainless steel sheet (12 gauge)
6. Galvanized hardware; nuts and bolts
7. EPDM Gaskets between dissimilar metals
8. 1/2 inch steel embed plates with 6 inch by 1/2 inch simpson studs
9. 2"x2" & 3"x3" (ends) A36 carbon steel square tubing posts; capped steel on top
10. 100% Solids Epoxy Pre-Primer & Aliphatic Acrylic Urethane paint (black) - (3) A36 carbon steel sheet, contoured bars, all posts & welded tabs, base plates, welded connections
11. Aliphatic Acrylic Urethane paint (clear) - Corten & galvanized steel sheets

Maintenance:

The black steel sheets should be repainted every 20 years.

Regular cleaning with just water to prevent pollen and bird dropping build-up.

Semi-annual cleaning with a dilute detergent like (Ovus or Dawn) and cotton rag, followed by a thorough rise.

Schedule

Milestone	Project Completion Date
Conservation Review	June 2023
Final Design Submission / Approval	August 2023
Fabrication	September - December 2023
Installation	December 2023 - January 2024
Close Out	February 2024

Budget

CATEGORY	\$
SHOP DRAWINGS	\$2,450
MATERIALS + WATER CUTTING	\$21,350
FABRICATION	\$14,960
ENGINEERING	\$1,850
STAINLESS STEEL FINISHING	\$2,720
GALVANIZED FINISHING	\$1,500
INSURANCE	\$2,100
INSTALLATION	\$14,280
DESIGN FEE	\$14,000
PAINT	\$13,850
FOUNDATION	\$10,200
CONTINGENCY	\$4,963
TOTAL	\$104,223*

**Original AIPP artwork budget: \$70,000. Cost increase due to changes to artist scope and supply chain changes. Increase to keep project funded as designed has been approved by the sponsor departments.*

Thank You

Please reach out with any
questions or comments:

munoz.kevin@gmail.com
(714)797-3954