



# City of Austin

## Planning Department

P.O. Box 1088, Austin, TX 78767 -1088

(512) 974-3100 ♦ Fax (512) 974-3112 ♦ <https://www.austintexas.gov/department/housing-and-planning>

### MEMORANDUM

**TO:** Todd W. Shaw, Chair &  
Planning Commission Members

**FROM:** Maureen Meredith, Senior Planner, Inclusive Planning Division  
Nancy Estrada, Principal Planner, Current Planning Division  
Planning Department

**DATE:** September 19, 2023

**RE:** NPA-2023-0030.01.SH\_Mission South  
C14-2023-0007.SH\_Mission South  
711 Eberhart Lane  
South Austin Combined (Garrison Park) Neighborhood Planning Area

Staff requests a postponement of the above-referenced cases from the **September 26, 2023** Planning Commission hearing to the **October 10, 2023 hearing date** to allow staff additional time to review the applications.

The postponement request was made in a timely manner and meets the Planning Commission's policy.

Attachments: Plan Amendment Map  
Zoning Map

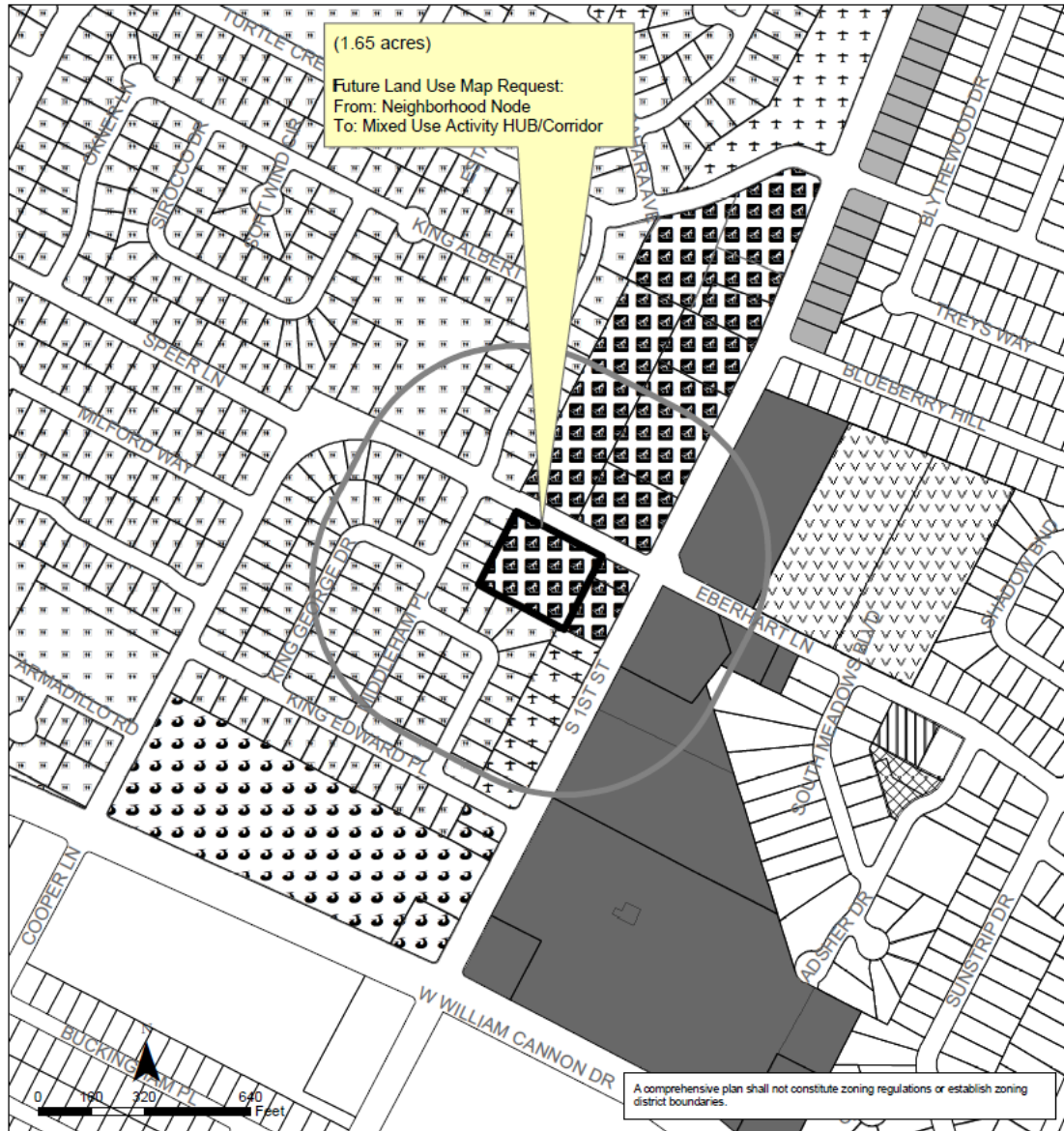

## South Austin Combined Neighborhood Planning Area NPA-2023-0030.01.SH

This product is for informational purposes and may not have been prepared for or be suitable for legal, engineering, or surveying purposes. It does not represent an on-the-ground survey and represents only the approximate relative location of property boundaries.

This product has been produced by the Housing and Planning Department for the sole purpose of geographic reference. No warranty is made by the City of Austin regarding specific accuracy or completeness.





City of Austin  
Housing and Planning Department  
Created on 2/6/2023, by: MeeksS

### Future Land Use

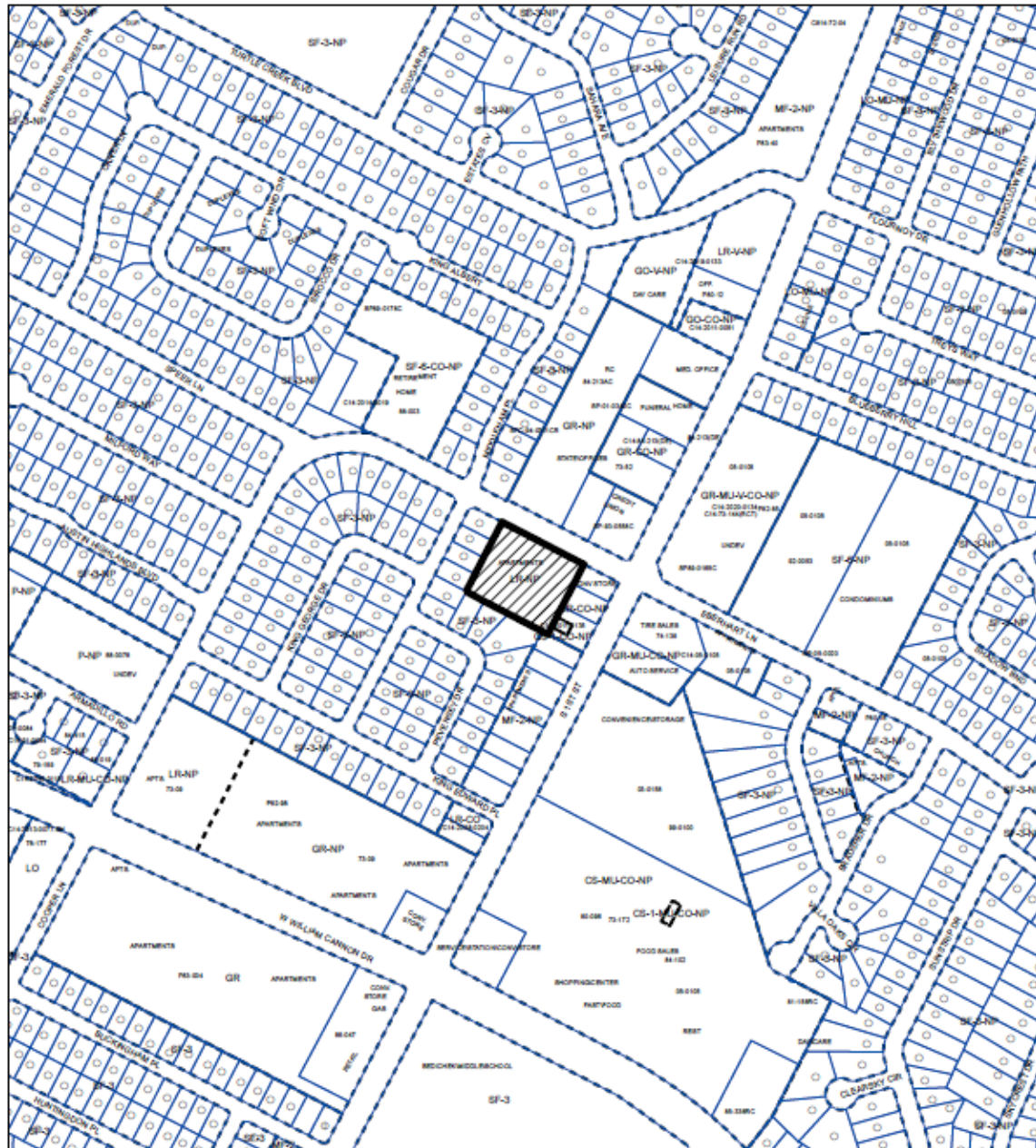
	Subject Tract		Civic
	500 ft. notif. boundary		Higher-Density Single-Family
	Neighborhood Node		Mixed Use
	Neighborhood Transition		Mixed Use/Office
	Residential Core		Multi-Family
	Mixed-use Activity Hub/Corridor		Single-Family

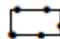

-  SUBJECT TRACT
-  PENDING CASE
-  ZONING BOUNDARY

1" = 400'

## ZONING

ZONING CASE#: C14-2023-0007.SH

This product is for informational purposes and may not have been prepared for or be suitable for legal, engineering, or surveying purposes. It does not represent an on-the-ground survey and represents only the approximate relative location of property boundaries.

This product has been produced by the Housing and Planning Department for the sole purpose of geographic reference. No warranty is made by the City of Austin regarding specific accuracy or



Created: 1/27/2023