

**HISTORIC LANDMARK COMMISSION  
DEMOLITION AND RELOCATION PERMITS  
NOVEMBER 1, 2023  
PR-2023-116387; GF-2023-118718  
4604 CRESTWAY DRIVE**

## **PROPOSAL**

---

Demolish a ca. 1957 house.

## **ARCHITECTURE**

---

The house at 4604 Crestway Drive is one and one-half stories in height, with a low-slope roof and deep eaves. It is clad in natural stone and vertical cedar siding. Fenestration includes aluminum ribbon and half-height sliders, full-height sliders, and full-height fixed windows. A first-floor carport, wide chimney, and stone retaining walls visually anchor the house to the hillside on which it is built.

## **RESEARCH**

---

4604 Crestway Drive was built in 1957 for Richard R. Hidell, Sr. Hidell, son of a Fort Worth hardware company founder, opened Hidell Builders Supply in Austin in the late 1940s. Though Hidell, Sr. retired in 1996, the company is still around today and supplies materials to contractors around the state.

Hidell was active in several charitable organizations, serving in leadership positions in numerous clubs. 4604 Crestway was built by Hidell's brother, William Henry Hidell, a well-known Mid-century Modern architect who studied under Dallas luminary George Dahl after a brief mentorship under Frank Lloyd Wright (and who purportedly used a Wright design as inspiration for his father's Austin residence).<sup>1</sup> William H. Hidell began his firm with Pete Decker as Hidell & Decker Architects in 1948, then practiced solo under William H. Hidell Architects in 1952. The firm was incorporated in 1979 as Hidell Architects, Inc., and operates today under Hidell & Associates Architects, with William Hidell III as the firm's principal and public library design as its focus.<sup>2</sup>

In a 2015 interview with Mary E. Hidell, Rick Hidell Sr.'s wife, she recounted the house's challenging and unique construction:

To build the house, they had to dynamite the cliff-side...and at that time there were only a couple of trees on the lot. Everything that you see currently was planted by the Hidells after taking up residence there. In the process of clearing the lot, they discovered a cave, which they had to fill in with concrete (it took 9 cement mixer loads) and that concrete became the foundation of the fireplace. The home is constructed with fieldstone that was from a fieldstone fence out in the country. Mr. Hidell purchased the whole fence and then had it taken apart and transported to the property to use in the home.<sup>3</sup>

## **PROPERTY EVALUATION**

---

### *Designation Criteria—Historic Landmark*

- 1) The building is more than 50 years old.
- 2) The building appears to retain high integrity.
- 3) Properties must meet two criteria for landmark designation (LDC §25-2-352). The property does not appear to meet two criteria:
  - a. Architecture. The building is a good example of mid-century Modern design, using natural materials and employing a design that responds to the site's topography, going so far as to be tied directly into the land at the concrete fireplace base extending down into a natural cave. It was constructed by Dallas architect William H. Hidell, a noted Modernist and student of George Dahl.
  - b. Historical association. The Commission may wish to consider the relationship between Hidell Builders' Supply, a longstanding Austin business, and the home's unique materials and construction. The Hidell family appears to have significant ties to the building and architecture industries in Texas.
  - c. Archaeology. The property was not evaluated for its potential to yield significant data concerning the human history or prehistory of the region.

---

<sup>1</sup> Interview with Ms. Mary Hidell, 2015, conducted by Comm. Trey McWhorter.

<sup>2</sup> <http://www.hidell.com/about.html>

<sup>3</sup> McWhorter, 2015.

- d.* Community value. The property does not appear to possess a unique location, physical characteristic, or significant feature that contributes to the character, image, or cultural identity of the city, the neighborhood, or a particular demographic group.
- e.* Landscape feature. The property may be a significant natural or designed landscape with artistic, aesthetic, cultural, or historical value, given the deliberate planting and topographical modifications used by the Hidells when “sculpting” the house and its surroundings.

---

**STAFF RECOMMENDATION**

Consider initiation of historic zoning. Should the Commission decide against initiation, strongly encourage rehabilitation and adaptive reuse, then deconstruction and reuse of materials, but release the demolition permit upon completion of a City of Austin Documentation Package.

# LOCATION MAP

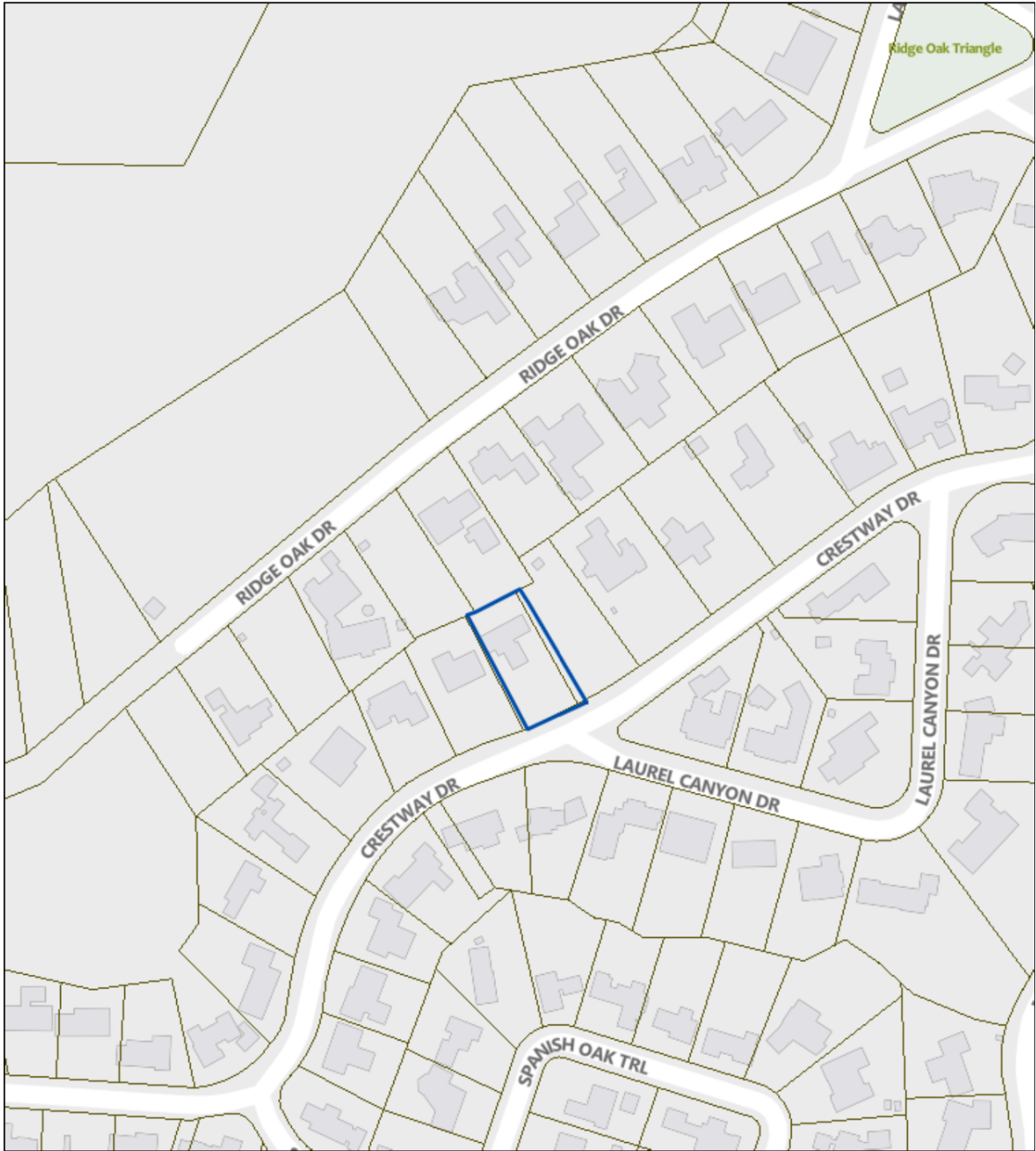

1: 2400

Lot Lines  
Lot Line

**GF 23-118718**

4604 CRESTWAY DRIVE



9/20/2023

This product is for informational purposes and may not have been prepared for or be suitable for legal, engineering, or surveying purposes. It does not represent an on-the-ground survey. This product has been produced by the City of Austin for the sole purpose of geographic reference. No warranty is made by the City of Austin regarding specific accuracy or completeness.

**PROPERTY INFORMATION***Photos*



*Demolition permit application, 2023*

*Historical Information*

*City directory research was not available for this property.*

## **Congratulations**

on the completion of the modern  
Educational Building of

## **Hyde Park Baptist Church**

**Best wishes for continued growth and progress  
builders hardware by**

**Hidell Builders Supply Co.**

**5907 Burnet Road**

**HO 5-0430**

*The Austin American (1914-1973); Austin, Tex.. 05 Oct 1958: A22.*



Rick Hidell helps his mother into their Arkansas Traveler while his father, Dick Hidell, waits to pull out of the docks.

Rick and his friends use the boat more than his parents. The Hidells live at 4604 Crestway.

## Tennis Courts Contract Let

Awarding of a contract to A.C. Bryant for construction of tennis courts on the grounds of the Westwood Country Club was announced Tuesday following a meeting of officers and directors of that organization.

Sterling Sasser Jr., newly named president of the club, announced they will be double courts with practice backboards and will be standard size to handle tournament matches.

The Bryant contract was the first official action of the new officers and directors who are Sasser, president; A. E. Cornwell, vice president; Dick Hidell, secretary; and Gordon McNutt, Charles D. Nash, Dr. Milner Thorne, Roland Roessner, Louis F. Shanks, David R. Wilson, Morgan Pearce, Claude Campbell, Tom Graham, John Vaught, Clarence McCullough and George Riffin.

*Austinites Enjoy Boating With Two Lakes in Town. The Austin American (1914-1973); 23 July 1961: E9.*

*Tennis Courts Contract Let. The Austin Statesman (1921-1973); 07 Nov 1961: A21*

# CONGRATULATIONS

TO

## PHARMAFAC

Manufacturers of Quality Pharmaceuticals

10214 NORTH INTERREGIONAL HIGHWAY

To Austin's newest industry, we offer our congratulations and very best wishes on the occasion of the completion of their new, ultra-modern plant and office facilities. This occasion is another milestone in the development of our Central Texas Community.

**RHEA MERRITT, Contractor**

SCHEUMACK BROS., Builders MIDWEST ROOF & DECK SUPPLY NOZICK ELECTRIC COMPANY LYNN'S TV TROY LOVELL, Floor Contractor HOLIDAY AIR CONDITIONING HOLIDAY PLUMBING CHESTER HEEP, Plastering JAKE MEARS, Cement Contractor ALAMO STEEL R. A. OBENHAUS CO. DON FLETCHER, Tanners ELGIN STANDARD BRICK CO.	GRAPHIC ARTS LITHO SUPPLY GEORGE COX GLASS CO. ACME GLASS CO. REESE LUMBER CO. RAWLS LUMBER CO. STRIPLING-BLAKE LUMBER CO. PAT CANON, Paving & Excavating SOUTHERN UNION GAS CO. CAPITAL CITY OFFICE OUTFITTERS WINETRAUB INSURANCE AGENCY AUSTIN NATIONAL BANK FIRST FEDERAL SAVING & LOAN	FINE PAPERS, INC. LAMBERT PAINT CO. HARGIS-AUSTIN CO. SHANBLUM SUPPLY CO. HIDELL BUILDERS SUPPLY SOUTHERN ELECTRIC SUPPLY FRANK BRYANT TESTING LABORATORIES TEX BERRY CONTAINERS CORPORATION E. H. SARGENT CO. ATLAS CHEMICAL CO. BELL BOTTOM FOUNDATION CO. TEX BERRY CONTAINERS CORPORATION CAPITAL AGGREGATES
---	--	--

# HIDELL

**BUILDERS SUPPLY, INC.**

**Suppliers of Quality Builders Hardware**

**Lockwood Locks For The Crest Hotel**

**8613 BURNET RD. AUSTIN, TEXAS HO 5-7692**

*The Austin Statesman (1921-1973); 14 May 1962: 6.*

*The Austin American (1914-1973); 23 Jan 1966: E7.*

# Austin Junior Miss Pageant Underway

The Austin Junior Miss Pageant, sponsored by the Austin Jaycees, got under way Sunday afternoon as 35 local high school girls competed for the judges' votes in two of four categories.

The annual pageant tested the girls on talent and poise and appearance Sunday, leaving their scholastic records to be judged by a computer and their personalities to be judged in a "judges' conference."

The competition was at Municipal Auditorium. The second part of the pageant — the naming of the winners — will be at Municipal Auditorium Dec. 10, according to Rick

Hidell, director of public relations for the Jaycees.

The 1971 Austin Junior Miss will inherit the crown from Miss Kay Smith, 18, a freshman at the University of Texas. Along with the title will go an approximately \$400 cash scholarship, Hidell said.

The first and second place winners will each receive \$100 cash scholarships. The winner of each category will receive a \$50 savings bond, according to Hidell.

No winners will be announced until Dec. 10. At that part of the pageant, the winners of the four different categories will be announced, the top 10 finalists will be named and the top five performers will entertain, Hidell said. The winner and the two runners-up will then be named.

*Austin Junior Miss Pageant Underway. The Austin Statesman (1921-1973); 30 Nov 1970: 47.*

# Attorney To Head New Jaycee Slate

Phil Gilbert, an Austin attorney, will head the slate of officers for 1971-72 for the Austin Junior Chamber of Commerce.

In addition to Gilbert, new officers elected Wednesday are Tom Bergstrom, Capital National Bank, first vice president; Wayne Mathews, National Western Life Insurance Co., second vice president; Charles Cantwell, Leif Johnson Ford, third vice president; Harold Broadbent, State Health Department, secretary; and Capt. Earl Morgan, Bergstrom AFB, treasurer.

Those named to the board of directors are Rick Hidell, Builders Supply; Dick Waite, First Federal Saving & Loan; Dan Torres, Whitley Printing Co.; David Monk, New York Life Insurance Co.; Mike Miller, Texas Instruments; Jim McMurtry, Austin attorney; Mike Womack Life & Casualty.

Others are Gib Blaerman, National Western Life Insurance Co.; Tim Callaway, Mutual Savings Loan; Jack Cartwright, Decision Dynamics; Dan Gardner, Glastron Boat Co.; and Jack Kreins, American National Insurance Co.

*Attorney To Head New Jaycee Slate. The Austin Statesman (1921-1973); Austin, Tex.. 01 May 1971: 13*

Richard Robinson "Dick" Hidell, also affectionately known to many as "Pop", passed away peacefully April 21, 2009 at the age of 88, in the comfort of his own bed. He was born in Ft. Worth, Texas on December 2, 1920. He led a full and successful life. Dick graduated from Woodrow Wilson High School and then graduated from Texas A&M University in 1943. He was a member of the Century Club as well as the Reveille Club and was a lifelong fan of the Texas A&M football team. He was a veteran of WWII, a bronze star recipient, great-grandson of William Henry Hidell, the secretary of Alexander Stephens, Vice President of the Confederacy, charter member of Highland Park Baptist Church, a Mason, member of the Headliners Club and involved with the Rotary Club, Optimist Club, as well as an avid pilot who loved all the instrumentation involved. His father started Hidell Hardware in 1924 and "Pop" came to Austin in 1948 to start Hidell Builders Supply, Inc. In 1996 he retired and his son took over the business. He was preceded in death by his parents, his brother Williams H. Hidell, Jr. and his wife, Charles Curfman Hidell. He is survived by his present wife, Mary Epperson Hidell, his son, Richard R. "Rick" Hidell, Jr., sister Marie Hidell Finley, grand-daughters Jacqueline M. Hidell, Vanessa Hidell Golden, and two great-grandchildren, as well as Mary's daughters, Laura Syler and Amy Curl. Services will be held at Weed-Corley-Fish Funeral Home, 3125 N. Lamar, and the family will have visitation on Monday, April 27, 2009 from 6:00 to 8:00 p.m. and the service on Tuesday, April 28, 2009 at 2:00 p.m., with burial at Austin Memorial Park following the service. Pallbearers will be Daryl Bone, Wayne Courreges, Johnnie Ray, Mack Ellis, Bill Morgan and John Robinson. Honorary pallbearers are Brooks Cofer, Raymond Hohertz, Warren Pitcher, Jay Davis, Art Haws, Len Layne, and Bill Von Rosenberg. In lieu of flowers, donations may be made to the Capital City A&M Club, Scholarship Fund, P.O. Box 332, Austin, TX 78766 or the charity of your choice.

<https://www.dignitymemorial.com/obituaries/austin-tx/richard-hidell-8212338>

### **William Hidell Obituary**

**H**idell, William William Henry Hidell, born Nov 6 1916, died at home April 15 2009 Bill was a graduate of Woodrow Wilson high school, and then Texas A & M University with a Degree in Architecture in 1941. Upon graduation he married Margaret Trimble, and went directly into the service as a pilot in the army air corp. A survivor of Pearl Harbor, he returned to Dallas after WW2 where he practiced architecture, retiring in 1982. Bill was an avid sailor and model train enthusiast. Bill is survived by Peg, his wife of 68 yrs, children Bill Hidell and wife Lynn, Peggy Dickson, grandchildren Will and Kyle Hidell, Molly and Lindsey Dickson, great granddaughter Berlin Hidell. A memorial service and reception will be held at St Luke's Episcopal church on 5923 Royal Ln Fri April 24 at 2:00 pm.  
Published by Dallas Morning News on Apr. 22, 2009.

*Dallas Morning News, 2009.* <https://obits.dallasnews.com/us/obituaries/dallasmorningnews/name/william-hidell-obituary?id=24409810>

Resident: Mary Epperson Hidell (current occupant is Rick Hidell, her stepson)  
 Address: 4604 Crestway Dr  
 Date: 1/9/2015

Contact Info: Mary Hidell, [REDACTED] (She lives in Arboretum area)  
 Rick Hidell, [REDACTED] (currently lives in the home)

### **The People**

The Hidell family was involved in the construction supply / lumber supply business. They had moved from Germany and changed their name from Heidel to Hidell and opened a store. Mr. Hidell's Dad had a store in Dallas and when Mr. Hidell returned from the war (served in army in WWII) he worked for him for a while.

Mr. Hidell wanted to have his own store, so moved to Austin and opened Hidell Lumber on Burnet Rd. He was married to Mrs. Hidell, but she later died. They were charter members of Highland Park Baptist Church.

Mary Epperson and her husband were friends with the Hidells and when her husband died (Mr. Hidell's wife died first), Mr. Hidell later asked Mary to marry him (1991). Mary has two daughters, and she is now 86 years old.

Mr. Hidell died in 2009, and his son, Rick Hidell (68 yrs old) continues to run the business "Hidell Builders Supply", still located on Burnet Rd.

### **The House & Architect**

Mr. Hidell's brother was William Henry Hidell (<http://www.legacy.com/obituaries/dallasmorningnews/obituary.aspx?n=william-hidell&pid=126494871>), as well as described as a protégé of George Dahl (most famous Dallas architect) and he had an architecture degree from Texas A&M. He mentored under Frank Lloyd Wright early in his career, and apparently the design of 4604 Crestway is a copy of a Frank Lloyd Wright design. There continues to be a Hidell architecture firm in Dallas, now run by William Hidell III and William Hidell IV.

To build the house, they had to dynamite the cliff-side to make an area for it, and at that time there were only a couple of trees on the lot. Everything that you see currently was planted by the Hidells after taking up residence there.

In the process of clearing the lot, they discovered a cave, which they had to fill in with concrete (it took 9 cement mixer loads) and that concrete became the foundation of the fireplace. The home is constructed with fieldstone that was from a fieldstone fence out in the country. Mr. Hidell purchased the whole fence and then had it taken apart and transported to the property to use in the home. An elevator was later added after Mr. Hidell had a fall and could no longer navigate some steps in the house.

*McWhorter, Trey. Interview with Mary E. Hidell, 2015.*

## Permits

R.R. Hidell

4604 Crestway Dr

283

3

R

Resub Lots 1-5 Block r Highland Park West

Stone Veneer and Rock Res and Garage <sup>Under</sup>

65746

1-30-57

25000.00

Douglas Hicks

10

On premises

26845

*Building permit, 1957*