

ORDINANCE NO. _____

AN ORDINANCE REZONING AND CHANGING THE ZONING MAP FOR THE PROPERTY LOCATED AT 2101 TRAVIS HEIGHTS BOULEVARD, IN THE GREATER SOUTH RIVER CITY COMBINED NEIGHORHOOD PLAN AREA, FROM FAMILY RESIDENCE-NEIGHBORHOOD PLAN (SF-3-NP) COMBINING DISTRICT TO FAMILY RESIDENCE-HISTORIC LANDMARK-NEIGHBORHOOD PLAN (SF-3-H-NP) COMBINING DISTRICT.

BE IT ORDAINED BY THE CITY COUNCIL OF THE CITY OF AUSTIN:

PART 1. The zoning map established by Section 25-2-191 of the City Code is amended to change the base district from family residence-neighborhood plan (SF-3-NP) combining district to family residence-historic landmark-neighborhood plan (SF-3-H-NP) combining district on the property described in Zoning Case No. C14H-2023-0085, on file at the Planning Department, as follows:

LOT 9, BLOCK 36, TRAVIS HEIGHTS, a subdivision in Travis County, Texas, according to the map or plat thereof as recorded in Volume 3, Page 15 of the Plat Records of Travis County, Texas (the "Property"),

generally known as the Burks-Challstrom House and locally known as 2101 Travis Heights Boulevard, in the City of Austin, Travis County, Texas, generally identified in the map attached as **Exhibit "A"**.

PART 2. Except as specifically modified by this ordinance, the Property is subject to Ordinance No. 20050929-Z003 that established zoning for the South River City Neighborhood Plan.

PART 3. This ordinance takes effect on _____, 2023.

PASSED AND APPROVED

_____, 2023 §
 §
 § _____

Kirk Watson
Mayor



APPROVED: _____ **ATTEST:** _____
Anne L. Morgan Myrna Rios
City Attorney City Clerk

EXHIBIT A

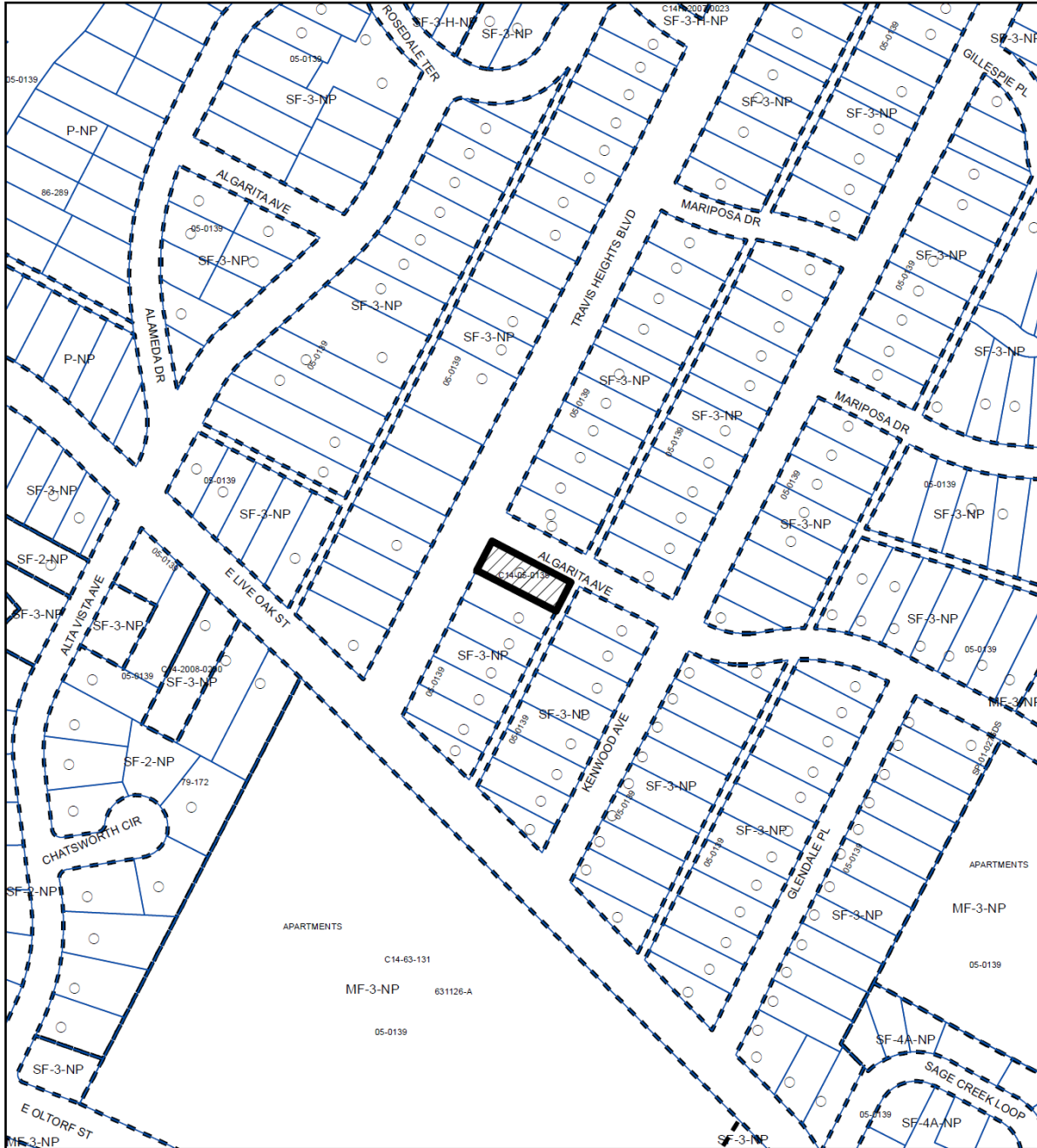
LOCATION MAP



1" = 200'

-  SUBJECT TRACT
-  PENDING CASE
-  ZONING BOUNDARY

HISTORIC ZONING

ZONING CASE#: C14H-2023-0085

This product is for informational purposes and may not have been prepared for or be suitable for legal, engineering, or surveying purposes. It does not represent an on-the-ground survey and represents only the approximate relative location of property boundaries.

This product has been produced by the Housing and Planning Department for the sole purpose of geographic reference. No warranty is made by the City of Austin regarding specific accuracy or

