



# City of Austin

## Planning Department

P.O. Box 1088, Austin, TX 78767 -1088

(512) 974-3100 ♦ Fax (512) 974-3112 ♦ <https://www.austintexas.gov/department/housing-and-planning>

### MEMORANDUM

**TO:** Claire Hempel, Chair &  
Planning Commission Members

**FROM:** Maureen Meredith, Senior Planner, Inclusive Planning Division  
Planning Department

**DATE:** February 6, 2024

**RE:** NPA-2023-0002.01\_Christ Church Planning  
1001, 1005, 1010 E. 2<sup>nd</sup> Street; 206, 112 Medina Street and 105 San  
Marcos Street  
East Cesar Chavez Neighborhood Planning Area

The applicant requests a postponement of the above-referenced case from the **February 13, 2024**, Planning Commission hearing to the **March 26, 2024 hearing date** to allow time for the applicant to submit the associated zoning case.

The postponement request was made in a timely manner and meets the Planning Commission's policy.

Attachments: Victoria Haase's email  
Plan Amendment Map

**From:** Victoria

**Sent:** Monday, January 29, 2024 2:38 PM

**To:** Meredith, Maureen <Maureen.Meredith@austintexas.gov>; Ron Thrower

**Subject:** RE: Feb 13 PC - NPA-2023-0002.01 / Christ Church of Austin

External Email - Exercise Caution

Let's go with March 26<sup>th</sup>, please. I'll also be out for the week of March 11-15<sup>th</sup>.

Victoria Haase



[www.throwerdesign.com](http://www.throwerdesign.com)

512-998-5900 Cell  
512-476-4456 Office

Mail: P.O. Box 41957  
Austin, Texas 78704

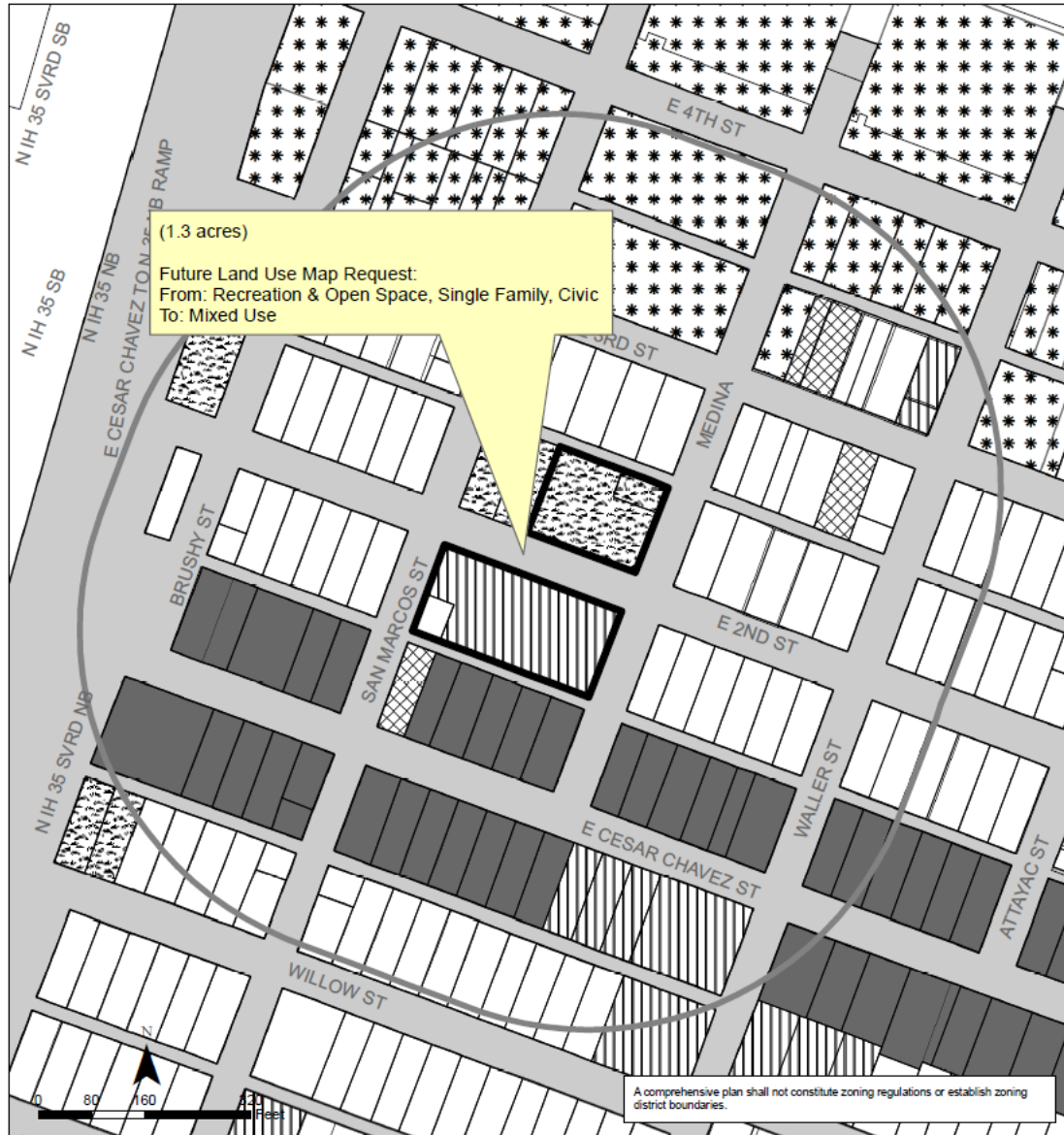

### East Cesar Chavez Neighborhood Planning Area NPA-2023-0002.01

This product is for informational purposes and may not have been prepared for or be suitable for legal, engineering, or surveying purposes. It does not represent an on-the-ground survey and represents only the approximate relative location of property boundaries.

This product has been produced by the Housing and Planning Department for the sole purpose of geographic reference. No warranty is made by the City of Austin regarding specific accuracy or completeness.



City of Austin  
Housing and Planning Department  
Created on 8/1/2023, by: meekss

#### Future Land Use

	Subject Tract		Recreation & Open Space
	500 ft. notif. boundary		Single-Family
	Civic		Specific Regulating District
	Mixed Use		Transportation
	Multi-Family		