

ORDINANCE NO. \_\_\_\_\_

AN ORDINANCE AMENDING ORDINANCE NO. 040513-30, WHICH ADOPTED THE BRENTWOOD/HIGHLAND COMBINED NEIGHBORHOOD PLAN AS AN ELEMENT OF THE IMAGINE AUSTIN COMPREHENSIVE PLAN, TO CHANGE THE LAND USE DESIGNATION ON THE FUTURE LAND USE MAP FOR PROPERTY LOCATED AT 410 AND 412 KENNISTON DRIVE.

BE IT ORDAINED BY THE CITY COUNCIL OF THE CITY OF AUSTIN:

**PART 1.** Ordinance No. 040513-30 adopted the Brentwood/Highland Combined Neighborhood Plan as an element of the Imagine Austin Comprehensive Plan.

**PART 2.** Ordinance No. 040513-30 is amended to change the land use designation for the property located at 410 and 412 Kenniston Drive from higher density single family to multifamily residential on the future land use map attached as **Exhibit "A"** and incorporated in this ordinance and described in File NPA-2023-0018.005 at the Planning Department.

**PART 3.** This ordinance takes effect on \_\_\_\_\_, 2024.

**PASSED AND APPROVED**

\_\_\_\_\_, 2024      §  
   §  
   §

Kirk Watson  
Mayor

**APPROVED:** \_\_\_\_\_ **ATTEST:** \_\_\_\_\_

Anne L. Morgan  
City Attorney

Myrna Rios  
City Clerk

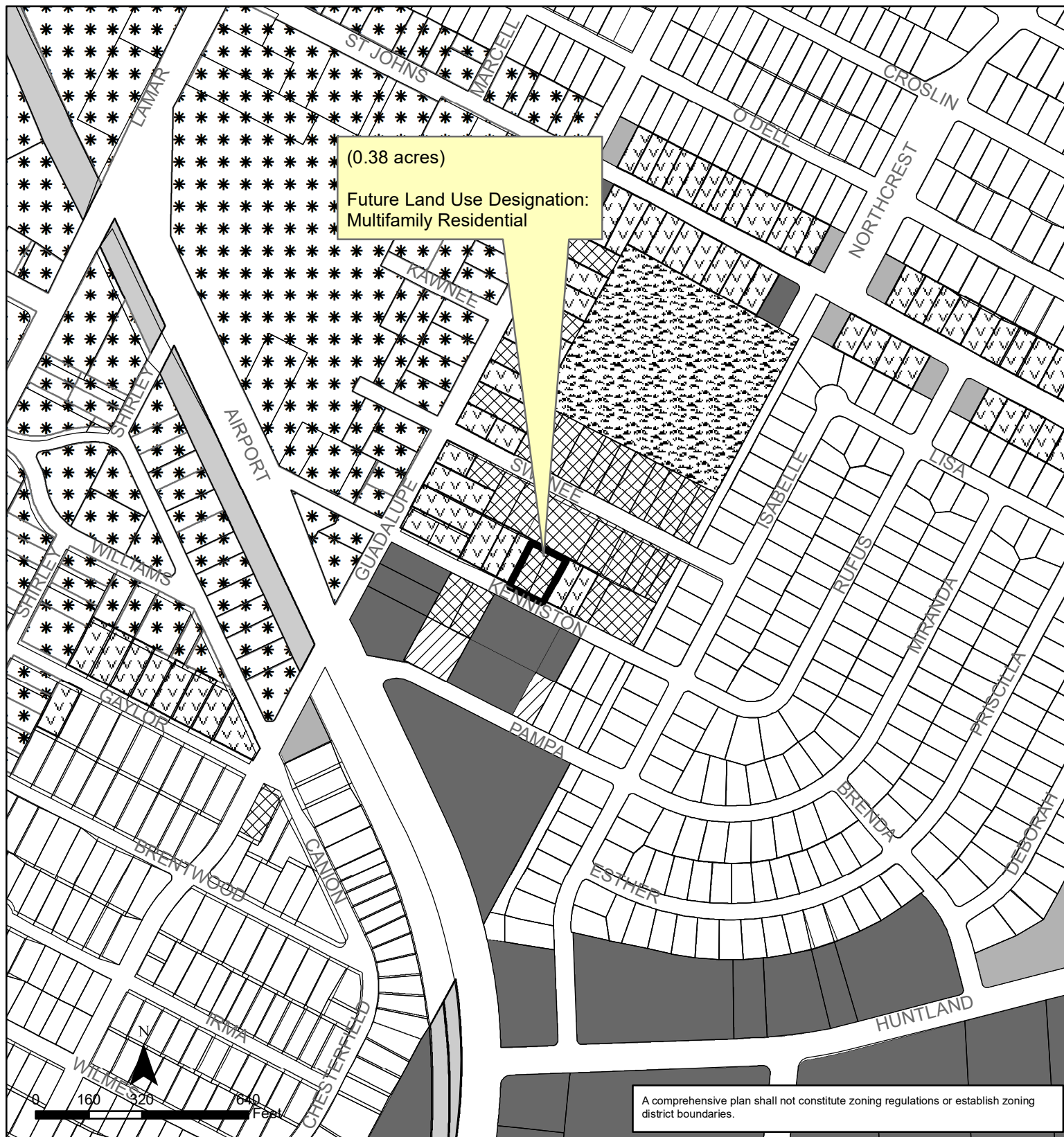

## Exhibit A

### Brentwood/Highland Combined Neighborhood Planning Area

#### NPA-2023-0018.05

This product is for informational purposes and may not have been prepared for or be suitable for legal, engineering, or surveying purposes. It does not represent an on-the-ground survey and represents only the approximate relative location of property boundaries.

This product has been produced by the Planning Department for the sole purpose of geographic reference. No warranty is made by the City of Austin regarding specific accuracy or completeness.



City of Austin  
Planning Department  
Created on 10/18/2023, by: meekss

#### Future Land Use

	Subject Tract		Multi-Family
	Commercial		Recreation & Open Space
	Higher-Density Single-Family		Single-Family
	Mixed Use		Specific Regulating District
	Mixed Use/Office		Transportation