



Budget Request

Subject: Request for Budget Allocation for Lawn Maintenance at the Historic Bethany Cemetery

Dear African American Resource Advisory Commission,

I am writing to request your consideration for a budget allocation dedicated to lawn maintenance for Austin's first African American cemetery.

A well-maintained lawn contributes significantly to the overall preservation of this unique and historical space. As we strive to restore the grounds and record the history of the cemetery, we are reaching out to create partnerships with community stakeholders who are committed to preserving the history of East Austin. We must invest in saving the few remaining landmarks that remain in the city.

Our goal is to preserve Bethany Cemetery, despite the new developments that are moving in, and the regular maintenance of the grounds is an integral part of the process. However, without regular maintenance, it is susceptible to deterioration, which could adversely impact our mission.

I am confident that the proposed budget allocation for lawn maintenance will yield significant returns in terms of improved aesthetics, enhanced functionality for visitors to the site, and prolonged lifespan of the historic headstones. Moreover, it aligns with our commitment to excellence and responsible stewardship of this educational and historical community resource.

We propose allocating funds toward the following essential maintenance services:

- Lawn Mowing: Regular mowing is essential to control the height of the grass to promote healthy growth and enhance the overall appearance of the cemetery.
- Fertilization and Weed Control: Proper fertilization and weed control measures are necessary to nourish the grass and prevent weed infestation.
- Seasonal Cleanup: Periodic cleanup activities, including leaf removal and debris clearing, are necessary to maintain a tidy and inviting outdoor environment.

By allocating resources to these maintenance tasks, we can preserve the integrity of the cemetery to maximize our preservation efforts, and promote its use to educators, and visitors to our city as well as all stakeholders.

Thank you for considering this request. If you require any further information or clarification, please do not hesitate to contact me. Your support in this matter is appreciated.

Sincerely,

Sue Spears-Martin

President, Bethany Cemetery of Austin

(512) 300-3675

Bethanycemeteryofaustin@gmail.com

Bethany Cemetery Association of Austin



Budget Request

Description: Funding Request for Lawn Maintenance for the Historic Bethany Cemetery, located at 1308 Springdale Road in Austin, Texas. This request would include but is not limited to cutting the 6.3-acre lot, trimming, and edging all trees, grave markers, and fencing. Cutting and treating weeds to maintain a well-manicured appearance. Seasonal leaf removal and removal of all debris associated with lawn maintenance and any illegal dumping that may be present.

This maintenance request is for twelve (12) months or a one-year season.

Date	March 4, 2024
Submitted by	Bethany Cemetery Association of Austin - Sue Spears
Phone	512-300-3675
Email	BethanycemeteryofAustin@gmail.com
Address	7318 Colony Park Drive, Austin, Texas 78724

DESCRIPTION OF BUDGET ITEM	AMOUNT	RATE	SUBTOTAL
MOWING: The contractor shall mow the grass every thirty (30) days, or as weather permits to maintain an appropriate height for the season to ensure a well-manicured and healthy appearance. Twelve (12) routine cuttings during normal growing season.	\$1200.00	\$200.00 Per acre (6.3acres) <i>1 cut per month or determined by seasonal growth</i>	\$14,400.00
LEAF REMOVAL: The contractor shall remove leaves during seasonal shedding (October-January) or until trees have dropped all foliage. Leaves shall be removed from the property and discarded in an offsite facility	\$300.00	Bags and Removal Fee	\$300.00
CLEAN-UP AND TRASH REMOVAL: The contractor shall remove all debris associated with the lawn maintenance during each visit. The property will be inspected for all illegal dumping and items disposed of as needed and on scheduled Clean-up days.	\$700.00	As Needed & Spring, Fall and Winter clean-up days	\$700.00
FERTILIZATION TREATMENT AND WEED CONTROL: Contact application treatment during peak germination period	\$150.00	\$150.00 Per acre (6-acre lot)	\$900.00
ADMINISTRATIVE FEE: Supporting operations and point of contact, record keeping, and organizing triannual clean-ups and general administration duties.			\$4000.00 To Bethany Cemetery Association
TOTAL OF REQUEST			\$20,300. 00

Funds are requested to support the annual maintenance for Bethany Cemetery to protect the integrity of this valuable historic resource and to prevent potential harm to grave markers as we rehabilitate and preserve it for future generations.

Subject: Request for Budget Allocation for Historical Documentation and Interpretive Signage

Dear African American Resource Advisory Commission,

I am writing to request your consideration for a budget allocation dedicated to Historical Documentation and Interpretive Signage for Bethany Cemetery, Austin's first African American cemetery.

Our goal is to transform Bethany Cemetery into a dynamic and valuable tourist destination in Austin. We envision the cemetery as a place that not only preserves the history of Austin's African American community but also as an educational and cultural resource for the city of Austin.

This project will help to enrich the visitor experience. The budget will help fund the installation of interpretive signage and kiosks throughout the cemetery. These additions will facilitate guided and self-guided tours, allowing visitors to explore the cemetery's history and significance at their own pace.

Interpretive signage will play a crucial role in communicating the significance of the cemetery, providing historical context, and fostering a deeper understanding to promote awareness and understanding of the cemetery's history. It will educate visitors about the individuals buried in the cemetery, their contributions, and their challenges.

Interpretive signage will also serve as a visual aid, enhancing the learning experience, that will engage participants in the historical context of the cemetery, the stories of those laid to rest, and the importance of preserving these sacred grounds.

We believe that investing in interpretive signage aligns with our commitment to providing an enriching and memorable experience for visitors while promoting cultural appreciation. The proposed interpretive signage project will yield significant benefits in terms of visitor engagement, education, and satisfaction. I am available to discuss this proposal further and address any questions or concerns you may have regarding the budget allocation.

Our goal is to honor the legacy of our ancestors, promote social equity, and create a lasting impact on preserving the African American heritage of Austin. We aim to foster a deeper connection between visitors and promote community stewardship and encourage appreciation for the heritage and diversity of our community. The funding will enable us to preserve the significance of Bethany Cemetery and its role as a vibrant educational and cultural resource for the community and visitors alike. It will acknowledge the rich history of the cemetery and its profound contributions to Austin's heritage.

Thank you for considering this request. If you require any further information or clarification, please do not hesitate to contact me. Your support and consideration in this matter is appreciated.

Sincerely,

Sue Spears-Martin

President, Bethany Cemetery of Austin

(512) 300-3675

Bethanycemeteryofaustin@gmail.com



ITEM	DESCRIPTION	UNIT PRICE
Design and Content Creation: Create a custom outdoor design with information to engage visitors; Layout development and interpretive text. Graphic design services Content creation (research and writing) All information must be cited/reviewed for accuracy. <ul style="list-style-type: none"> Some research may be done by student researchers. 	Proofs of each unique panel layout, images cropped from full-sized panel layouts Graphic Layout and Interpretive Text. Development of the QR Codes (15ct) *See tentative list of names (attached)	\$6,600.00
Installation: Hiring someone to install the signs and QR Code Panels. This could include site preparation, installation & In-ground, mounting hardware,	Mounting- Double Post Pedestals, - 12x12 MOUNT PLATE, 3x3 POST 60" LONG IN-GROUND MOUNT ID Stakes Mounts installed (15ct)	\$3,200.00
ITEMS: Two (2) Double Pedestal Exterior Single Sided Panels (6.000 SQ FT) Fifteen (15) - Exterior ID Stakes Pedestal (used for QR Codes)		\$10,000
Contingency: Fund for unexpected expenses or revisions to the design and additional materials needed. Shipping & Handling		\$1200.00
Administrative Fee: Project Administrator: Oversee the project, from the design stage to installation. Work with graphic designers/researchers and read and approve the wording of each sign and QR code. The supervision of placements and installation of each sign. Documenting and handling project budget.		\$2000.
Total Budget Request		\$23,000

Recommended Names for QR Code Consideration

1. Winfield Johnson: (1851-1938) was a teacher and a soldier. He enlisted in the 10th Colored Infantry. A segregated African American unit, the 10th Cavalry was one of the original "Buffalo Soldier" regiments in the post-Civil War Regular Army.
2. John Henry "Doc" Reeves (1895-1914) son of freed slaves who was a beloved figure during the early years of the University of Texas Athletics. Served as team trainer, masseuse and assisted with medical issues for UT teams.
3. Frances Jane Ridge: (1843-1925) Slave of Louis Horst, Plantation owner whose land is now where the University of Texas now sits. After slavery, she worked as a cook at the Stephen F. Austin Hotel in downtown Austin, Texas. Frances and three of her sons are buried at Bethany.
4. James H Harrold: (1878-1934) The son of The Reverend James H. Harrold (1857 – 1934) who was the founder of the Mt. Olive Baptist Church after a meeting on a hillside, now known as Huston-Tillotson College.
5. Albert B Phillips: "A. B. Phillips was a man of many talents. He was a champion cowboy roper and worked as a porter at the chambers of the Texas Supreme Court. His mother, Annie Walton, was a slave and she is buried near him in Bethany.
6. Jack Dodson: (1866-1919) was one of the first black City employees. He worked for the water company and walked door to door collecting the water bills.
7. Fannie A McCulloch Driver: (slave Narratives) 1857-1938
8. Betty Robertson Coleman: (Slave Narrative)
9. Easter Pease: (Born-Unknown - 1893) Easter was purchased by Former Texas Governor and slaveholder Elisha M Pease for 540 dollars to work on his Austin Plantation (* Elijah Allen- Former Slave of Governor Pease)
10. Ruthie Taylor: born a slave, she was a practical nurse and midwife, she worked under a white doctor, Dr McCaleb. Under his supervision, she delivered many babies and performed surgery. In Brackenridge Hospital's Colored maternity ward,
11. Robert Jones: (1847-1932) Company F 104 United States Colored Infantry (African American Civil War Memorial in Washington DC- Plaque#C103/Film M589 roll49) Trade: Drayman/Ex-Soldier
12. Ellick Williams: Company 137th United States Colored Troops – born in Craven County North Carolina and was a laborer.
13. Calvin "Buck" Alexander: (1895-1931) Professional Baseball Player. He played in the Negro Leagues during the 1910s and 1920s. He worked as a porter in a restaurant in Austin, Texas, before pursuing a professional baseball career. He played the position of pitcher with the San Antonio Black Bronchos
14. George Carpenter: his occupation was as a barber. Worked at Harrison Barbershop
15. Henry Blair Jr. (1847-1960) A porter in the House (State Capital) for 53 years and an observer of Texas Politics. He was a friend to 18 governors and hundreds of members of the legislature.

Tentative list of names among many more to consider. This is a sample of the rich history that lies within the grounds of the historic Bethany Cemetery. The larger Signage will include The history of the cemetery.

Plant Stakes

In-Ground Mount All Aluminum Construction

> Standard Mount Plate Size

- ✓ 4" x 6"
- ✓ 2" x 4"
- ✓ 3" x 3"
- ✓ 1" x 3"
- ✓ 3" x 5"

In-Ground Mount:

- ✓ 12" long
- ✓ 36" long
- ✓ 24" long
- ✓ 48" long

Mount plates welded to 1" x 1" aluminum tube

* Custom post lengths available

* Standard and custom color options available

> 45° Angle Mount

> Flat Plant Stake

1" w x 1/8" Aluminum

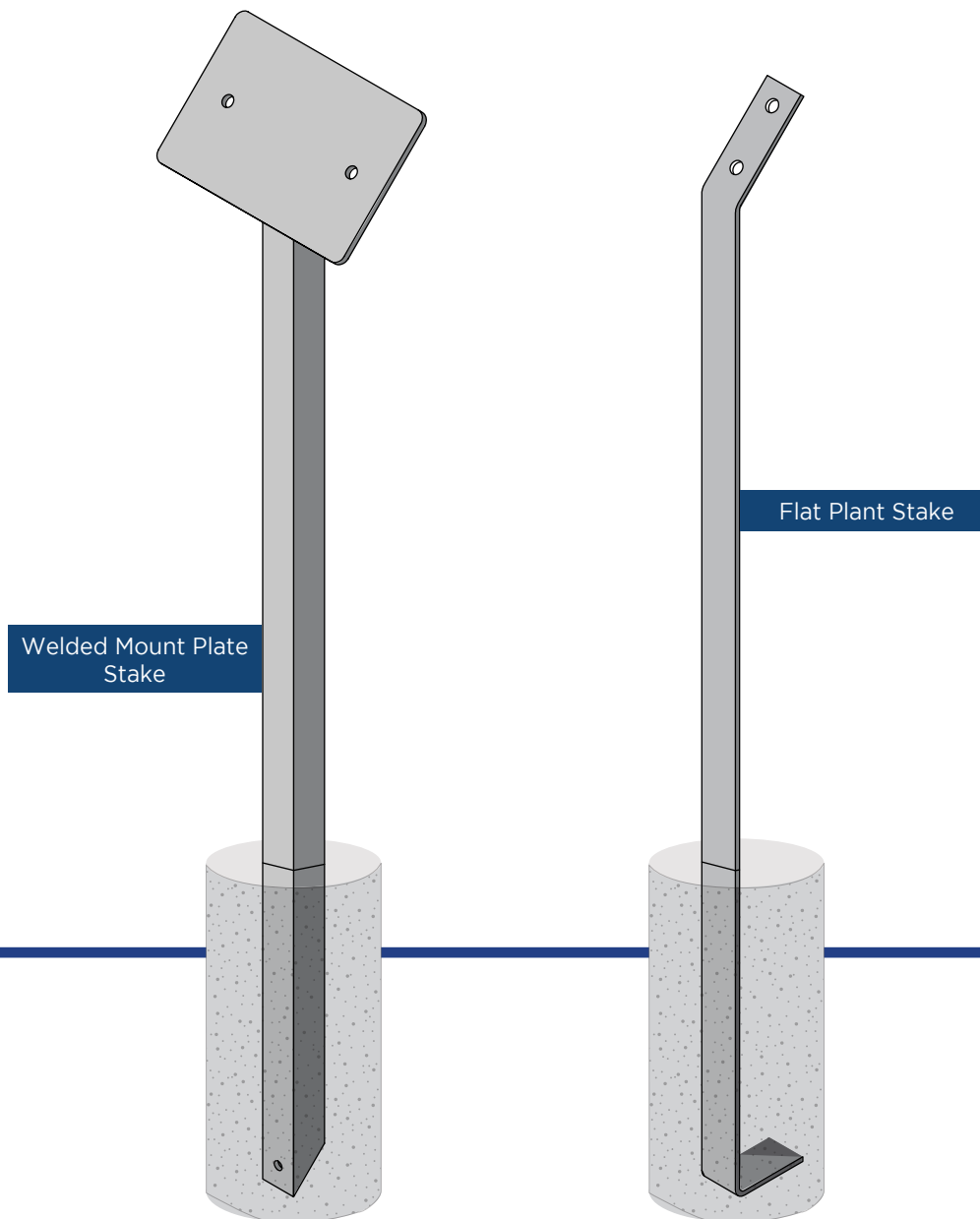

Toll Free 888.464.9663
Local 254.778.0722
Fax 254.778.0938
Email info@izoneimaging.com

Plant Stakes

Welded Mount Plate Stake

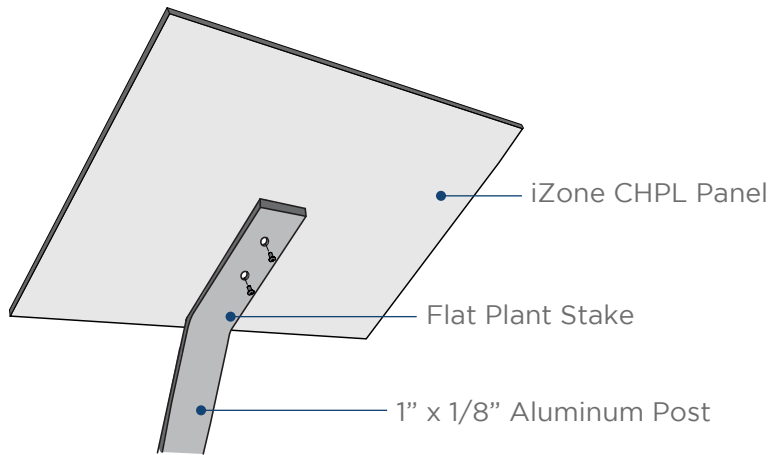

Flat Plant Stake

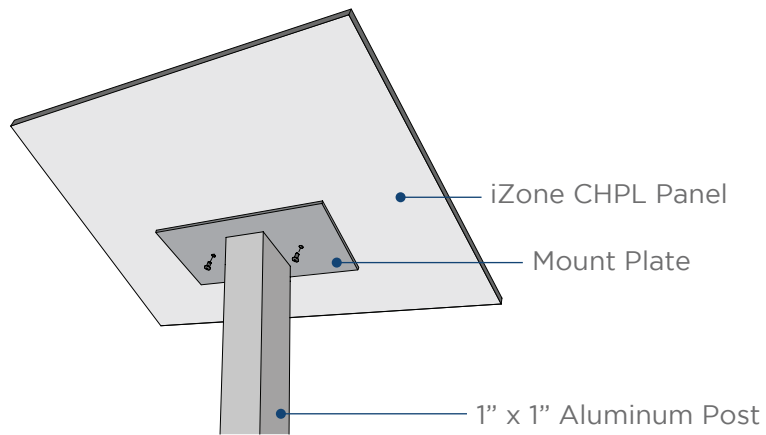

Welded Mount Plate Stake

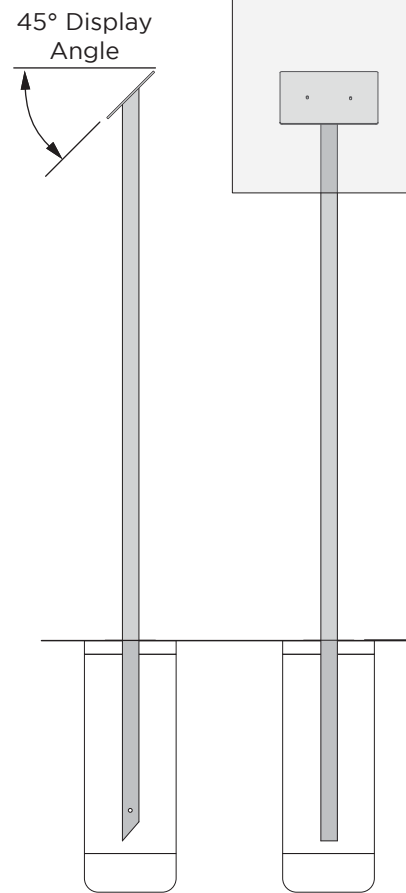

Flat Plant Stake

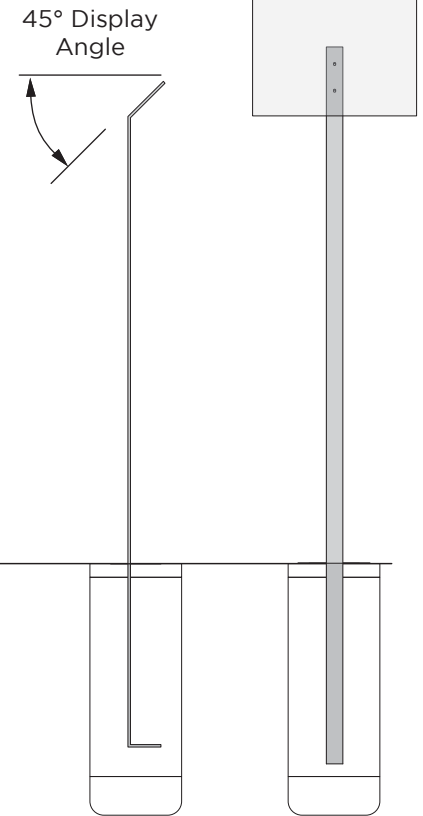

Project details pertaining to below grade installation depths, ADA requirements, wind loads, or other specifications, should be discussed with your Sales Representative at estimating.



Toll Free 888.464.9663
Local 254.778.0722
Fax 254.778.0938
Email info@izoneimaging.com

izoneimaging.com

Double Pedestal

In-Ground Mount and Surface Mount All Aluminum Construction

> Standard Posts

3" x 3" post

In-Ground Mount: 60" long

Surface Mount: 44.5" long

* Custom post lengths available

* Standard and custom color options available

> Standard Mount Plates

✓ 6" x 6"

✓ 12" x 18"

✓ 12" x 12"

✓ 16" x 20"

> 45° or 30° Mount Options

> Basic and Deluxe Surface Mount Options

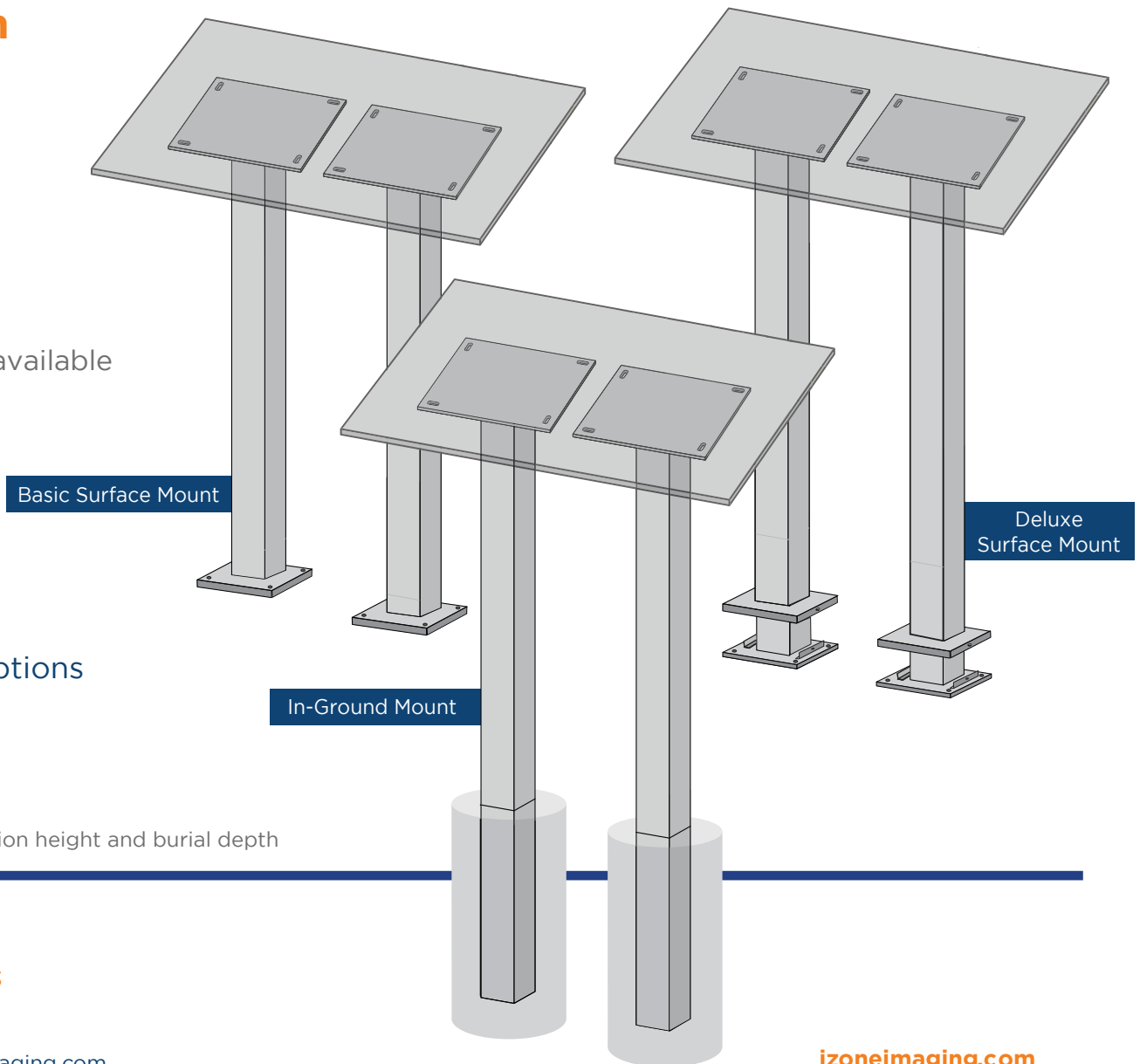

* Post length is determined by panel height, installation height and burial depth



Toll Free 888.464.9663
Local 254.778.0722
Fax 254.778.0938
Email info@izoneimaging.com

izoneimaging.com

Double Pedestal

In-Ground Mount and Surface Mount
All Aluminum Construction

BACK VIEW

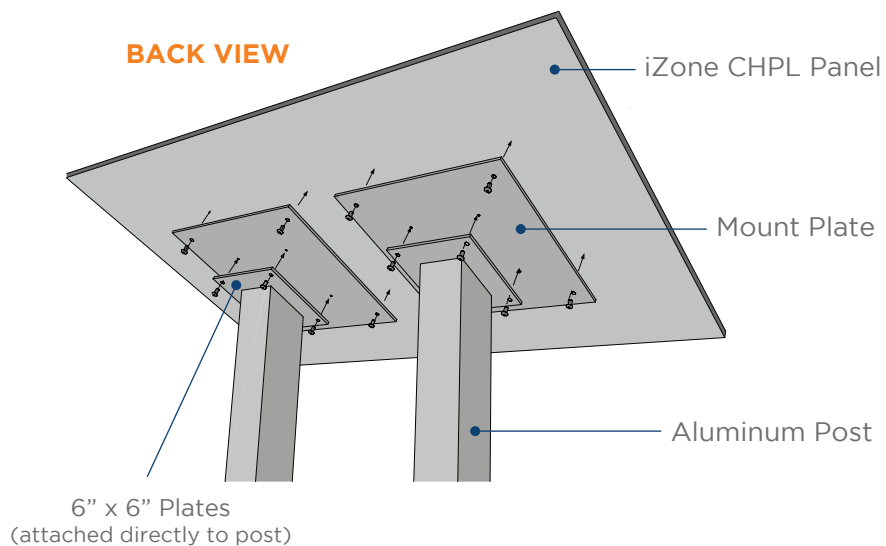

SIDE VIEW

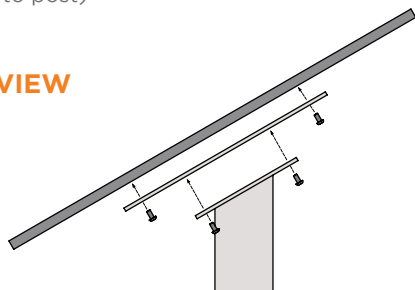

> Post Mounting Options

Surface Mount

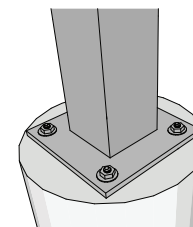

In-Ground Mount

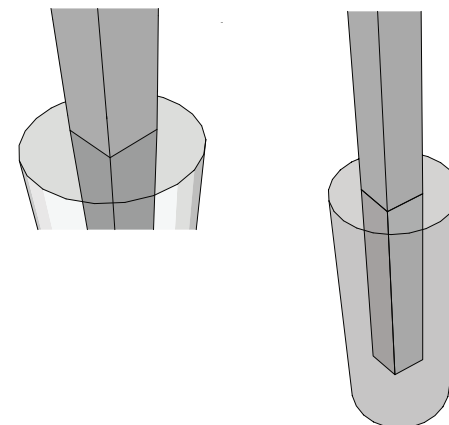

Deluxe Surface Mount

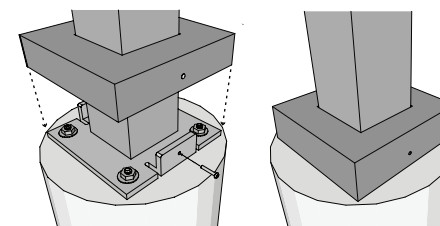

Toll Free 888.464.9663
Local 254.778.0722
Fax 254.778.0938
Email info@izoneimaging.com

izoneimaging.com

Double Pedestal

In-Ground Mount and Surface Mount
All Aluminum Construction

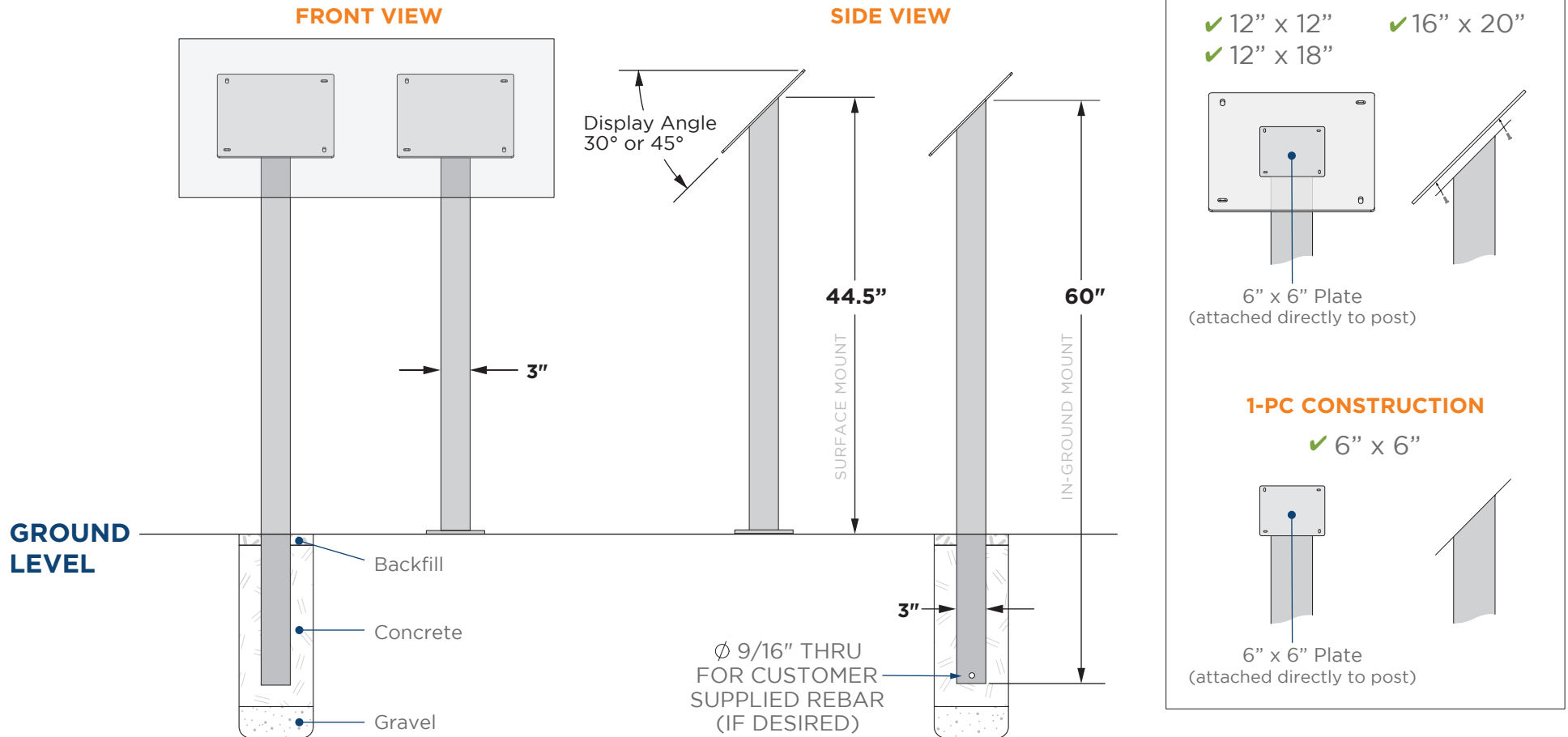

Project details pertaining to below grade installation depths, ADA requirements, wind loads, or other specifications, should be discussed with your Sales Representative at estimating.



Toll Free 888.464.9663
Local 254.778.0722
Fax 254.778.0938
Email info@izoneimaging.com

izoneimaging.com