

CITY OF AUSTIN
ART IN PUBLIC PLACES PROGRAM/CULTURAL ARTS DIVISION
USER DEPARTMENT PUBLIC ART EVALUATION FORM
FOR TECHNICAL FEASIBILITY AND MAINTENANCE

As per Section IX.A of the AIPP Guidelines, the user and managing departments responsible for housing the artwork are requested to review the artist's final design (attached) for technical feasibility and maintenance considerations. Please provide a response on this form, or on letterhead signed by your department director. Thank you!

Department: Aviation Department

Artwork Title/Description: "Spatial Weaving" is a 48'W x 12'H x 18" (approx.) wall installation that is to be located within the new West Gate Terminal Expansion at the Austin-Bergstrom International Airport (AUS). The installation is housed within a steel framework that attaches to the Terminal's structural beams. Within that framework, the installation consists of an open metal framework structure containing perforated metal patterns and dimensional designs.

Evaluation Date: 03/29/2024

Evaluator's Name: Constance Y. White
Services, Austin-Bergstrom International Airport (AUS)

Title: Art + Music Manager, Airport Guest

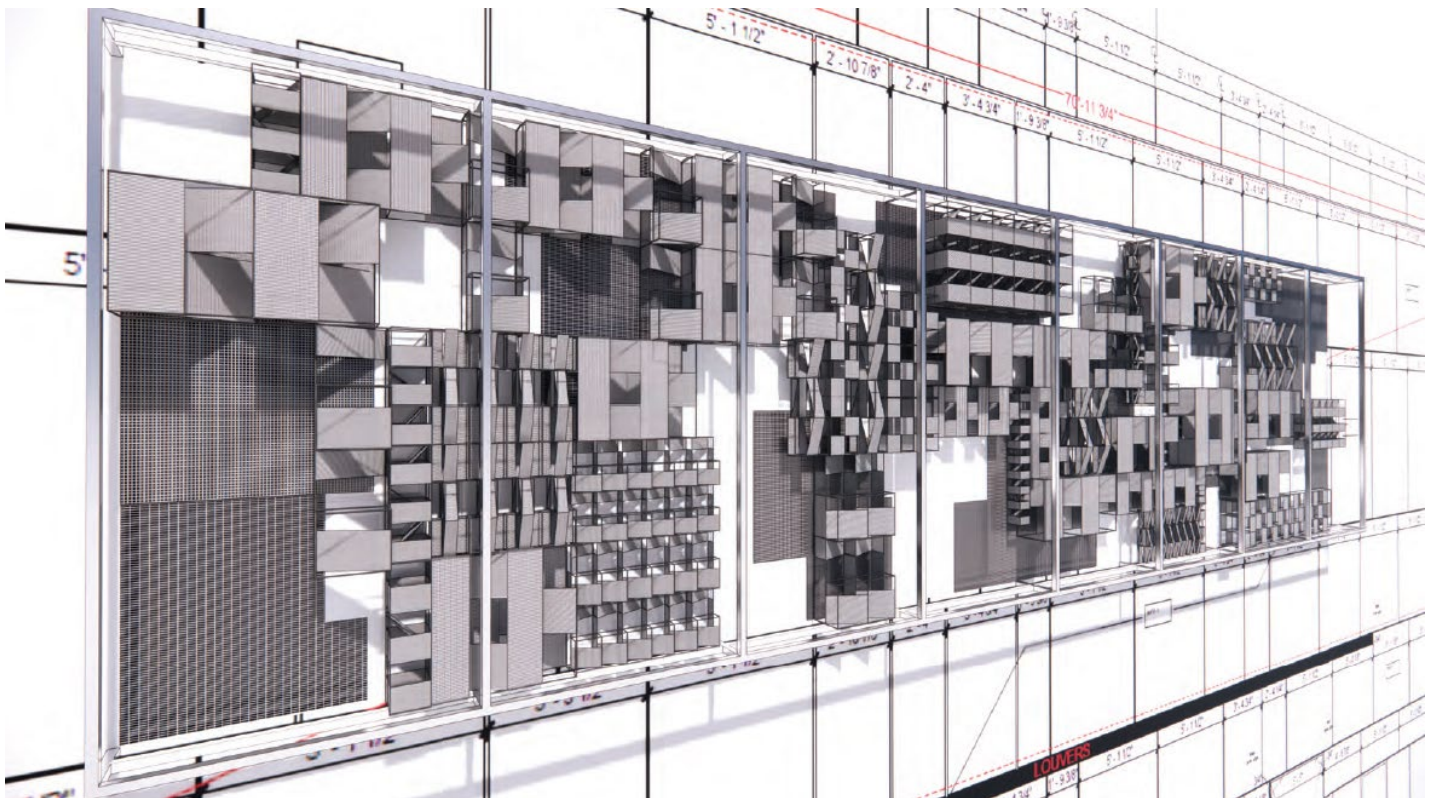

EVALUATOR'S COMMENTS

SITE: This wall-based artwork will be sited within the Airport's new West Gate Expansion. It will hang on the Mezzanine wall that overlooks the play/rest area, directly over the entrances to the bathrooms.

INSTALLATION: The artwork will be installed in two phases. First, the structural frame, which houses the main components of the artwork, will be installed summer of 2024. Through coordination with the sponsoring construction project, the West Gate Expansion general contractor Hensel Phelps will fabricate, paint, and install the frame. The frame

will be directly attached to the wall steel. The exact placement height of the frame will be determined by Page Architects / Structures TX to attach directly to the Terminal steel beam structure while avoiding HVAC and electrical systems behind the wall. The artist and her fabricator will then be constructing (8) “art bays” using stainless steel. Each art bay will contain a unique combination of perforated metal and mesh dimensional forms. In the second phase of installation, the art bays will slipped into and attached to the structural frame. The bays will be installed between February and May 2025.

SAFETY / LIABILITY: The installation height is likely to be high enough to prevent accidental breakage or vandalism. The artist and her installer will undergo any AUS-required safety trainings before installing in the West Gate Expansion construction site.

MAINTENANCE: The artwork should be dusted annually, including inside the bays and behind the artwork (in the 6” gap between the frame and the wall). The artwork should also be assessed for corrosion or loose elements during annual dusting. All carbon steel components of the work will be coated (either with a primer/top coat or Permalac) to prevent corrosion. If cleaning beyond dusting is needed, Permalac-treated metal should only be cleaned with soap and water. NO alcohol-based cleaners (according to Manufacturer spec sheets). According to the conservator’s report, both anti-corrosion coatings specified are appropriate and can be expected to have satisfactory long-term stability and adhesion. However, all anti-corrosion coatings require renewal; no coating is known that has an indefinite lifespan and will require replacement. Permalac’s lifespan in an interior setting is estimated at 8-10 years by the manufacturer. A lifespan of 10-20 years is the generally expected industry standard for a primer in an interior setting, according to the conservation report.

OTHER COMMENTS: Per AUS West Gate Expansion Project Manager Robert Mercado, 3/26 via email: “[The] project team for the West Gates Expansion Project including Hensel Phelps, Page Architects and myself have been coordinating and working with Kat Quay for several months on her design for the art piece. We are totally supportive of the piece and think it will be a great addition to the space. The details of the installation and attachment is understood and has been accommodated in the building structure and construction schedule.”

DEPARTMENTAL RECOMMENDATION

(Attach additional sheets as necessary)

 X Support artwork as proposed

 Support artwork with the following modification(s): _____

Signature:  _____ Date: 03/29/2024

User Department Director or designee