



City of Austin

Planning Department

P.O. Box 1088, Austin, TX 78767 -1088

(512) 974-3100 ♦ Fax (512) 974-3112 ♦ <https://www.austintexas.gov/department/housing-and-planning>

MEMORANDUM

TO: Claire Hempel, Chair &
Planning Commission Members

FROM: Maureen Meredith, Senior Planner, Long-Range Planning Division
Jonathan Tomko, Principal Planner, Current Planning Division
Planning Department

DATE: April 17, 2024

RE: NPA-2023-0005.02_600 Kemp Street
C14-2023-0119_600 Kemp Street
Montopolis Neighborhood Planning Area

Staff requests a postponement of the above-referenced cases from the **April 23, 2024** Planning Commission hearing to the **May 28, 2024 hearing date** to allow staff additional time to review the applications.

The postponement request was made in a timely manner and meets the Planning Commission's policy.

Attachment: Plan Amendment Map
Zoning Map

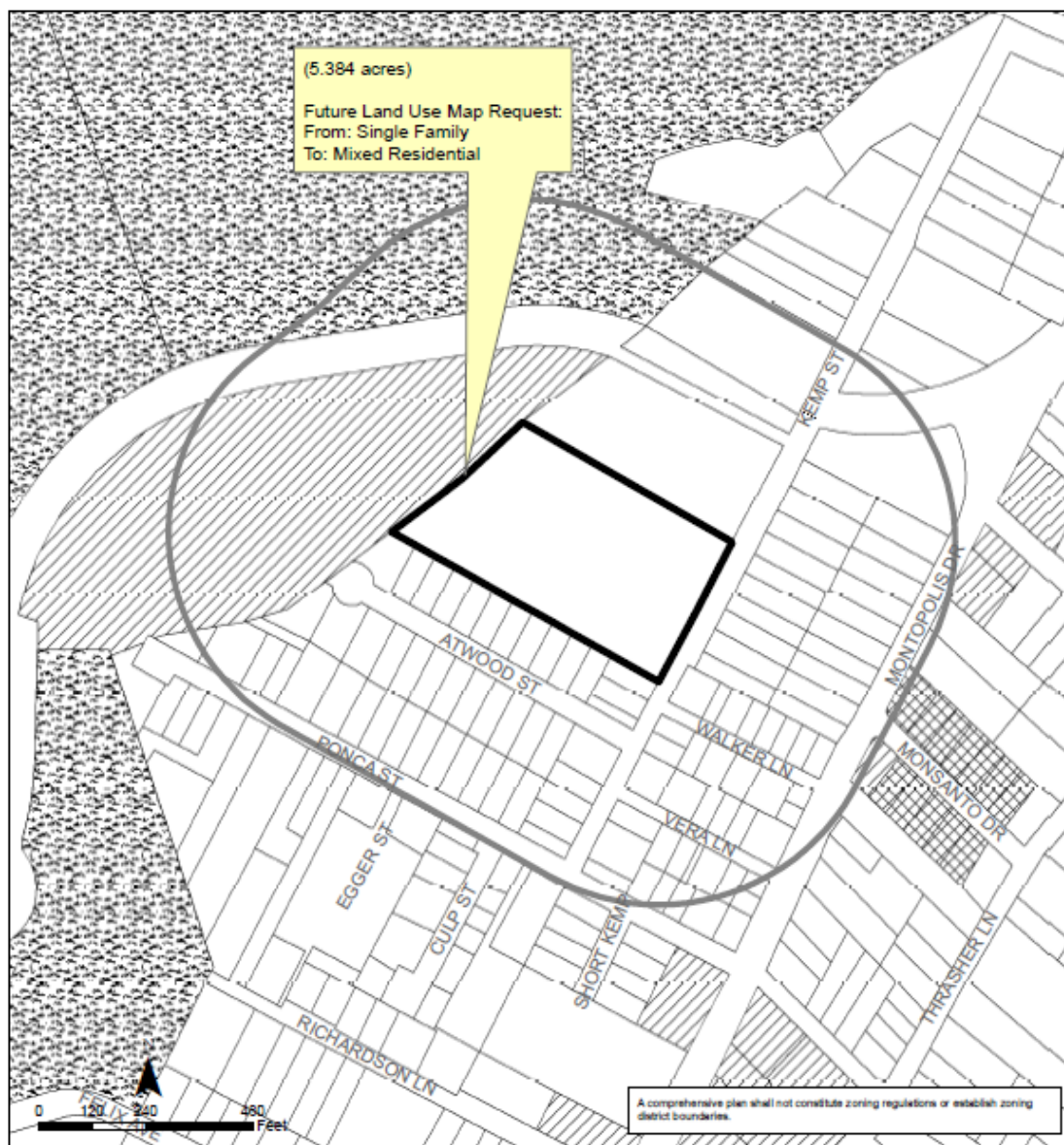

Montopolis Neighborhood Planning Area NPA-2023-0005.02

This product is for informational purposes and may not have been prepared for or be suitable for legal, engineering, or surveying purposes. It does not represent an on-the-ground survey and represents only the approximate relative location of property boundaries.

This product has been produced by the Housing and Planning Department for the sole purpose of geographic reference. No warranty is made by the City of Austin regarding specific accuracy or completeness.

Future Land Use

	Subject Tract		Multi-Family
	500 ft. notif. boundary		Recreation & Open Space
	Commercial		Single-Family



City of Austin
Housing and Planning Department
Created on 8/17/2023, by: MeeksS

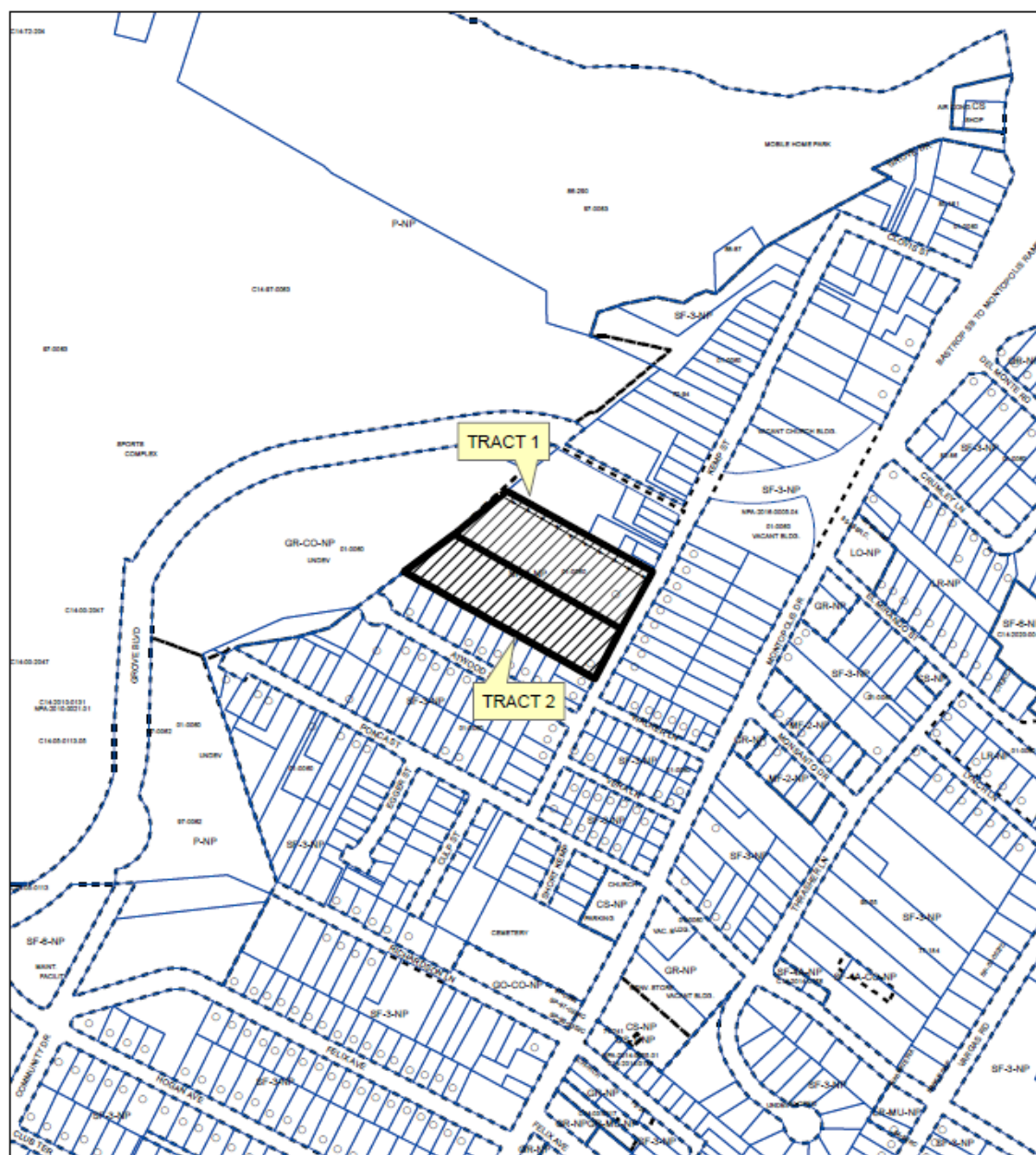

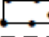
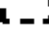
-  SUBJECT TRACT
-  PENDING CASE
-  ZONING BOUNDARY

1" = 400'

ZONING

ZONING CASE#: C14-2023-0119

This product is for informational purposes and may not have been prepared for or be suitable for legal, engineering, or surveying purposes. It does not represent an on-the-ground survey and represents only the approximate relative location of property boundaries.

This product has been produced by the Housing and Planning Department for the sole purpose of geographic reference. No warranty is made by the City of Austin regarding specific accuracy or



Created: 10/5/2023